

# Zero Edge Pro

## Installation Instructions



INSTALLERS: PLEASE LEAVE THIS MANUAL WITH THE OWNER.





APPLY S/N  
STICKER HERE

## Limited 1 year warranty on Screen Innovations products

Screen Innovations warrants its products, to the original purchaser only, to be free from defects in materials and workmanship for a period of one (1) year from the date of purchase by the original purchaser provided they are properly operated according to Screen Innovations' instructions and are not damaged due to improper handling or treatment after shipment from the factory.

This warranty does not apply to equipment showing evidence of misuse, abuse, or accidental damage, or which has been tampered with or repaired by a person other than authorized Screen Innovations personnel.

Screen Innovations' sole obligation under this warranty shall be to repair or to replace (at Screen Innovations' option) the defective part of the merchandise. Returns for service should be made to your Screen Innovations' dealer. If it is necessary for the dealer to return the screen or part to Screen Innovations, transportation expenses to and from Screen Innovations are payable by the purchaser and Screen Innovations is not responsible for damage in shipment. To protect yourself against damage or loss in transit, insure the product and prepay all transportation expenses.

This warranty is in lieu of all other warranties, express or implied, including warranties as to fitness for use and merchant ability. Any implied warranties of fitness for use, or merchantability, that may be mandated by statute or rule of law are limited to the one (1) year warranty period. This warranty gives you specific legal rights, and you may also have other rights, which vary from state-to-state. No liability is assumed for expenses or damages resulting from interruption in operation of equipment, or for incidental, direct, or consequential damages of any nature.

In the event that there is a defect in materials or workmanship of a Screen Innovations product, you may contact our Sales Partners at 9715-B Burnet Road Suite 400, Austin, TX 78758, (512) 832-6939.

Important: this warranty shall not be valid and screen innovations shall not be bound by this warranty if the product is not operated in accordance with screen innovations' written instructions.

Keep your sales receipt to prove the date of purchase and your original ownership.

# TABLE OF CONTENTS

SUGGESTED PROJECTOR PLACEMENT.....1

DETERMINE FRAME TYPE.....2

STANDARD FRAME ASSEMBLY .....3

STANDARD FRAME ASSEMBLY .....4

SPLIT FRAME ASSEMBLY ..... 5 – 8

LED LIGHTS ATTACHMENT..... 9 – 10

DETERMINE YOUR MATERIAL .....11

BLACK DIAMOND & SHORT THROW MATERIAL ONLY .....12

NON-AT MATERIAL ATTACHMENT .....13

MAESTRO – WHITE – AT MATERIAL – ATTACHMENT ..... 14 – 15

MAESTRO MATERIAL FLATTENING .....16

MATERIAL ATTACHMENT SEQUENCE .....17

PVC – AT MATERIAL – SLATE, UNITY, PURE AT ATTACHMENTS.....17

BLACK BACKER ATTACHMENT – ANY AT MATERIAL..... 18 – 19

SMALL TRIM ATTACHMENT..... 20 – 21

MEDIUM TRIM ATTACHMENT ..... 22 – 23

LOGO ATTACHMENT .....24

WALL MOUNTING .....25

FLOWN MOUNTING.....26

IR LIGHTING HEX CODES.....27

IP CONTROLLED LIGHTING SETUP.....28



Please visit [support.screeninnovations.com](https://support.screeninnovations.com) to find all the updated documents, drivers and tutorial videos.



Use this QR code to see the video tutorials for Black Diamond or Short Throw snap attachment method



Use this QR code to see the video tutorials for Slate material.

**For more technical support questions - Call: 512.832.6939 or email: [support@screeninnovations.com](mailto:support@screeninnovations.com)**  
Hours of Support: 7:30am – 5pm CST | [screeninnovations.com](https://screeninnovations.com)

# SUGGESTED PROJECTOR PLACEMENT



Please visit our Screen Material Wizard ([screeninnovations.com/tools/screen-material-wizard/](https://screeninnovations.com/tools/screen-material-wizard/)) for the minimum throw distance requirements based on screen material.

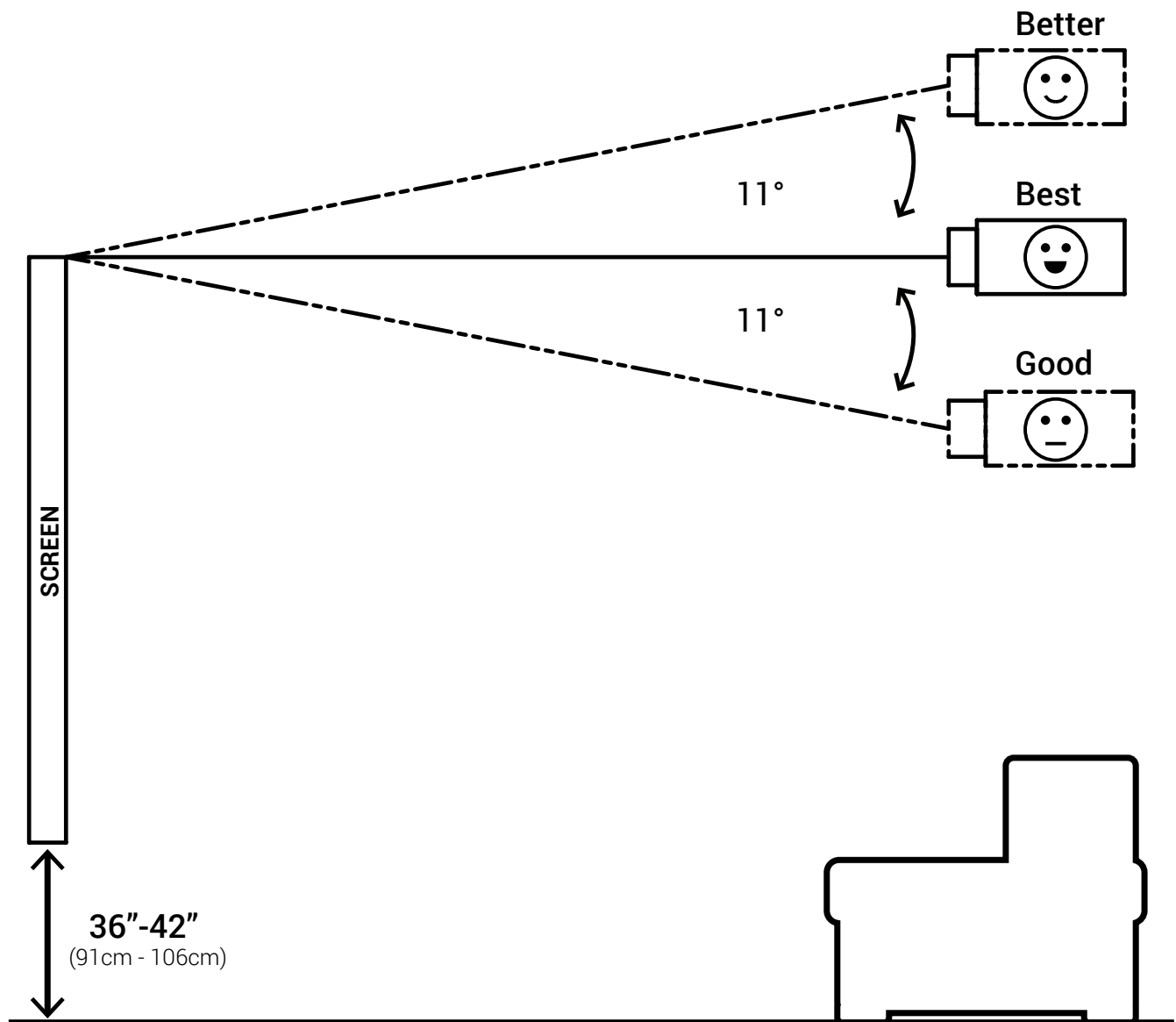

# DETERMINE FRAME TYPE

NOTE: The vertical support bar is for certain models and sizes only.

## Standard Frame

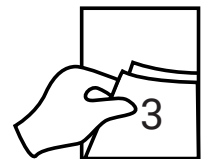
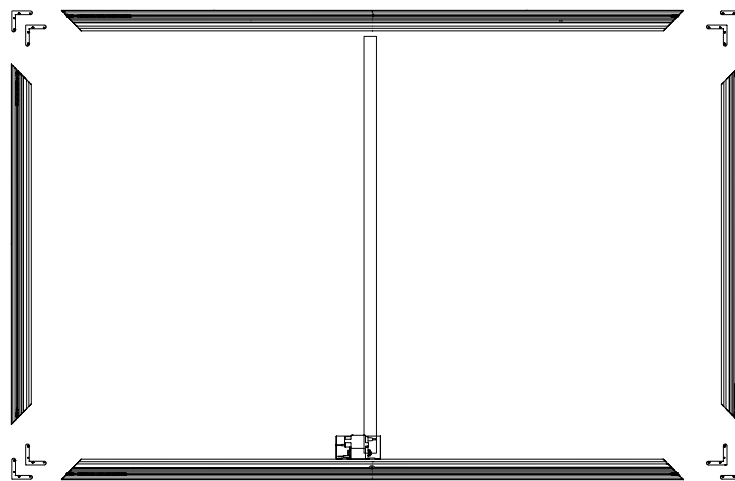

## Split Frame

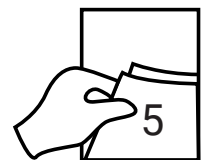
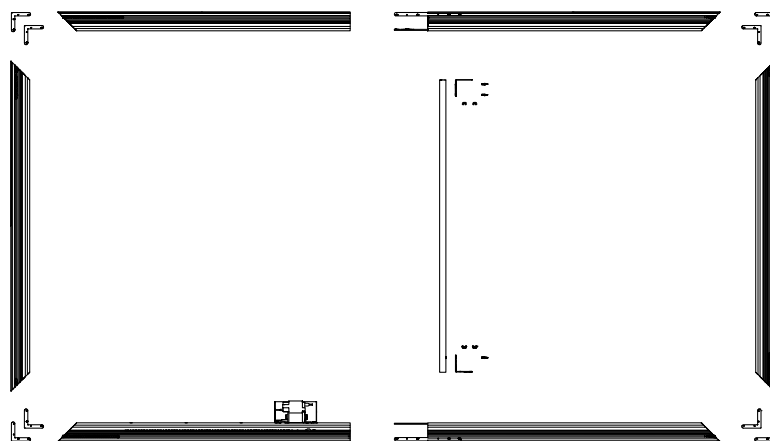

# STANDARD FRAME ASSEMBLY

- 1 Insert the thin corner brackets into the outside channels and the thick corner brackets into the inside channels of the vertical frames. Then slide into the channels in the horizontal frames.



**WARNING:** If using AT or Maestro material, check to make sure the female channel nuts are installed in the inner channel **BEFORE** proceeding.



**WARNING:** If using the Decora cable fly kit, the mounting pieces have to be pushed onto the frame rails **BEFORE** installing the corner brackets.

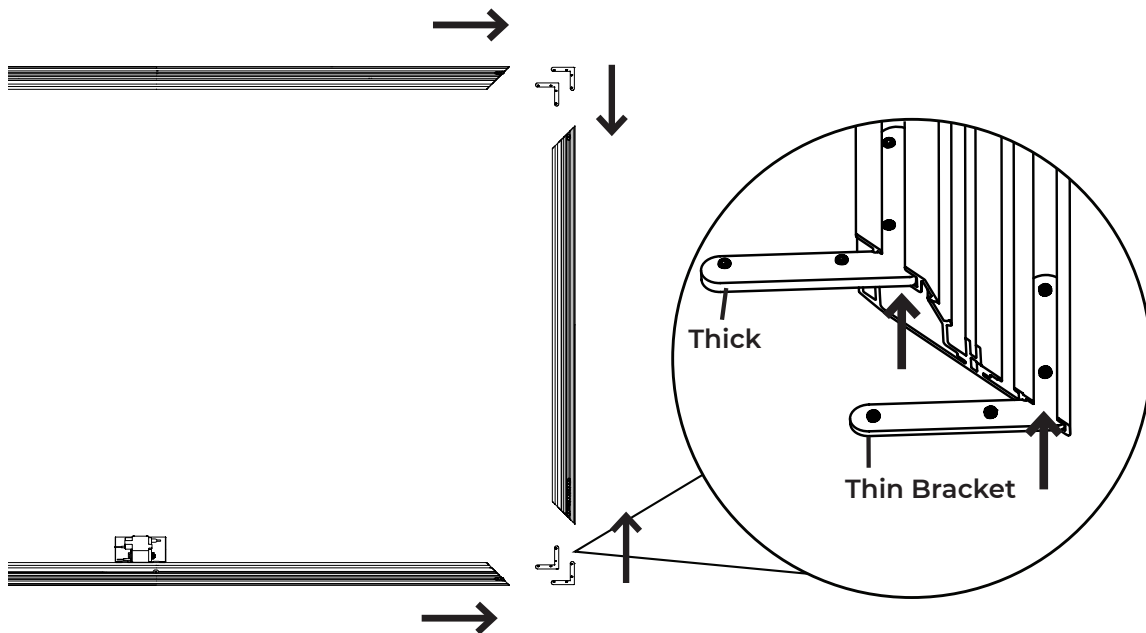

- 2 Align the edges to ensure they are at a right angle. Finger-tighten two of the set screws to lock in the corners.

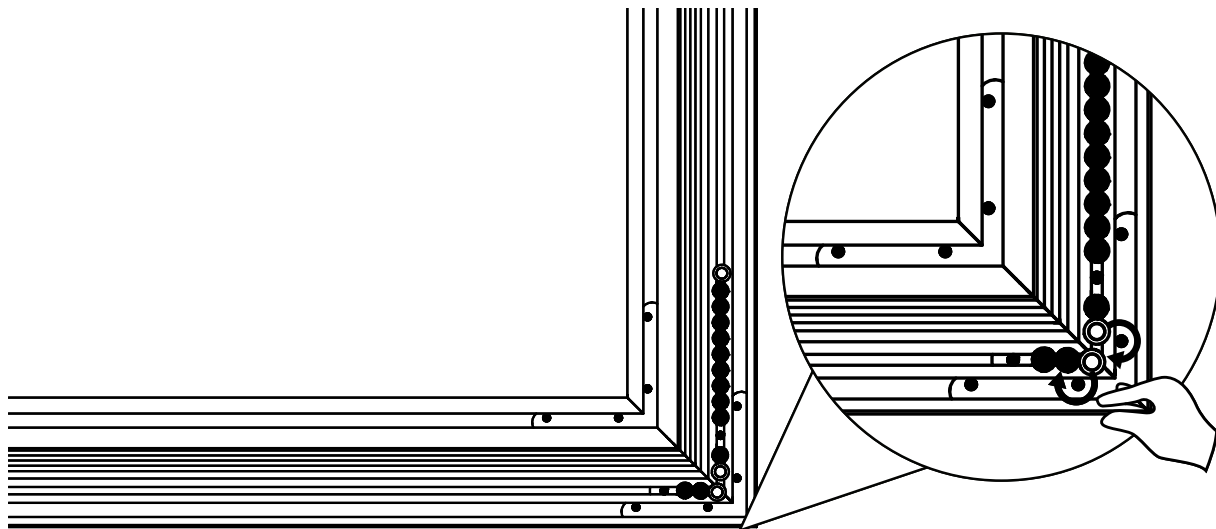

# STANDARD FRAME ASSEMBLY

3

It is a critical step to square the frame. Refer to the illustration below.

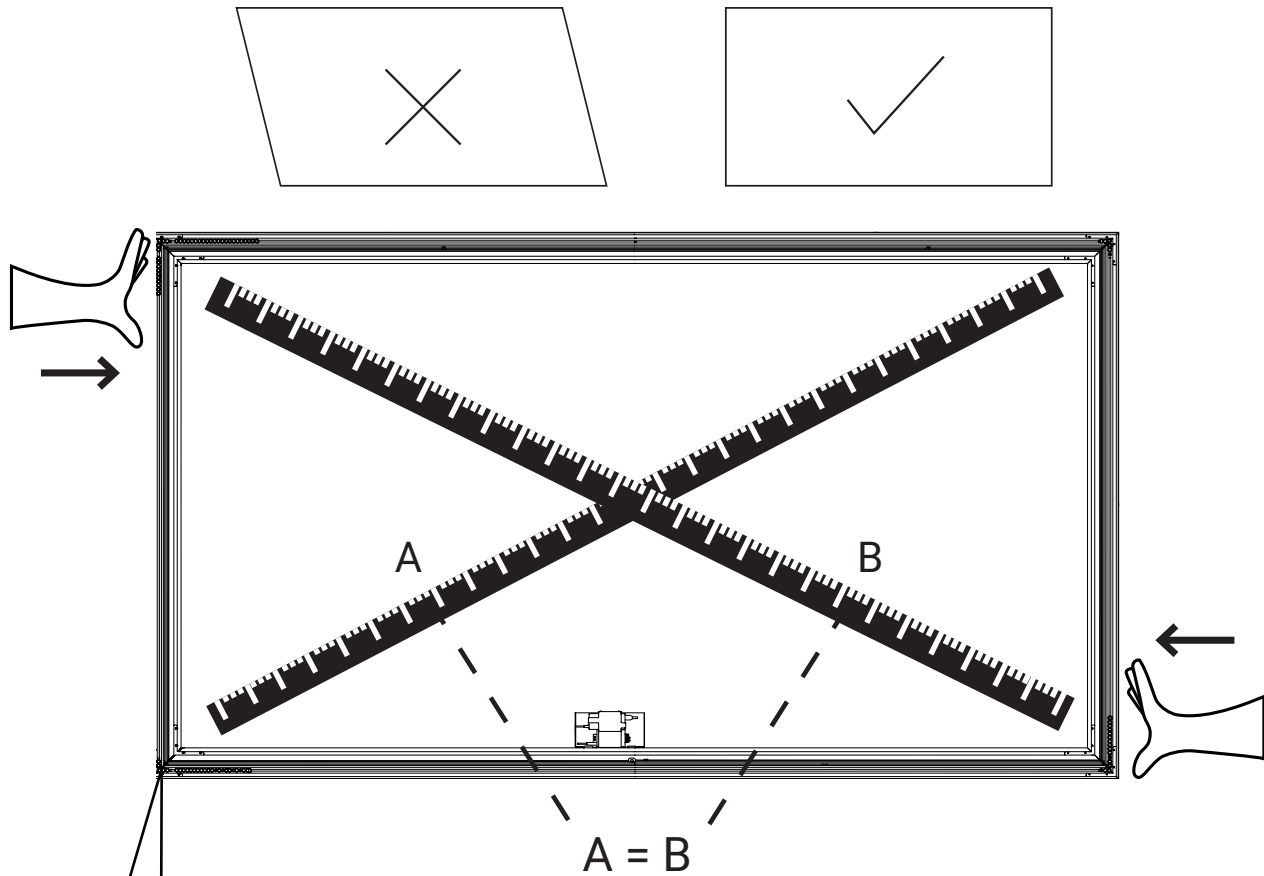

4

Measure the diagonals to check if frame is square. If one diagonal is longer, push the corners at the diagonal. Tighten all set screws once the diagonals are equal or within 1/8".

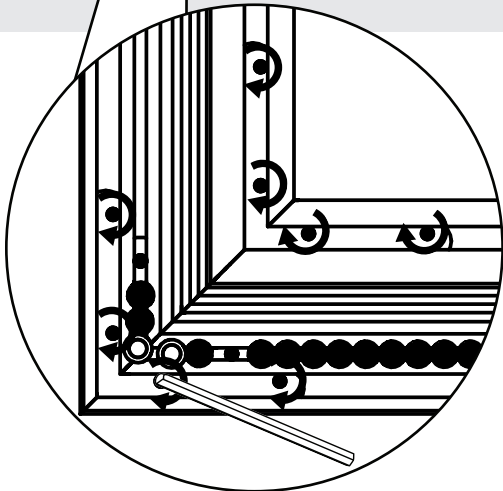

Note: If LED lights were ordered, refer to page 9 to for instructions on attaching LED lights to the screen frame.

# SPLIT FRAME ASSEMBLY

- 1 Insert the thin corner brackets into the outside channels and the thick corner brackets into the inside channels of the vertical frames. Slide brackets into the channels in the horizontal frames.



**WARNING:** If using AT or Maestro material, ensure the channel nuts are installed in the inner channel **BEFORE** proceeding.

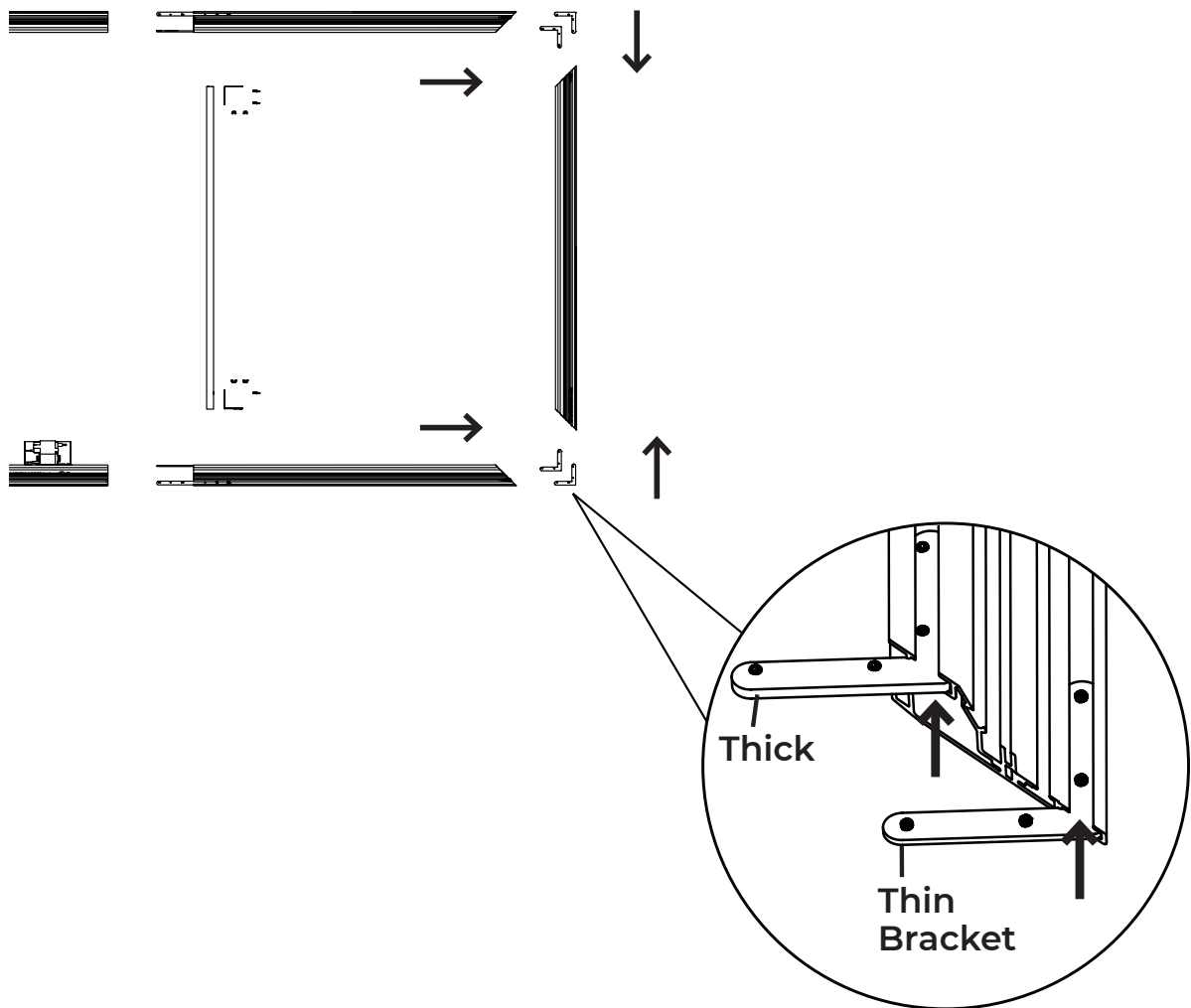



## SPLIT FRAME ASSEMBLY

2

Slide the horizontal frame pieces together and secure with the splice bars. Attach the vertical support to the frame as shown. Fully tighten splice bars, leaving the vertical support bar loose but snug.

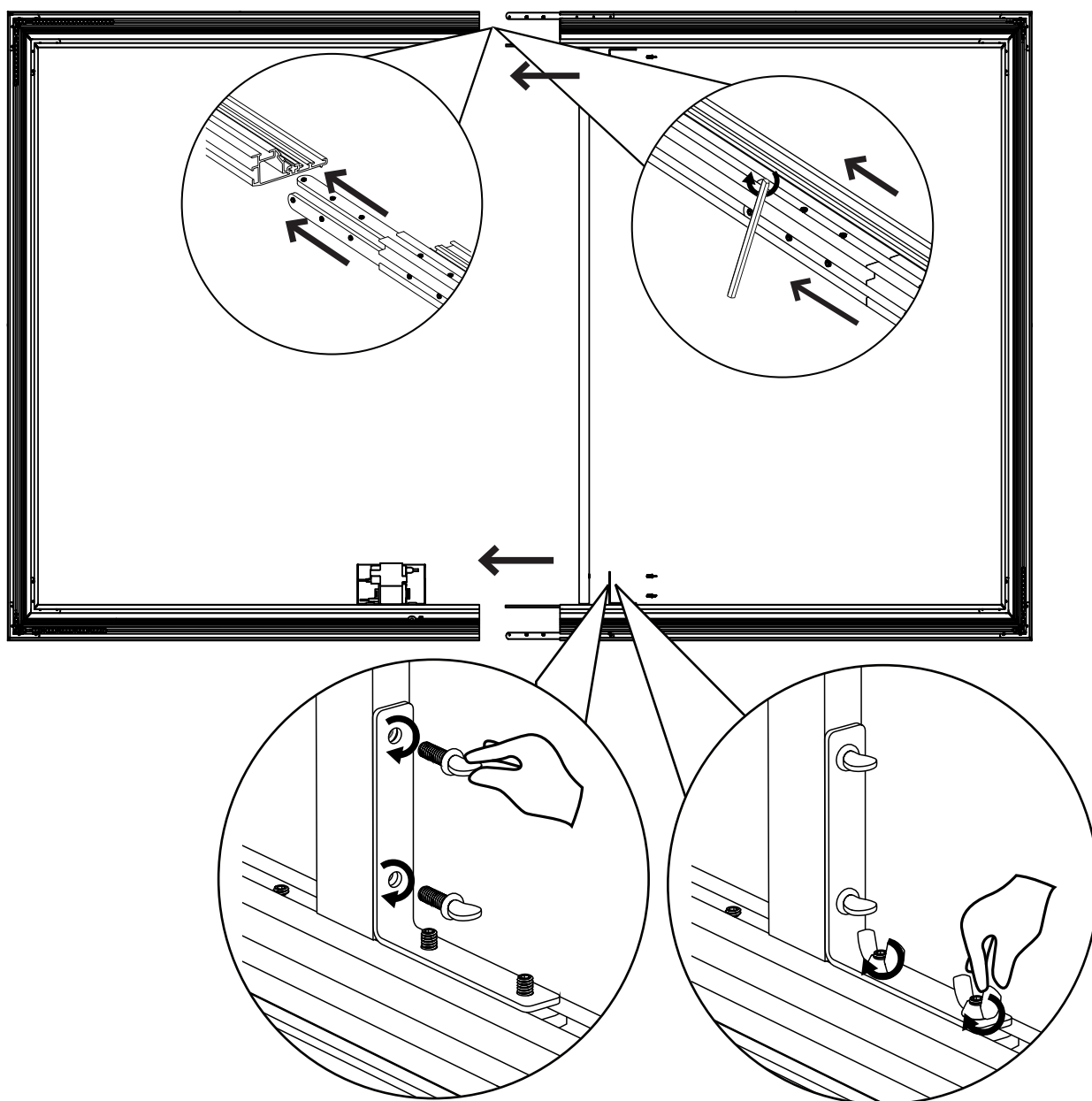

## SPLIT FRAME ASSEMBLY

- 3** Align the edges to ensure they are at a right angle. Finger-tighten two of the set screws to lock in the corners.

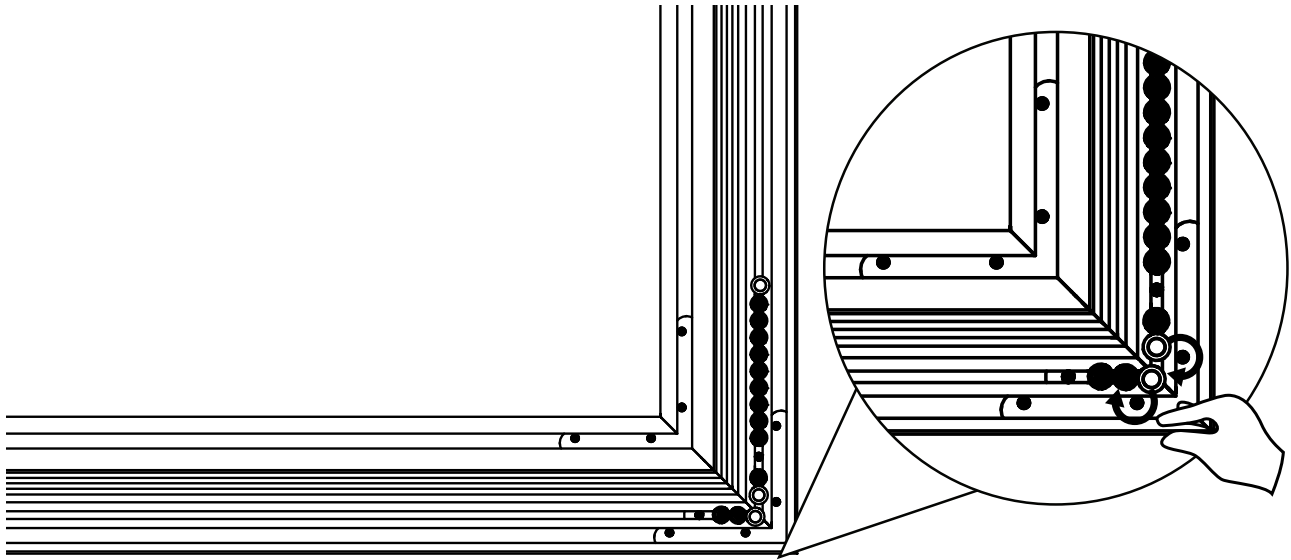

## SPLIT FRAME ASSEMBLY

4

It is a critical step to square the frame. Refer to the illustration below.

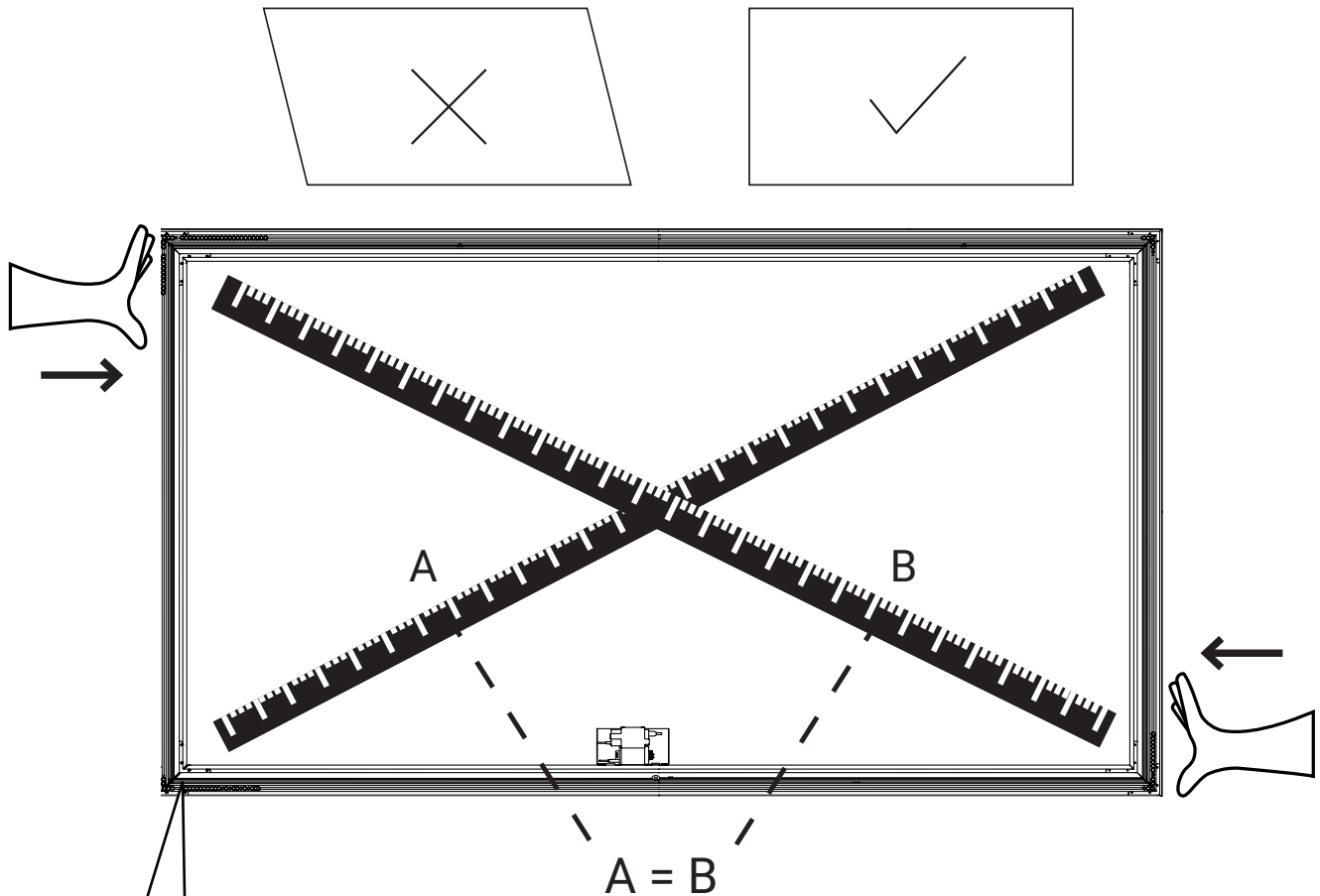

5

Measure the diagonals to check if the frame is square. If one diagonal is longer, push on the corners at that diagonal. Tighten all set screws once the diagonals are equal or within 1/8".

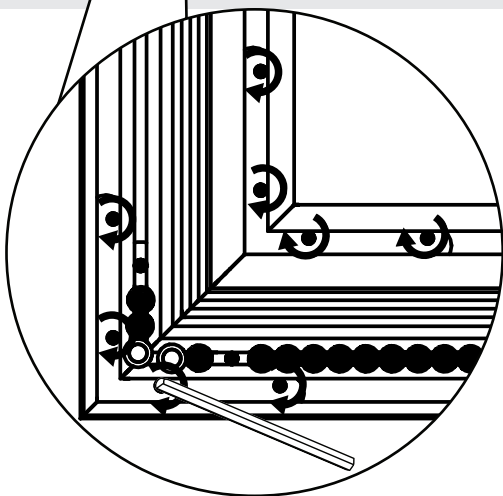

Note: If LED lights were ordered, refer to the following page for instructions on attaching LED lights to the screen frame.

# LED LIGHTS ATTACHMENT



If IP-controlled LED lights are ordered, Phillips Hue Hub must be purchased and set up separately. Scan the QR code to see the instructions for setup.



Note: The controller may already be attached from the factory on some models. If so, skip this step.

- 1 Connect the lighting harness to the nuts in the frame piece with the screws included.

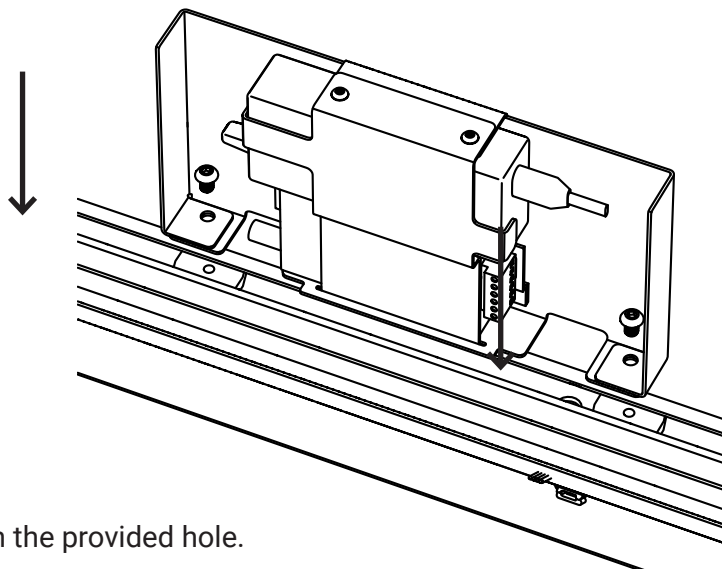

- 2 Feed the wires through the provided hole.

- 3 Plug the lights into the controller plugs.

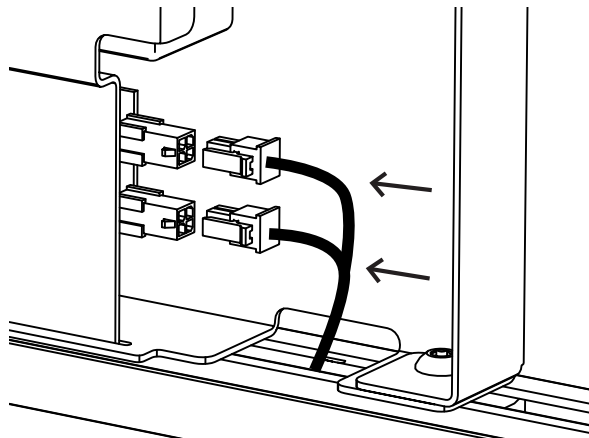

# LED LIGHTS ATTACHMENT

4

Note: Use caution in the next steps; do not kink or fold the light strip, which will cause damage in the circuit. Use the foam strips provided to loosely wrap LEDs around the corners.

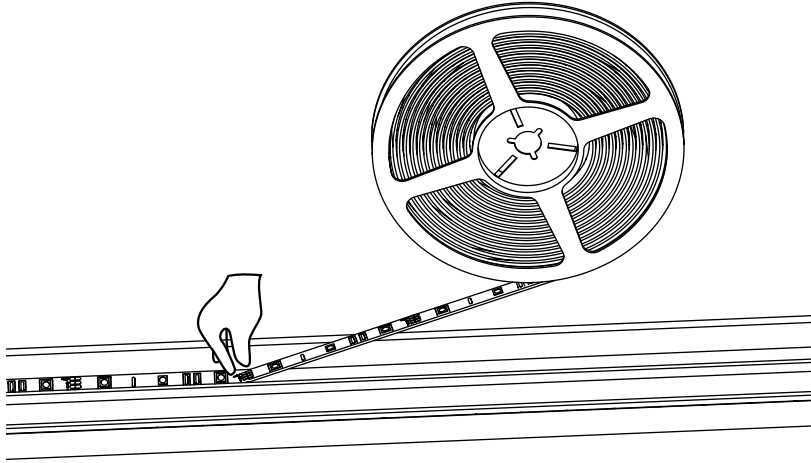

5

Press the lights into the channel on the frame. LED foam must be used when rounding the corners to protect the circuit. Failure to do so will damage the LED strips. The strip should gently round the corner.

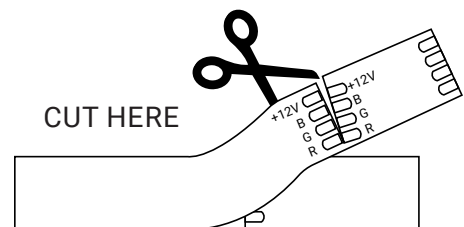
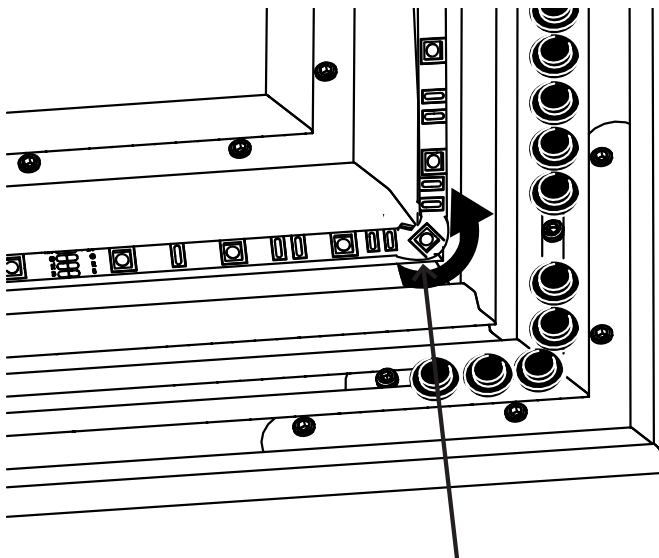

Cut the light strips at the copper pad where indicated to the correct length so they just overlap at the middle of the top frame piece. DO NOT cut the light strips at any other location.



Scan this QR code to see the video for LED kit troubleshooting.

## DETERMINE YOUR MATERIAL

<b>Black Diamond or Short Throw Material</b>	<b>Refer to page 12</b>
<b>Non – AT Material (Slate, Pure, Unity)</b>	<b>Refer to page 13</b>
<b>Maestro – White AT Material</b>	<b>Refer to page 14</b>
<b>Material Attachment Sequence – All Materials</b>	<b>Refer to page 16</b>
<b>PVC – AT Material (Slate AT, Pure AT, Unity AT)</b>	<b>Refer to page 16</b>
<b>Black Backer – Any AT Material</b>	<b>Refer to page 17</b>

# BLACK DIAMOND & SHORT THROW MATERIAL ONLY



The corner pieces are there to keep the material square with the frame during the attachment sequence (refer to attachment sequence image on page 16).

1

Black Diamond and short throw material are highly sensitive. Take particular care to not bend or crease the material as it is unrolled.

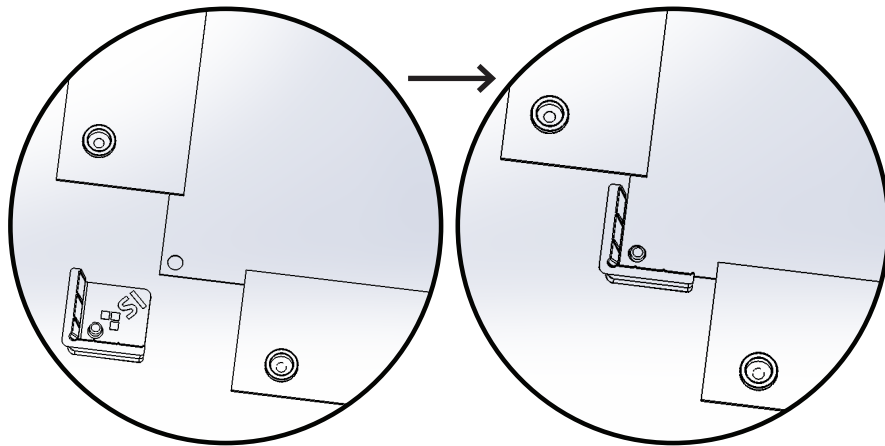

2

Then check to make sure the screen material is flat and adjust the snap positions if necessary to flatten the screen material. **Once all snaps are attached flip screen over and make sure that the screen material is flat and tight everywhere.**

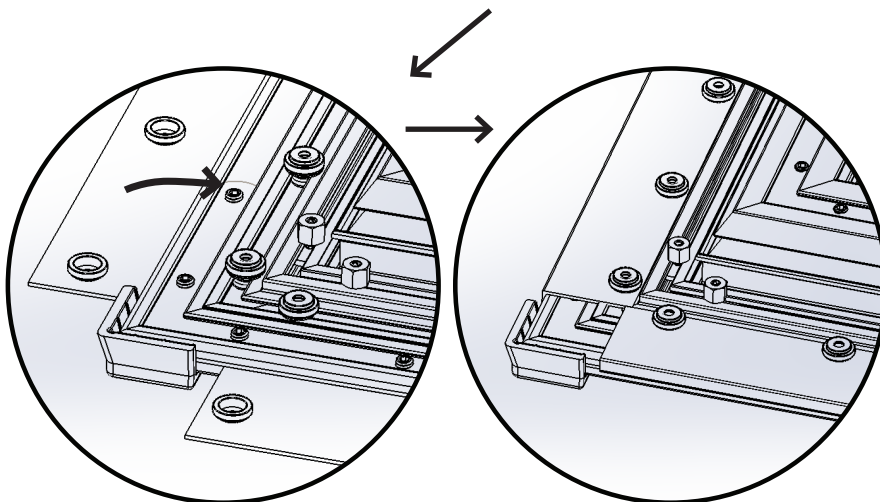

Scan this QR code for the video for this step:

*Minute mark 2:49*

# NON-AT MATERIAL ATTACHMENT

(Slate, Pure, Unity)

**Note:** Wear gloves when handling material. Carefully unroll the screen material onto a clean floor. Take care to not bend or crease the screen material.

- 1 Carefully lay the frame onto the screen material. Center the frame over the screen material.

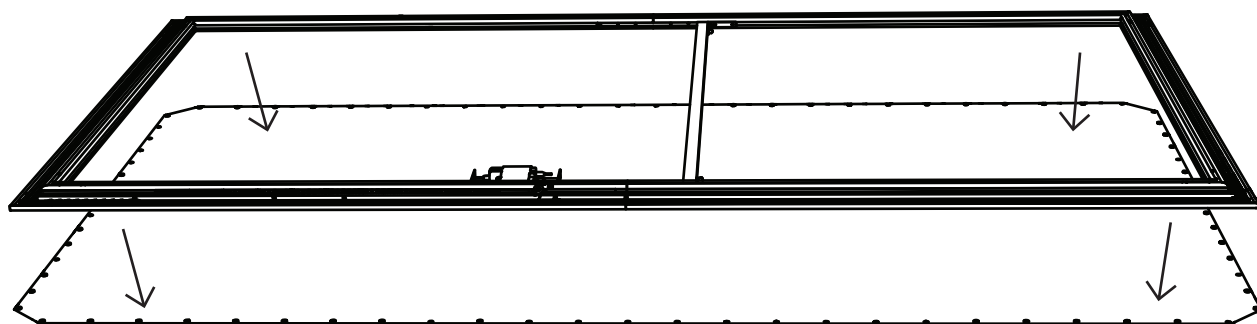

- 2 Remove and discard the black retaining bumpers; spread out the posts so they align with the snaps on the screen material.

**Note:** Refer to attachment sequence image on page 16.

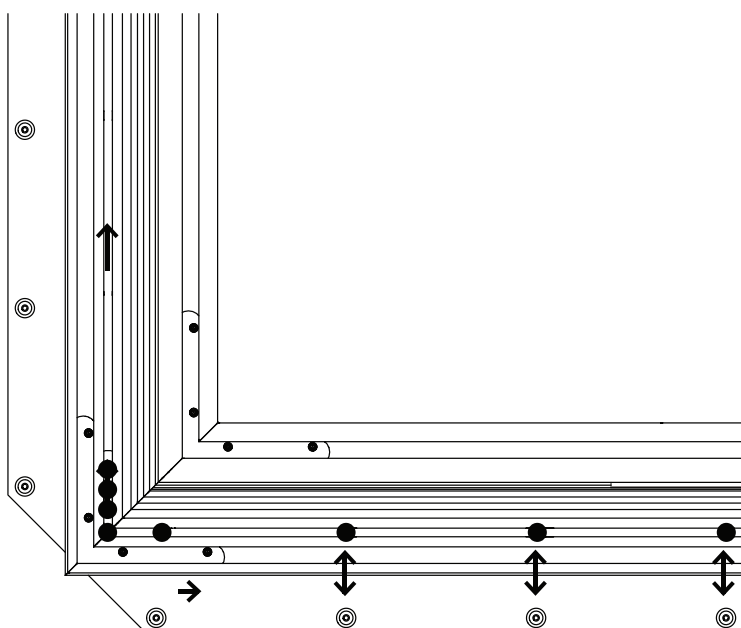



# MAESTRO (WHITE) – AT MATERIAL – ATTACHMENT

Note: Wear gloves when handling the material. Carefully unroll the screen material onto a clean floor. Take care to not bend or crease the screen material.

- 1 Insert the rods into the pocket in the screen material. Make sure the screen material is lying flat; if the screen material is bunched up at the rods, work from the middle out, spreading the screen material until it is flat.

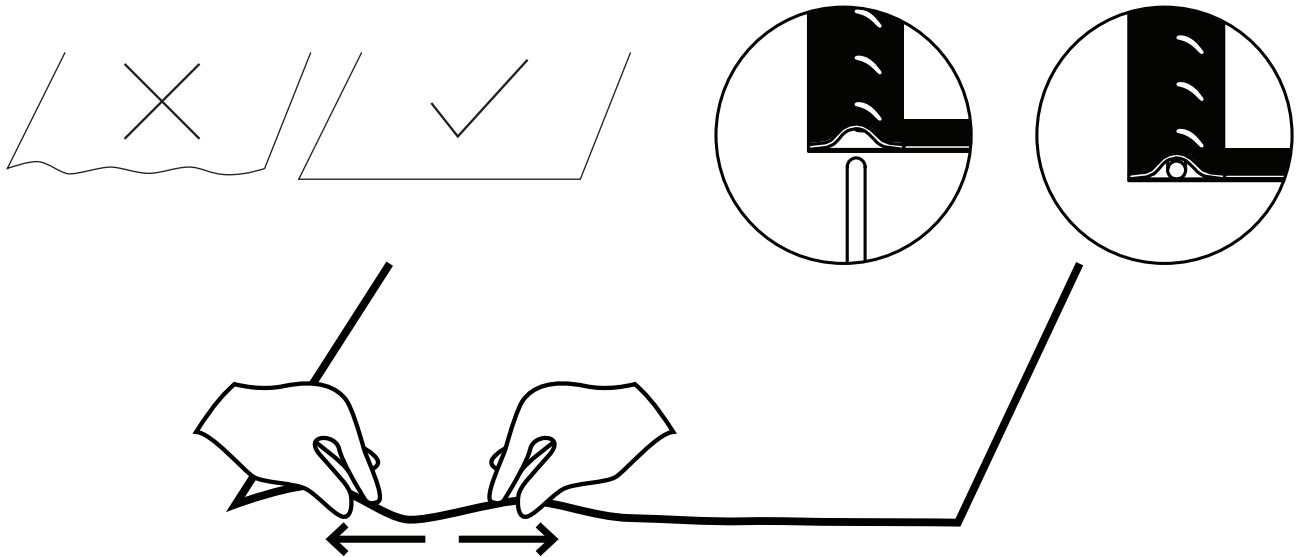

- 2 Carefully lay the frame onto the screen material. Center the frame around the screen material.

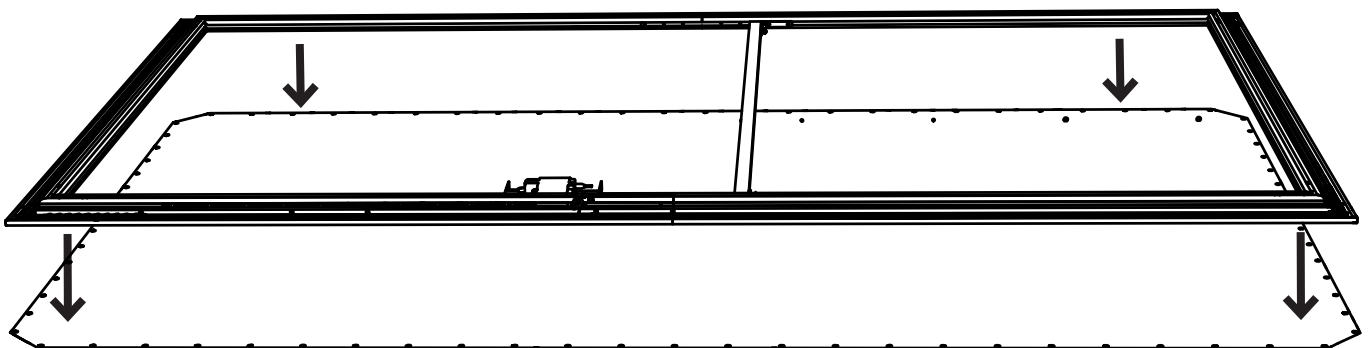

## MAESTRO (WHITE) – AT MATERIAL – ATTACHMENT

- 3** Remove and discard the black retaining bumpers, then spread out the posts so they align with the holes in the screen material.

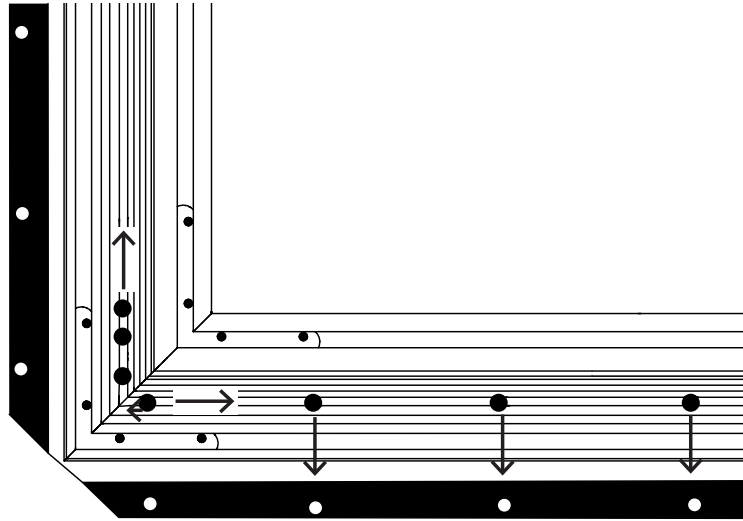

**Note:** This attachment method is for Maestro material only. Skip to next step for all other AT materials.

- 4** Make sure the screen material is centered around the frame before proceeding. Refer to the attachment sequence image on page 16.  
Pull one end of the bungee through the hole in the material and place around the post while holding the other end. Pull the other end over the post. Repeat for all four corners.

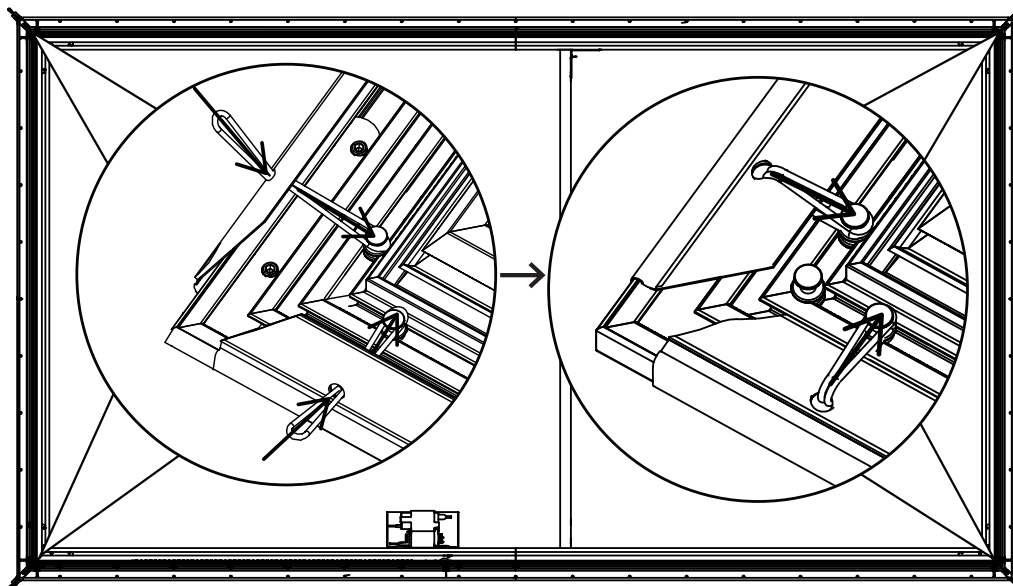

# MAESTRO MATERIAL FLATTENING

Wrinkles in Maestro Screen material may occur during shipping but are easy to resolve.

To flatten the Maestro material, follow this procedure:

**NOTE: This attachment method is for Maestro material only. Skip to next step for all other AT materials.**

- 1 Detach the bungees from the vertical/horizontal posts beside the wrinkles.
- 2 Start from the middle post of the vertical/horizontal frame and pull outward, gripping the material tightly along the rod until all wrinkles are gone.
- 3 Correct all sides from the middle working out to the corners.
- 4 Reattach bungees to secure the material once it is flattened.

# MATERIAL ATTACHMENT SEQUENCE – ALL MATERIALS

Attach the snap attachments at the middle and then work around the ends on all four sides of the screen material.

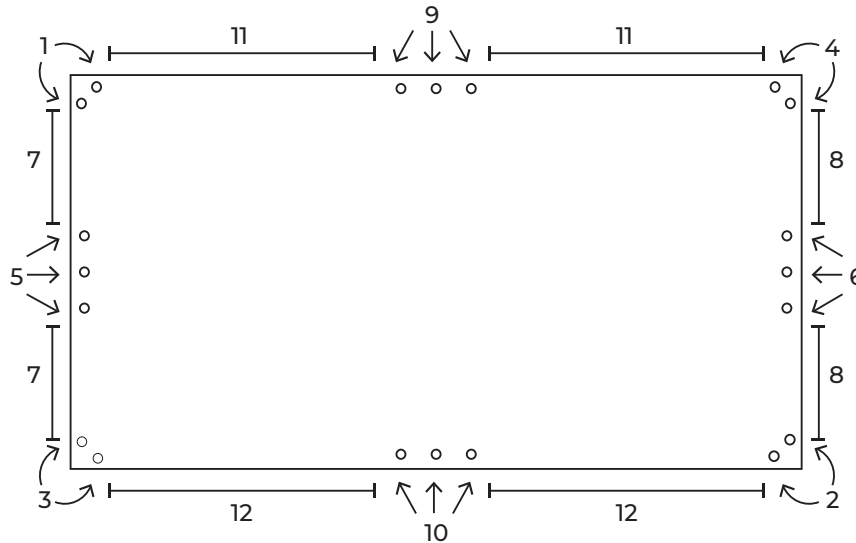

## PVC AT MATERIAL ATTACHMENT

(Slate AT, Pure AT, Unity AT)

Ensure the screen material is flat and adjust the snap positions if necessary to flatten the screen material. **Once all snaps are attached (following the sequence above), flip screen over and make sure that the screen material is flat and taut everywhere.**

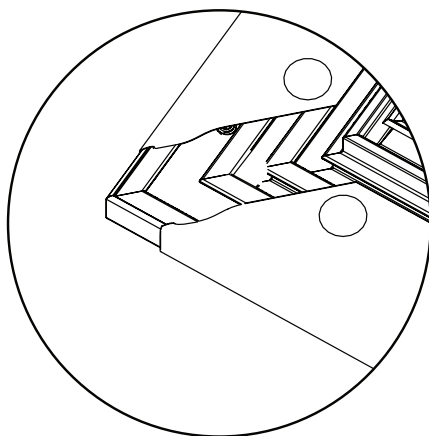

Scan the QR code to the PVC snap attachment video.

# BLACK BACKER ATTACHMENT – ANY AT MATERIAL

Acoustically Transparent (AT) materials come with a black backer that must be installed to eliminate light scatter.

Gently turn over the screen onto a soft, clean surface, ensuring that the screen material is flat and taut everywhere.

- 1 Install the retrofit channel nut inside the channels.

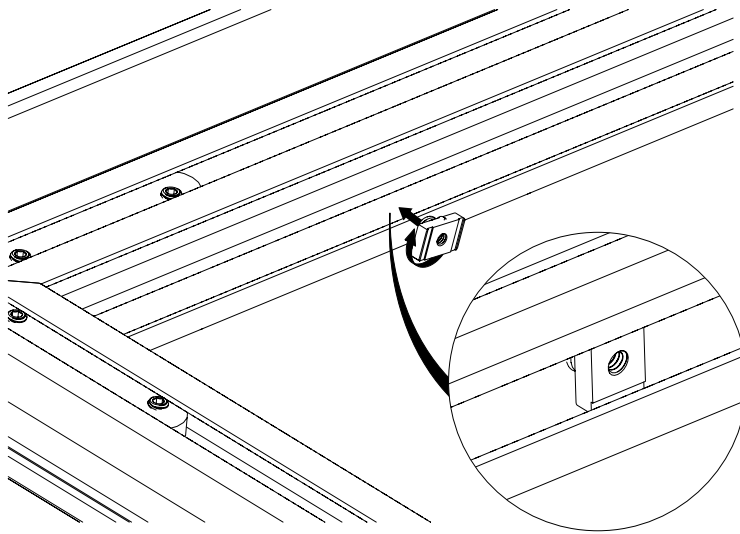

- 2 Attach the black backer to the inside of the frame through the grommets. Secure with thumb screws.

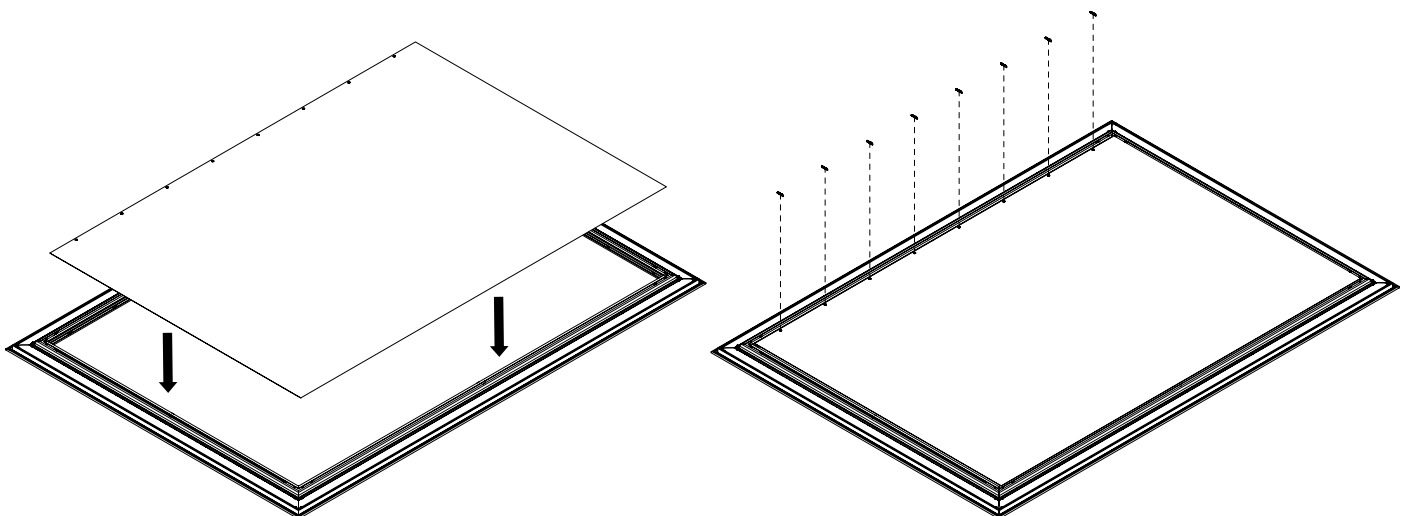

## BLACK BACKER ATTACHMENT – ANY AT MATERIAL

3

Secure black backer material with provided thumb screws.

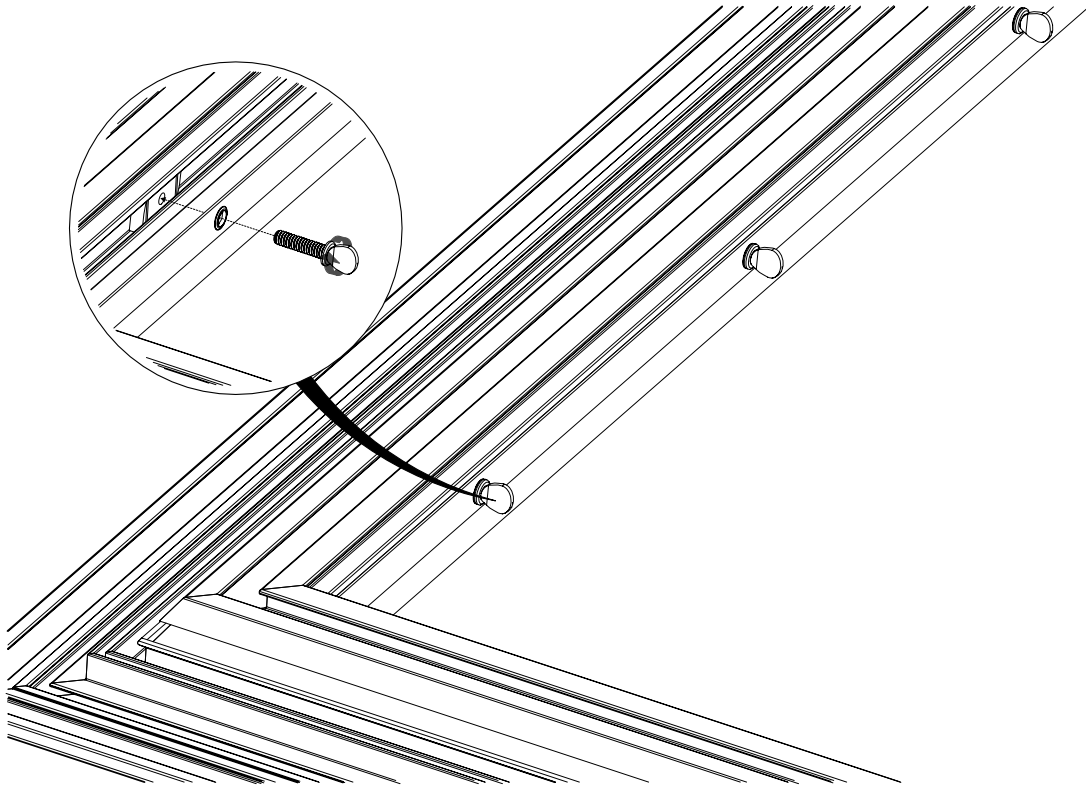

## SMALL TRIM ATTACHMENT

- 1 Attach the vertical trim first onto the screen as shown below.

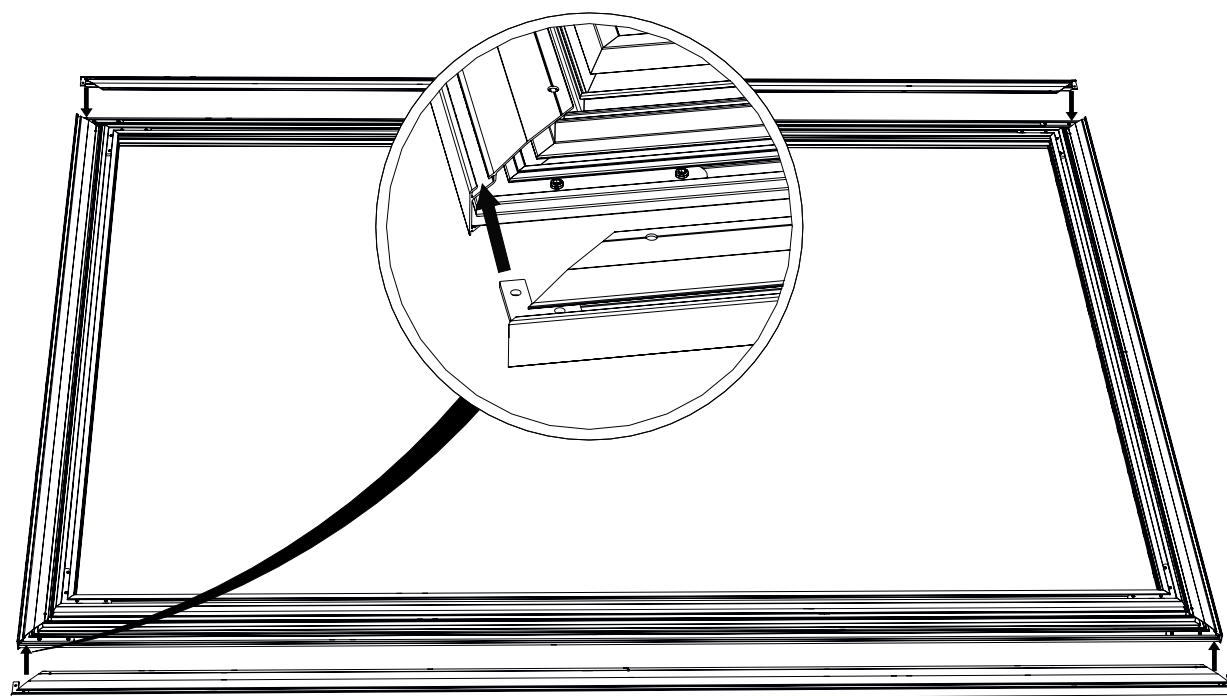
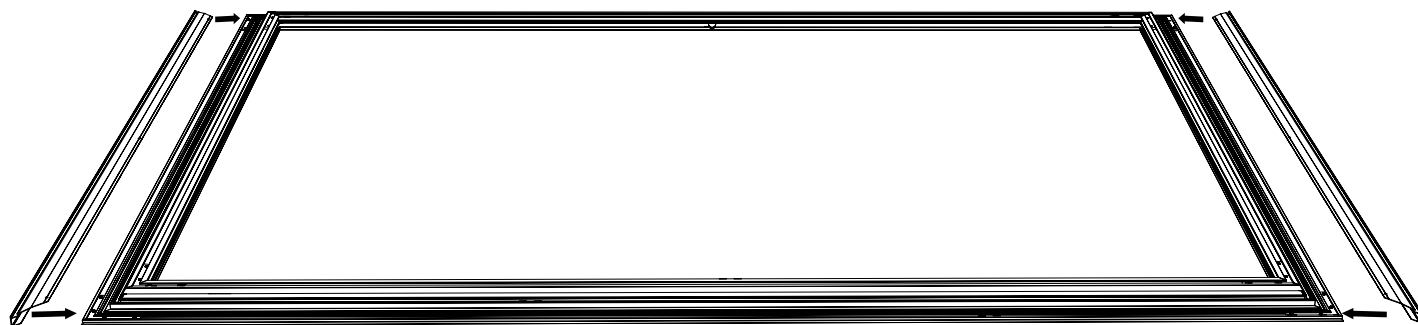

## SMALL TRIM ATTACHMENT

2

Set the horizontal trim with corner brackets; square the corners and tighten corner brackets. Fasten the screw to the frame channel. Align the holes in the channel and install screws.

**Split Frame Only:** Connect the horizontals at the middle by installing quantity 4  $\frac{1}{4}$ –20 x  $\frac{1}{4}$ " screws trough the trim into the splice bar.

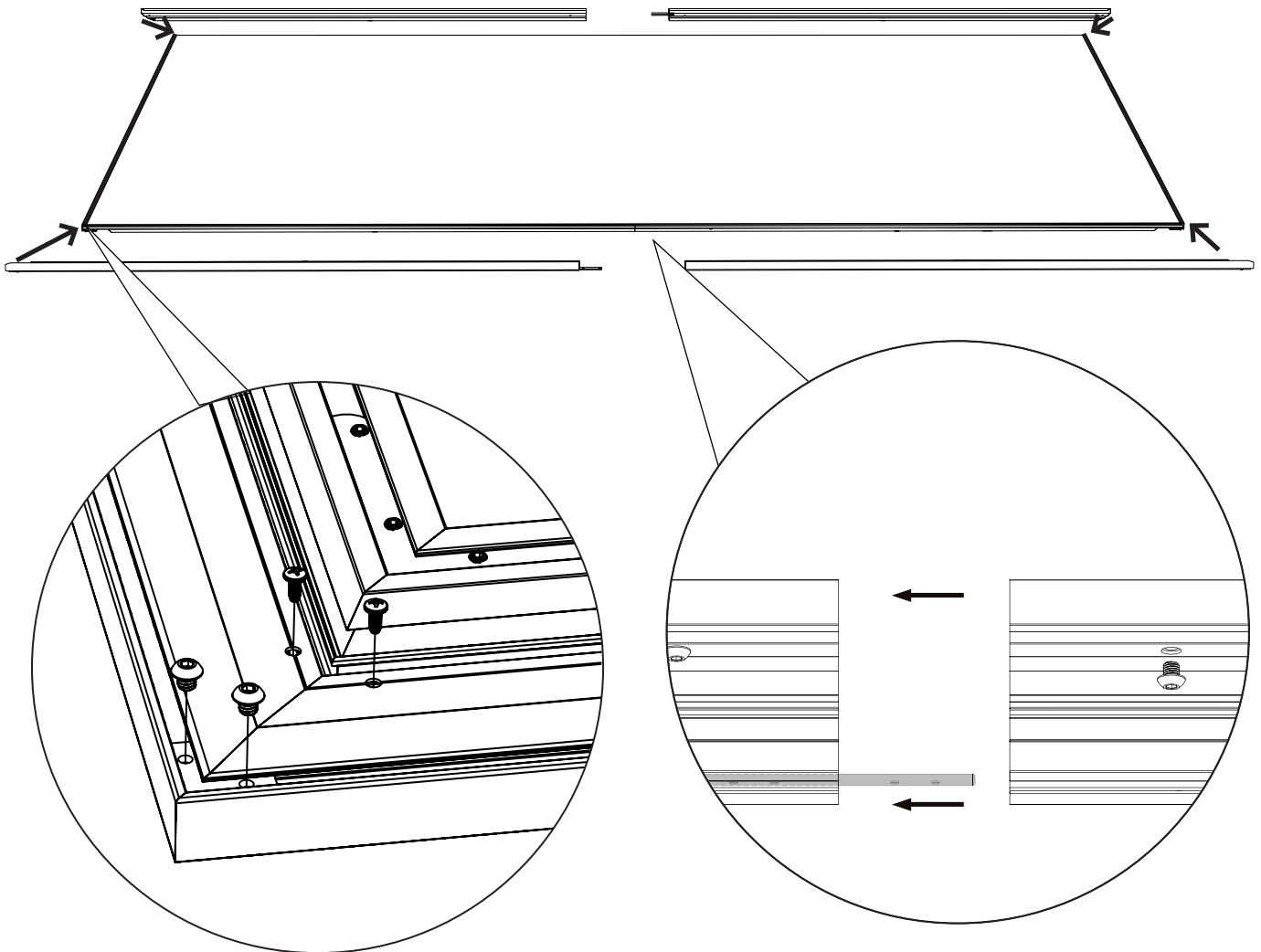

**Split Frame Only**



## MEDIUM TRIM ATTACHMENT

1

Attach the vertical trim onto the screen as seen below.

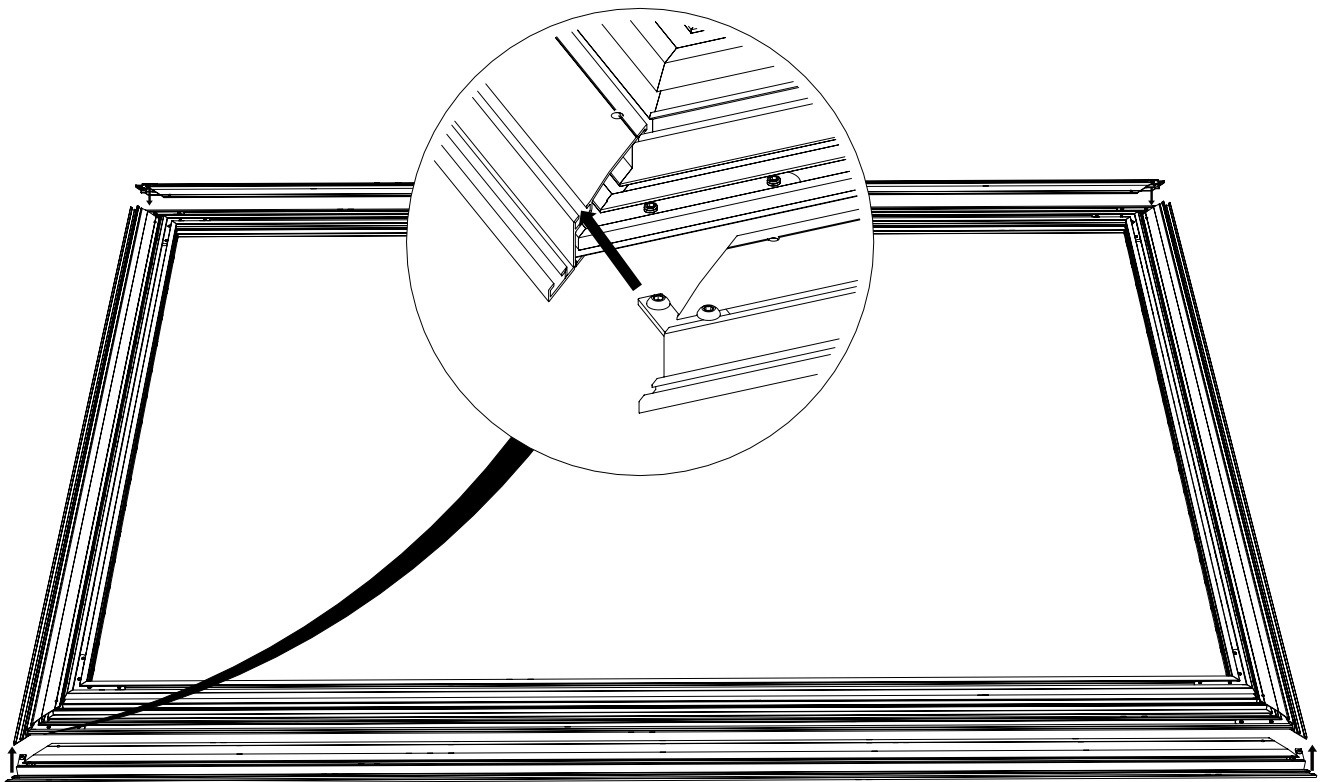
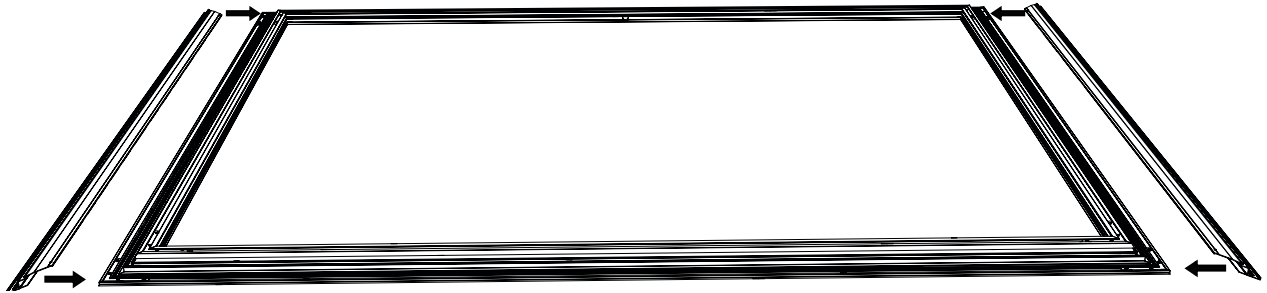

## MEDIUM TRIM ATTACHMENT

2

Set the horizontal trim with corner brackets; square the corners and tighten corner brackets. Fasten the screw to the frame channel. Align the holes in the channel and install screws.

**Split Frame Only:** Connect the horizontals at the middle by installing quantity 4  $\frac{1}{4}$ -20 x  $\frac{1}{4}$ " screws trough the trim into the splice bar.

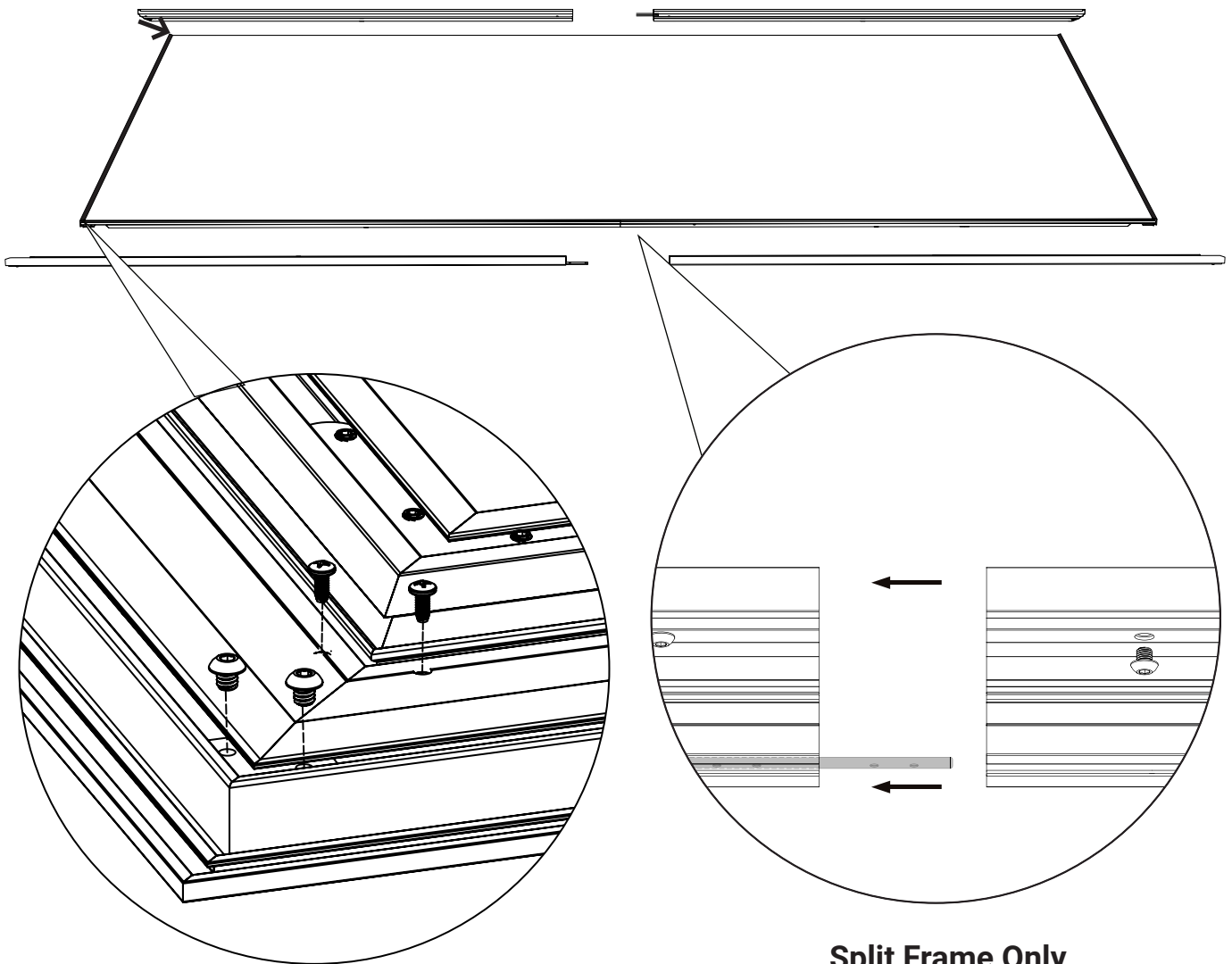

**Split Frame Only**

# LOGO ATTACHMENT

1

Attach the logo to the trim by holding it at the middle of the horizontal trim and allowing the magnet pull and attach to the back of the trim.

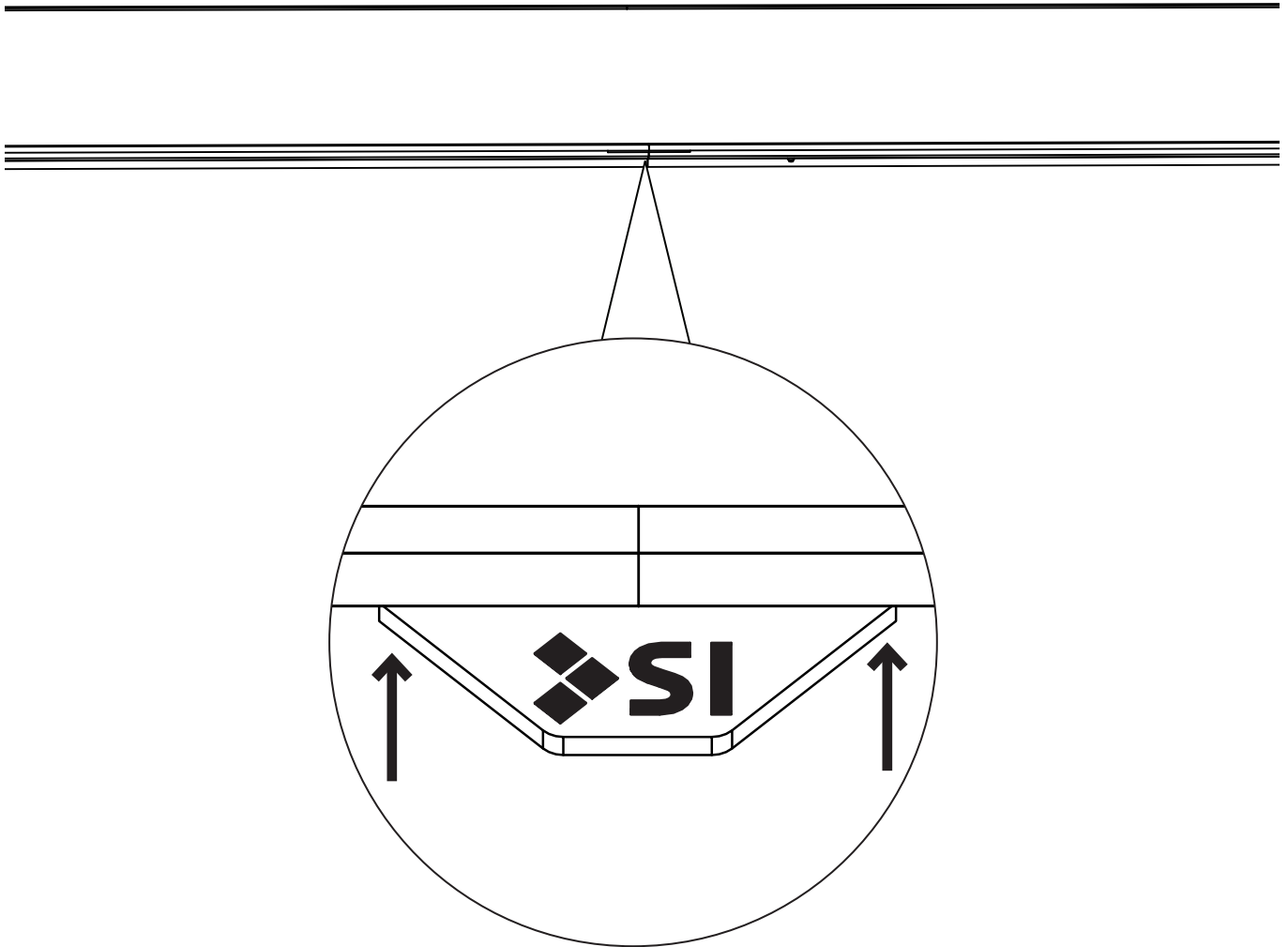

# WALL MOUNTING

- 1 Install brackets into the wall structure, at least 6" from the edge of the screen and up to  $\frac{1}{3}$  the width of the screen.

**Note:** Drill the holes to a firm stud; use a stud finder to locate the studs.

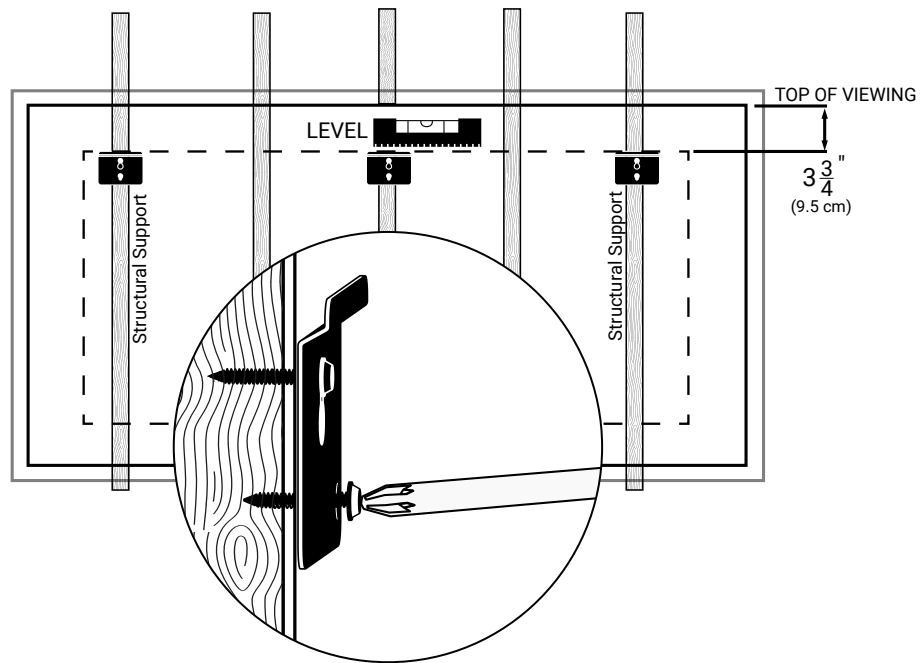

- 2 Use two or more people to carefully lift the screen up and latch onto the brackets.

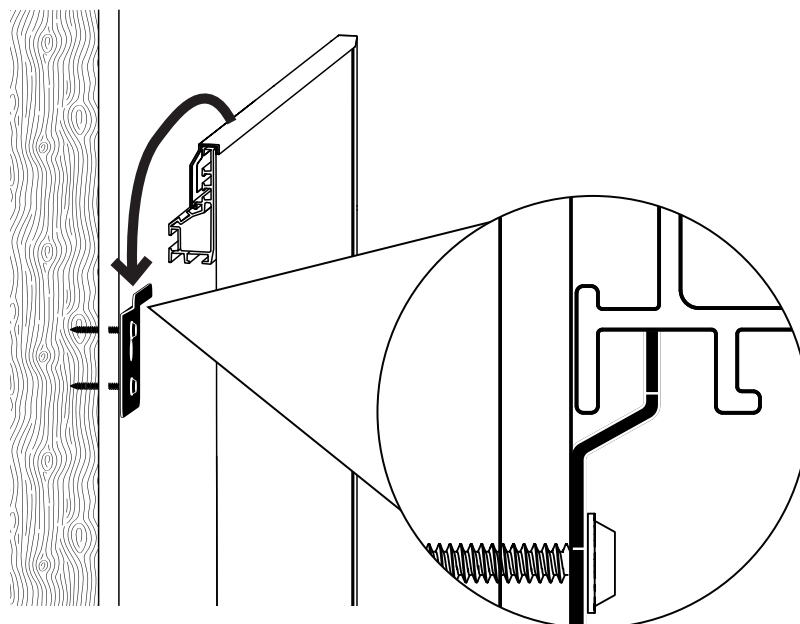

# FLOWN MOUNTING

- 1 Install brackets into wall structure at least 6" from the edge of the screen, up to  $\frac{1}{3}$  the width of the screen. Screw in through the flown brackets provided, as shown in the image below.

**Note:** Make sure to drill the holes into a beam that can support the weight of the screen.

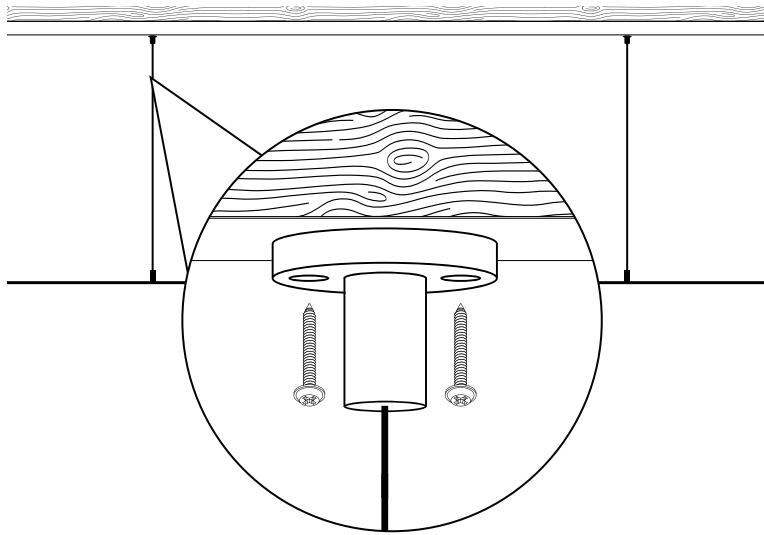

**Note:** If pulled too far, the screen can be lowered by pushing down on the top of the flying mount.

- 2 For future adjustability, do not cut the cables. Simply tape the extra cable to the back of the screen frame.

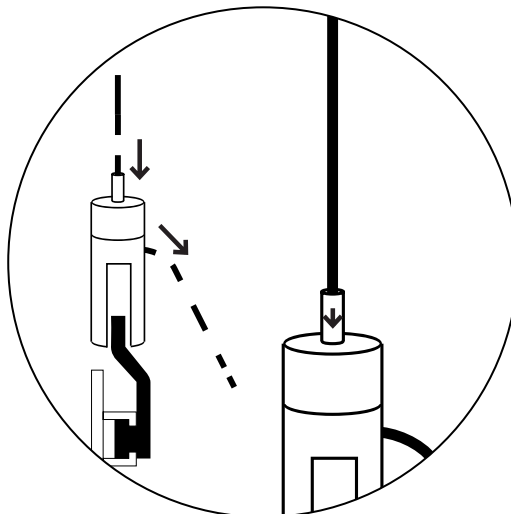

## IR LIGHTING HEX CODES

20 13 5C A3	20 13 5D A2	20 13 41 BE	20 13 40 BF
20 13 58 A7	20 13 59 A6	20 13 45 BA	20 13 44 BB
20 13 54 AB	20 13 55 AA	20 13 49 B6	20 13 48 B7
20 13 50 AF	20 13 51 AE	20 13 4D B2	20 13 4C B3
20 13 1C E3	20 13 1D E2	20 13 1E E1	20 13 1F E0
20 13 18 E7	20 13 19 E6	20 13 1A E5	20 13 1B E4
20 13 14 EB	20 13 15 EA	20 13 16 E9	20 13 17 E8
20 13 10 EF	20 13 11 EE	20 13 12 ED	20 13 13 EC
20 13 0C F3	20 13 0D F2	20 13 0E F1	20 13 0F F0
20 13 08 F7	20 13 09 F6	20 13 0A F5	20 13 0B F4
20 13 04 FB	20 13 05 FA	20 13 06 F9	20 13 07 F8

# IP CONTROLLED LIGHTING SETUP

## BACKLIGHT IP OPTION ONLY

### Initial Setup:

Before attempting to connect the LED IP to Phillips Hue, ensure that the Hue Bridge is powered on and connected to the local Wi-Fi network.

1. Begin by connecting the power supply to an electrical outlet. After a few seconds, the LEDs will power on to a white color.
2. Open the Phillips Hue app on a smart device, navigate to "Light Setup" in the "Settings" tab.
3. Press the "Plus" button in the lower right-hand corner, then press "Search."
4. It may take several seconds to connect. Once connected, the LEDs will emit green.
5. The LED IP will appear in the Phillips Hue app as "Extended Color Light 1" and "Dimmable Light 1." Only use "Extended Color Light 1" to control the LEDs. "Dimmable Light 1" should be deleted.
6. After the LED IP is connected, it can be renamed and used like any Hue lamp.

### Reset (Required to connect to a different Phillips Hue):

1. Begin with the LED IP powered on.
2. Turn off for a minimum of 2 seconds.
3. Turn on and wait for LEDs to light up.
4. Repeat the off/on procedure a total of four times.
5. At this point the LEDs will begin blinking for 10 seconds.
6. Once the LEDs stop blinking, repeat the off/on procedure two more times.
7. At this point the LED IP will reset. Once complete, the LEDs will emit a white color.

**Note:** The LED IP can be connected and controlled by only one Phillips Hue Bridge at a time.

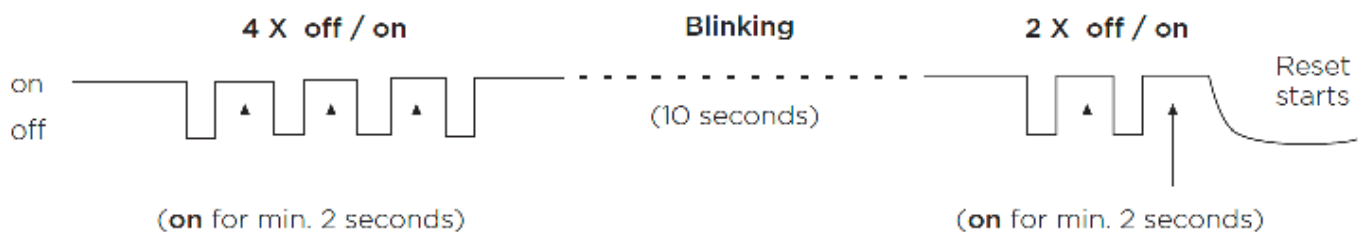

# NOTES

- 
1. \_\_\_\_\_
  2. \_\_\_\_\_
  3. \_\_\_\_\_
  4. \_\_\_\_\_
  5. \_\_\_\_\_
  6. \_\_\_\_\_
  7. \_\_\_\_\_
  8. \_\_\_\_\_
  9. \_\_\_\_\_
  10. \_\_\_\_\_
  11. \_\_\_\_\_
  12. \_\_\_\_\_
  13. \_\_\_\_\_
  14. \_\_\_\_\_
  15. \_\_\_\_\_
  16. \_\_\_\_\_
  17. \_\_\_\_\_
  18. \_\_\_\_\_





**Screen Innovations**

9715-B Burnet Rd, Suite 400 Austin, TX 78758

512.832.6939

[www.screeninnovations.com](http://www.screeninnovations.com)