

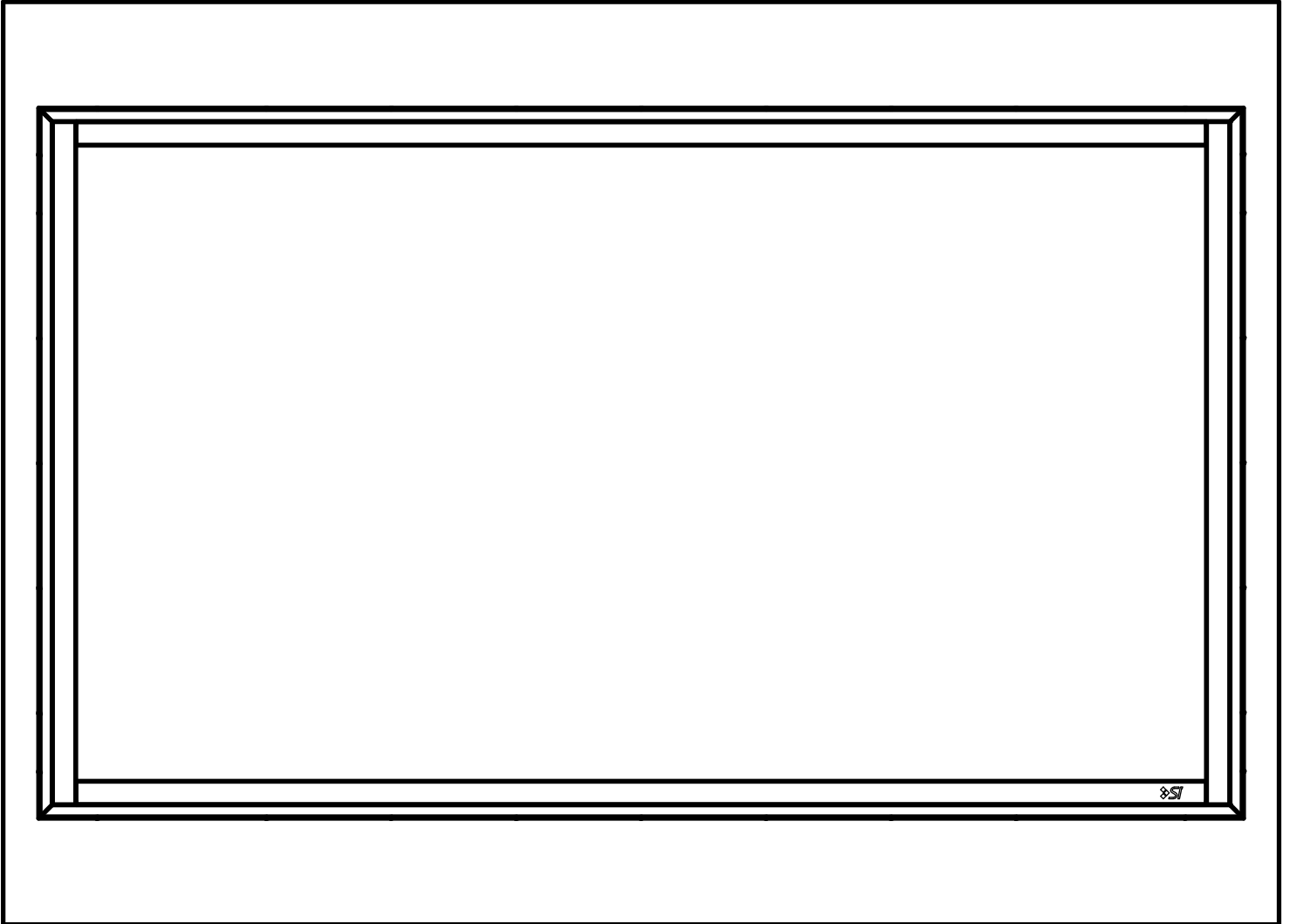

FlexGlass In-Wall



Owner's Manual

FlexGlass Screen Material (Ships in separate package)

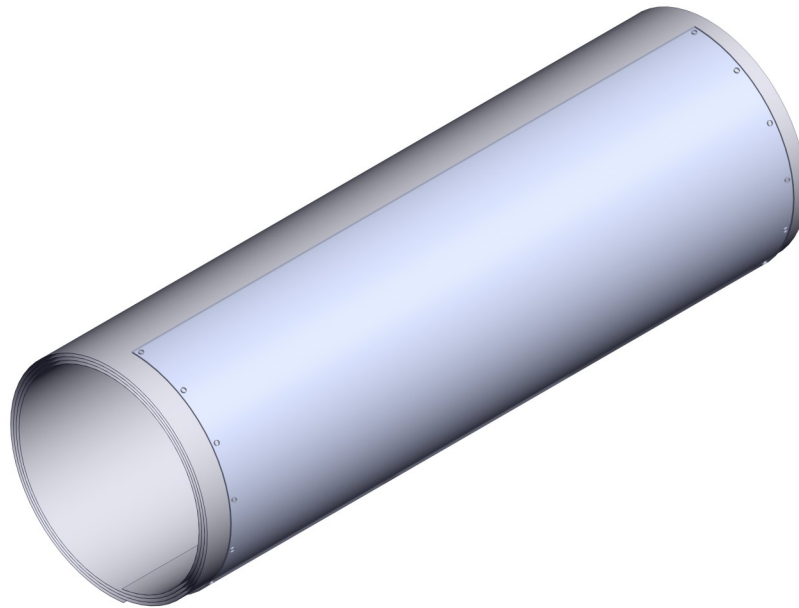

Frame and Trim

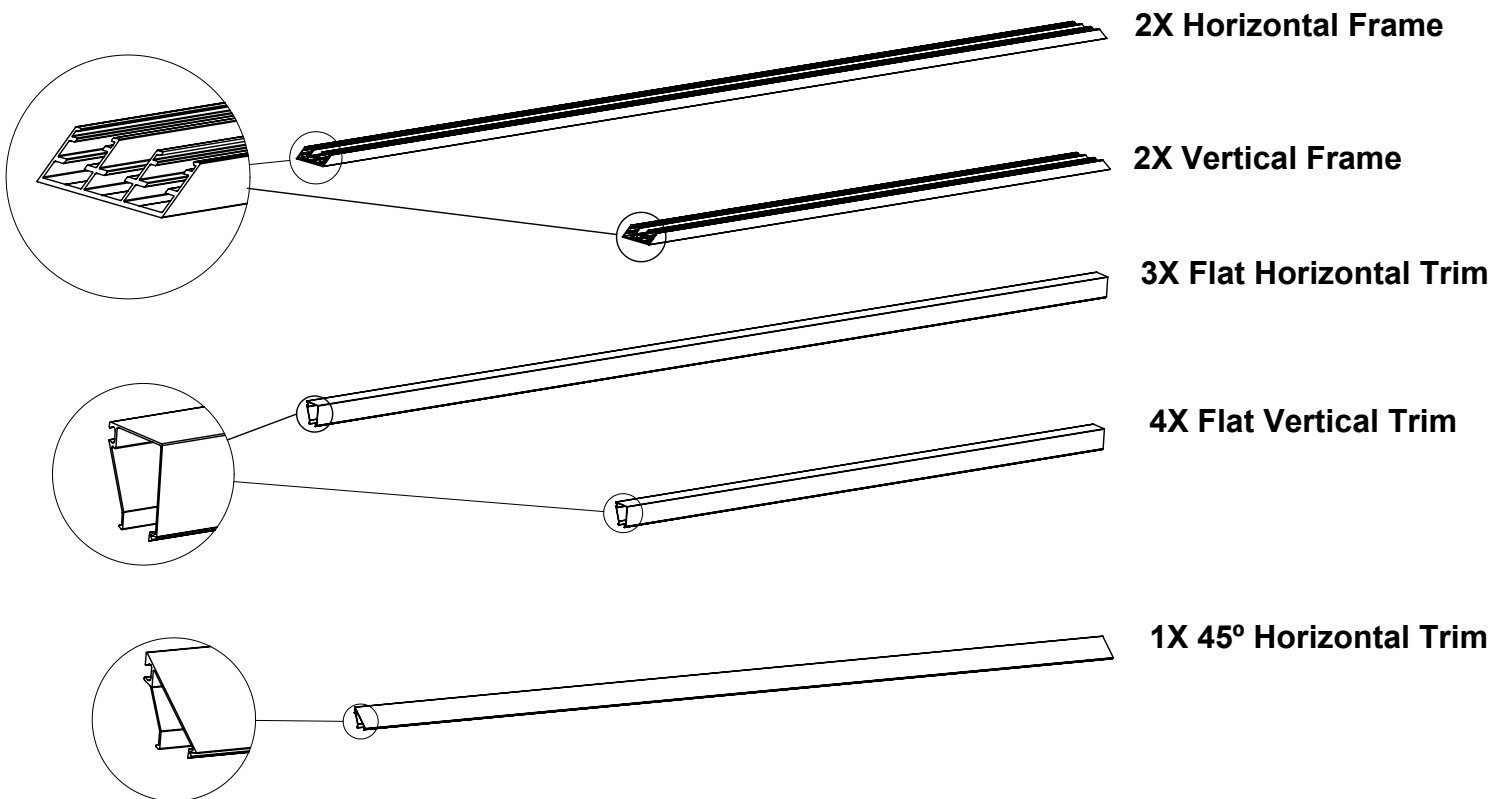

Hardware Box contents

8 x Corner Brackets

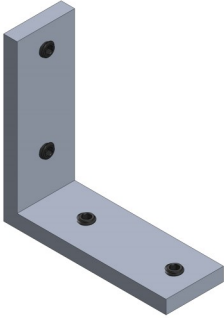

8-32 Hex Nuts

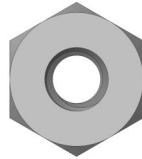

Wood Screws



Shims



1/8 Hex Key



9/64 Ball Point Hex Driver



11/32 Nut Driver



Driver Bit For
Wood Screws



Gloves



Pre-Assemble The Frame

1) Insert 8 Corner brackets into the slots in the shorter vertical frame pieces.

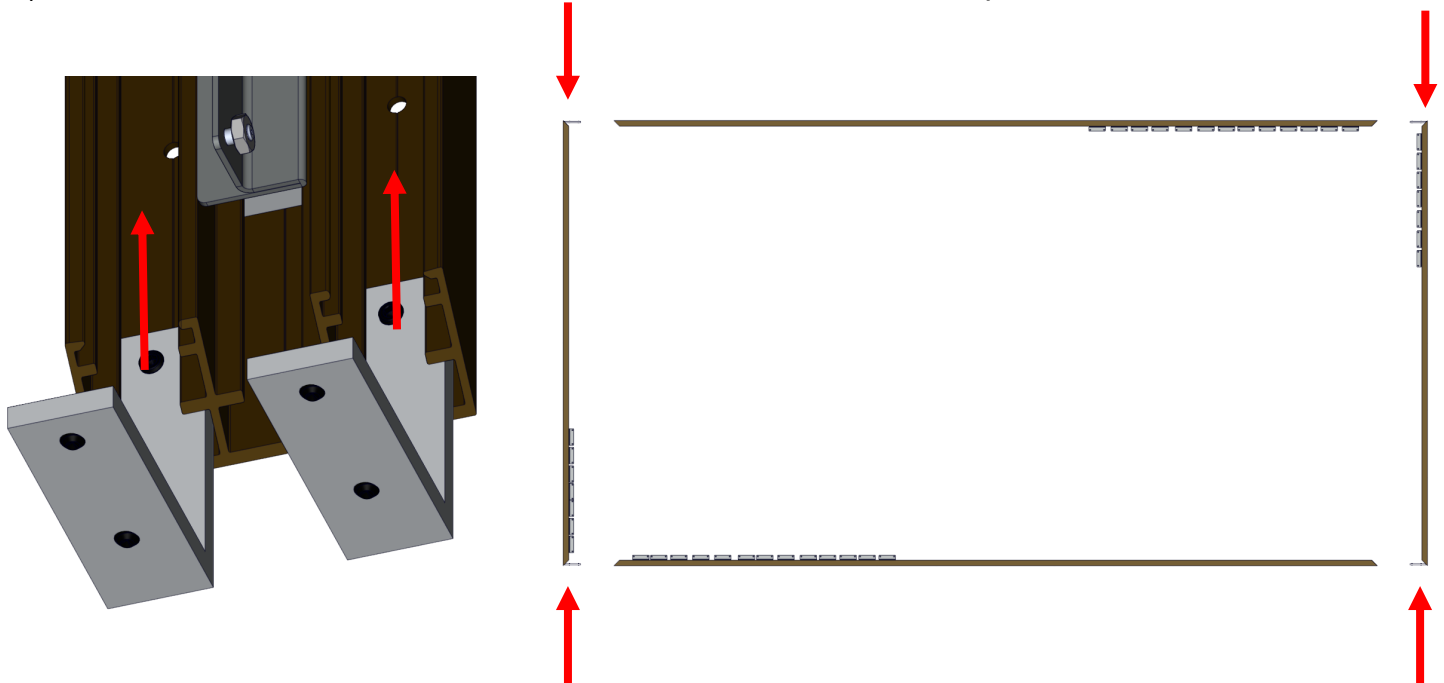

2) Make sure that the viewing sides stickers and posts in the tensioners are pointing the same direction a, then slide the corner brackets into the horizontal frame pieces, make sure all corners align well, and lock all set screws to secure corner brackets.

Tensioners Facing the same way

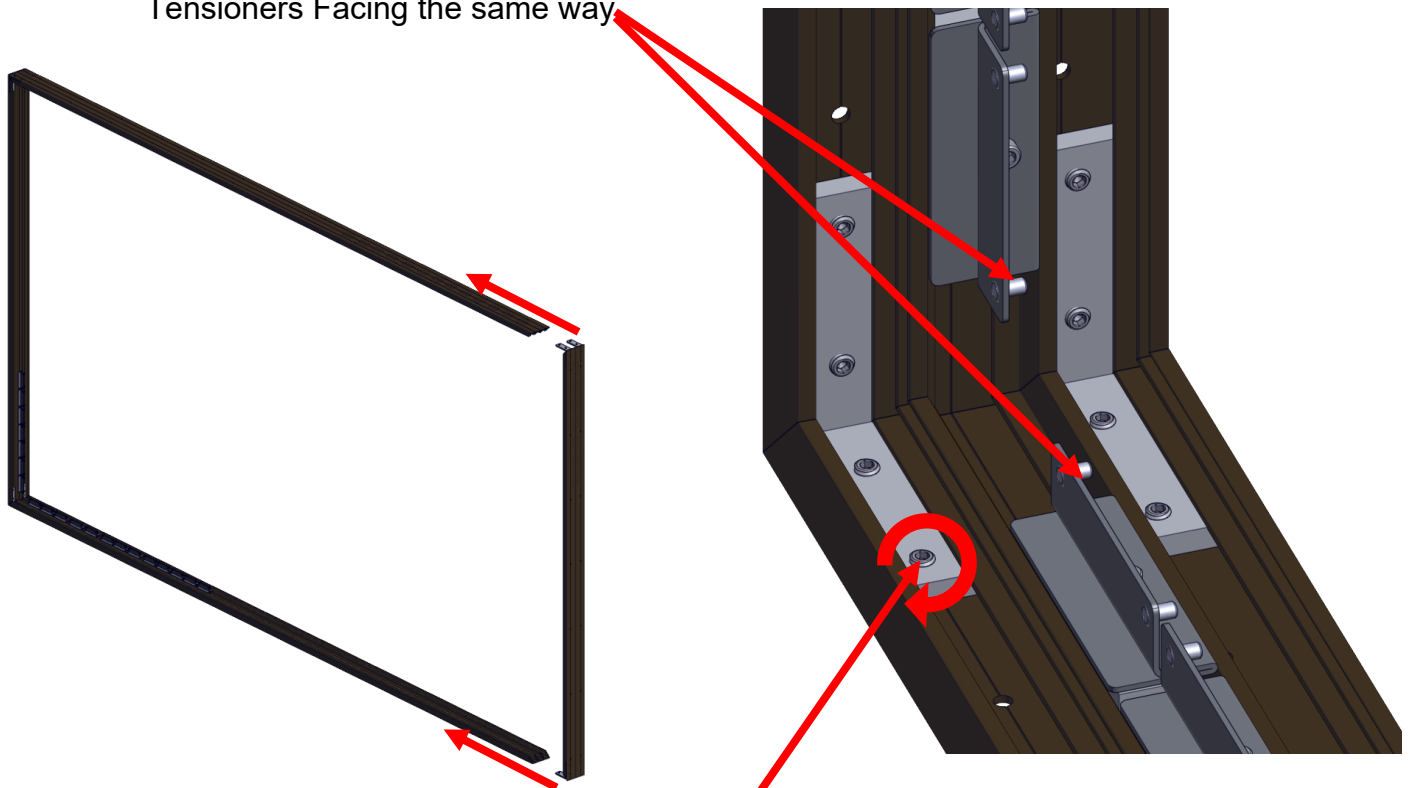

Tighten all Set Screws in corner brackets

Install the Frame in the wall

3) Make sure the rough opening in the wall has been prepared such that it is 1/4" to 1/2" larger than the assembled frame.

Screen and Frame Detail
(Similar to rough in for a window frame)

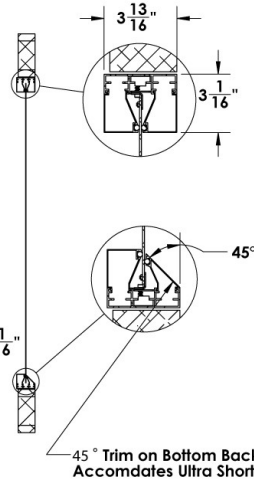
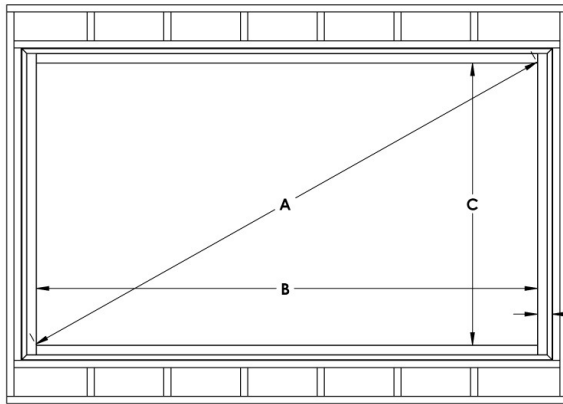

Rough Opening

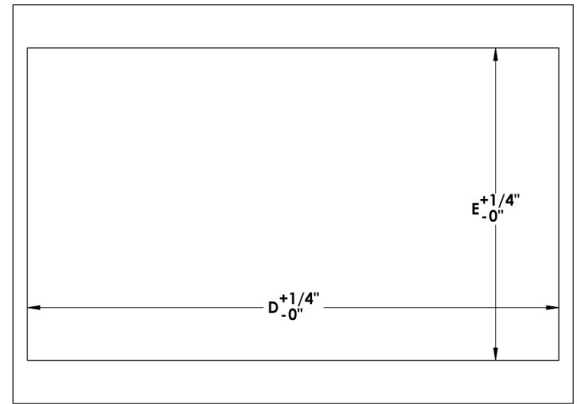

4) Slide the frame into the rough opening and secure the bottom frame piece to the sill with the wood screws. Make sure the viewing side stickers and the posts in the tensioners are all facing the audience.

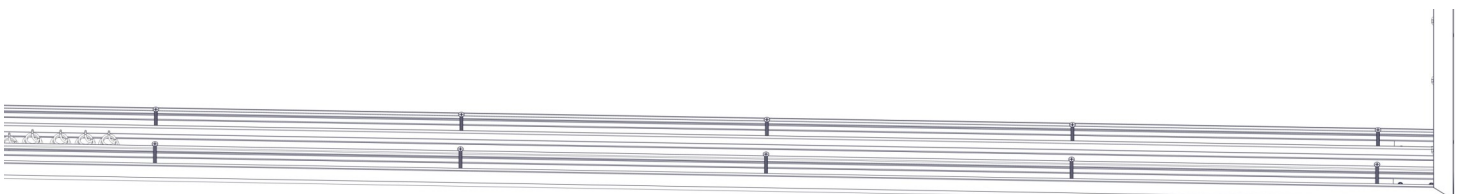
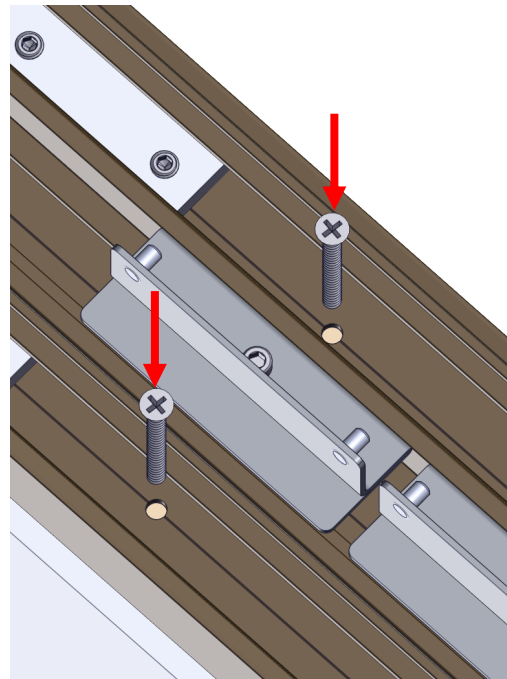
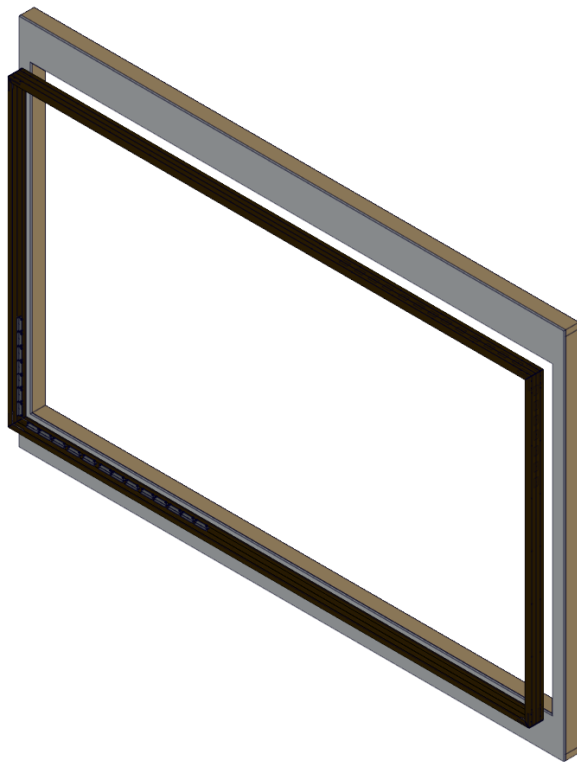

5) Use the shims to fill the gaps around the sides and top of the frame. Then Secure the side and top frame pieces to the rough opening with the wood screws drilled directly through the shims. Make sure the frame components are secured to the wall and **straight** before proceeding.

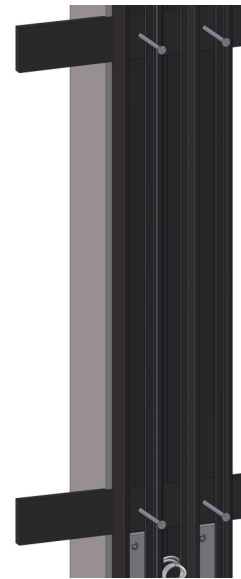
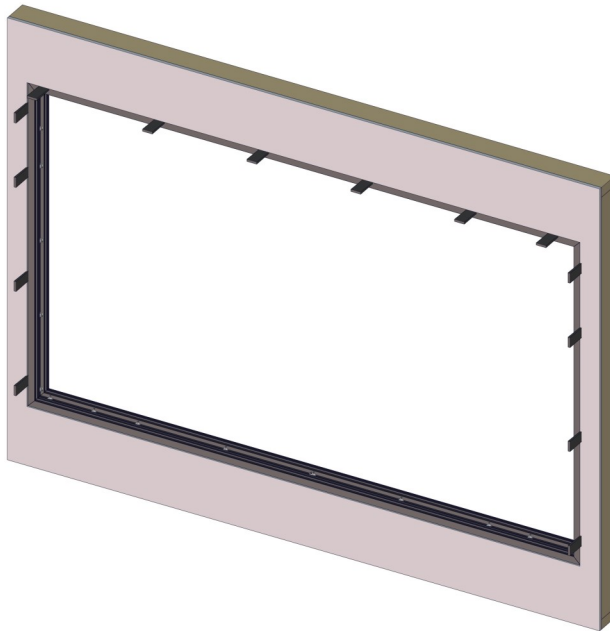

6) Once the frame is secured to the rough opening around all four sides, then bend the shims to snap off the excess material that sticks out of the back and front of the opening.

Install the Flex Glass Material in the Frame

7) Unroll the Flex Glass material onto a clean floor keeping the packaging foam in between the material and the floor.

Note: Shiny Side of FlexGlass faces the projector and Matte side faces the audience.

8) Spread out the tensioners approximately evenly spaced along the top and bottom frame. Then carefully lift the screen material up into the frame and onto the threaded posts on the tensioners. Secure the screen material to the tensioners with the hex nuts. Make sure the projection side is facing the projector location.

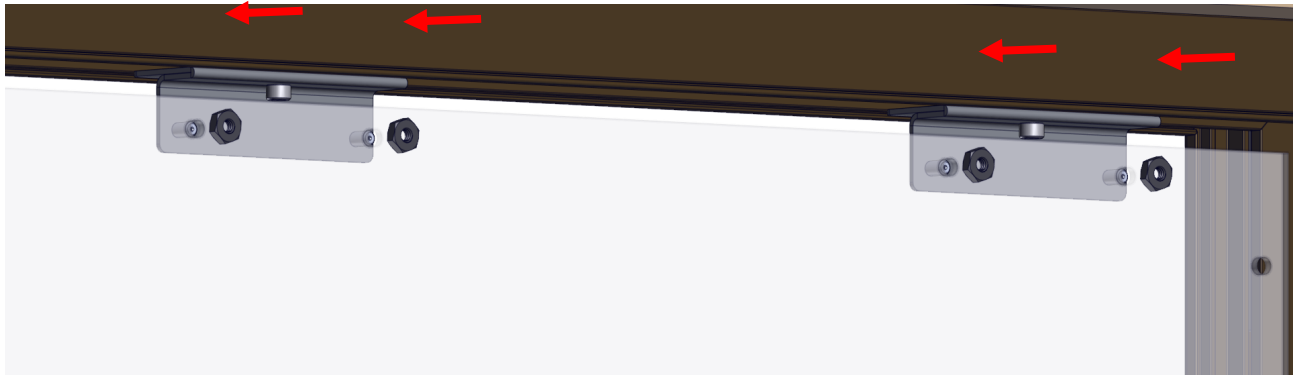

9) Continue to secure the screen material to all the tensioners with the hex nuts.

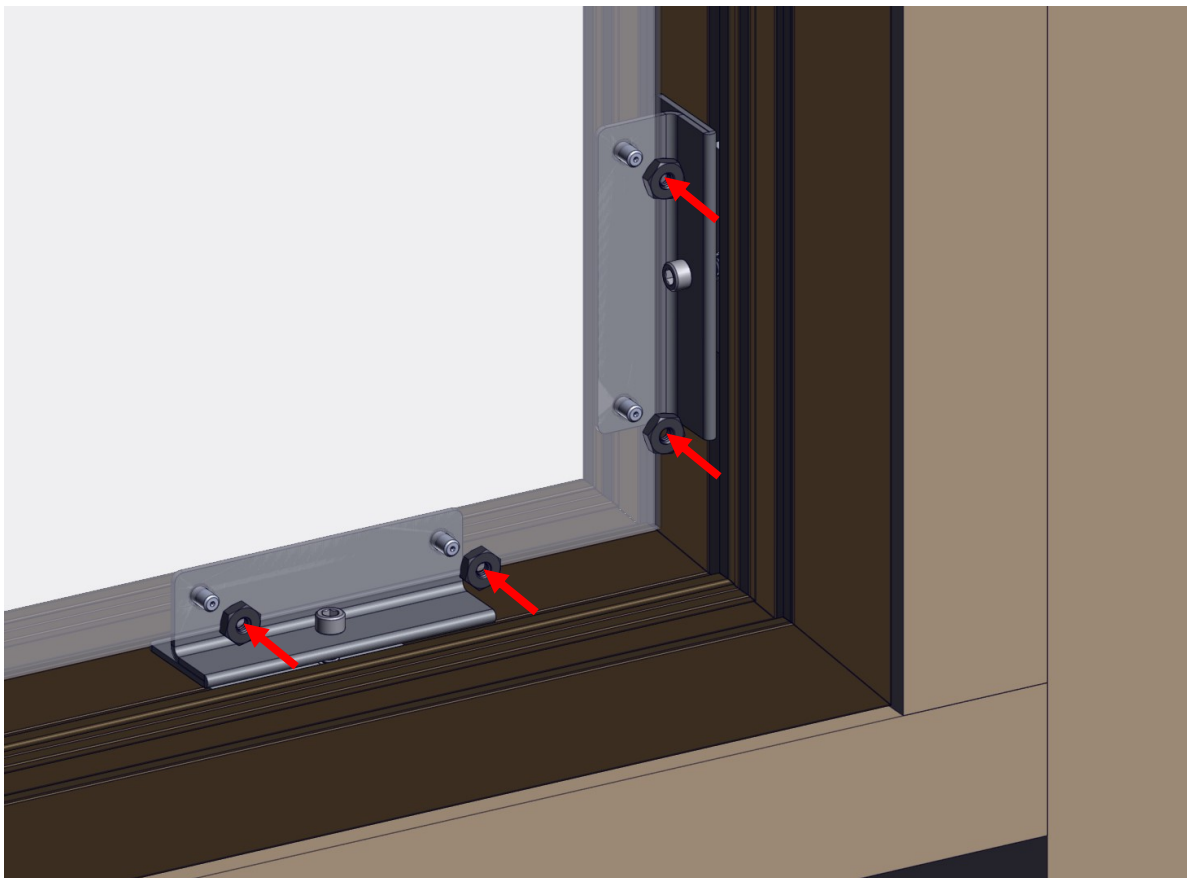

Tension the FlexGlass Material in the Frame

10) Tension the FlexGlass by turning the screws on the tensioners as shown below.

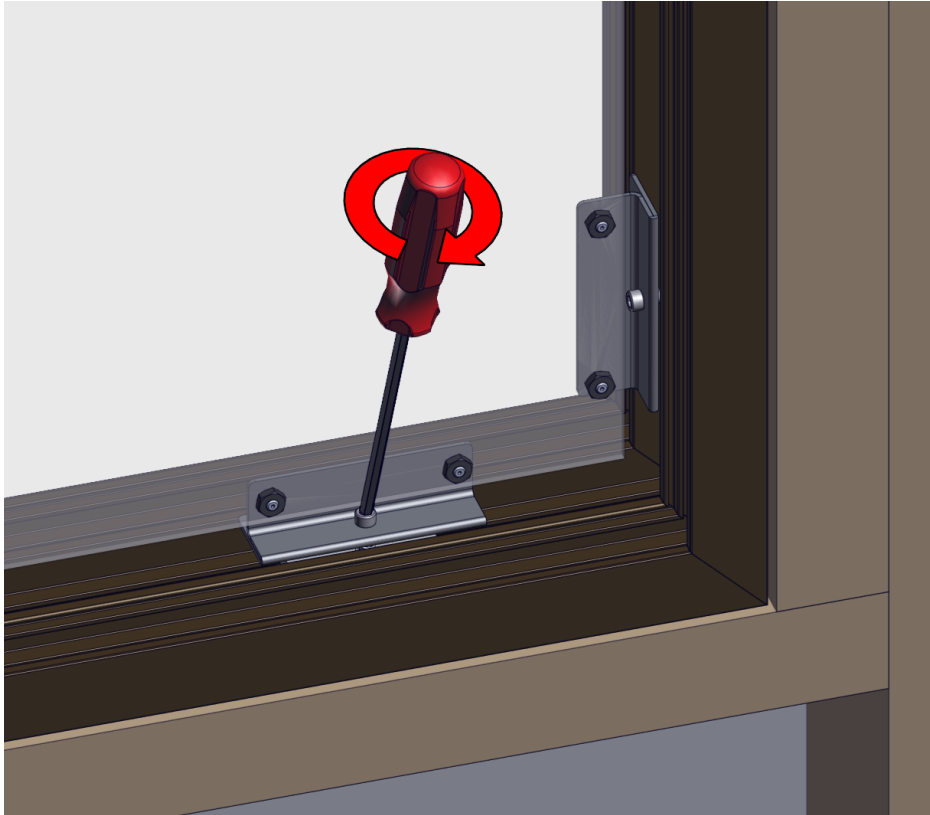

11) Continue applying tension to the screen all the way around until the FlexGlass is tight and flat. You will need to make at least 2 passes around the screen to achieve proper tightness. If the frame starts to bend then release tension until it goes straight. **The frame must be straight to finish installing the trim in following steps.**

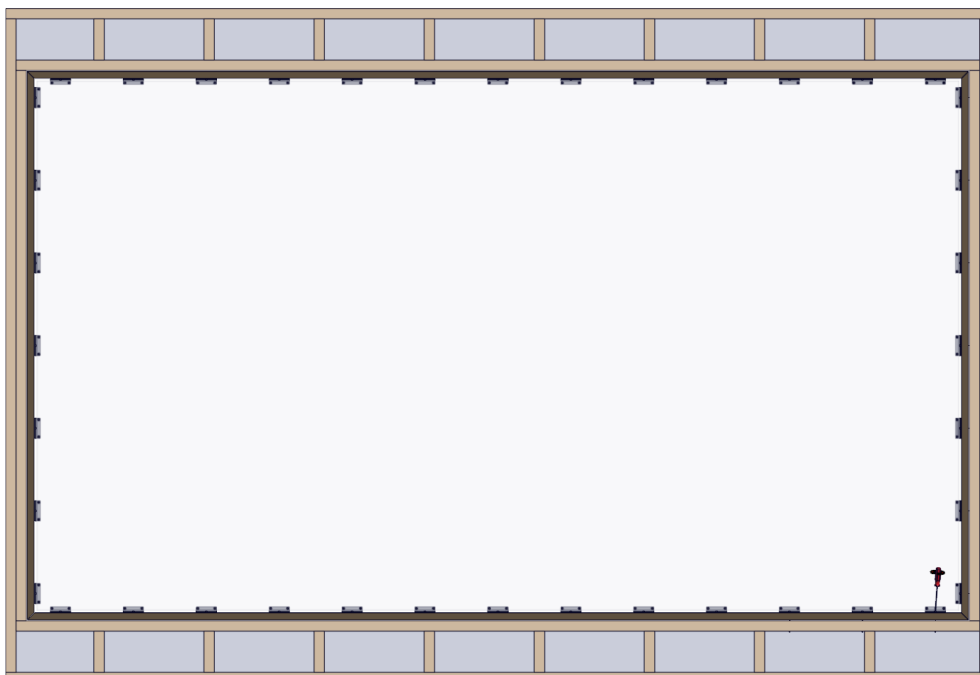

Attach the Trim

12) Snap in the vertical trim pieces first as shown.

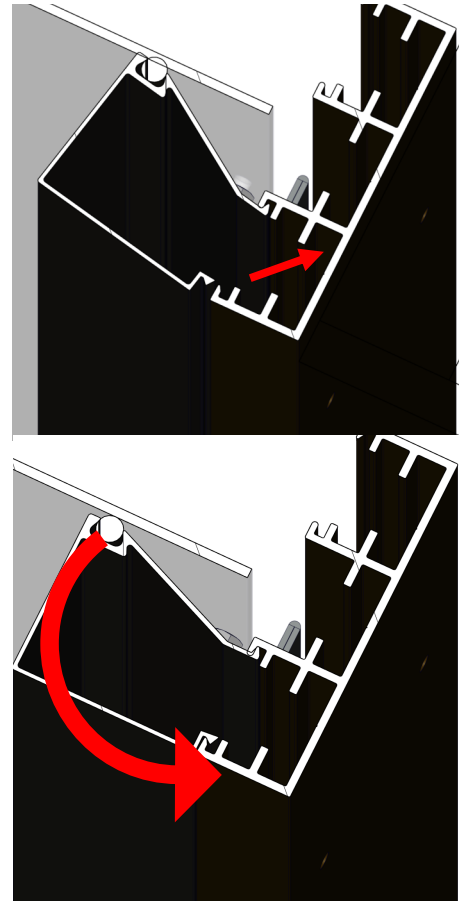
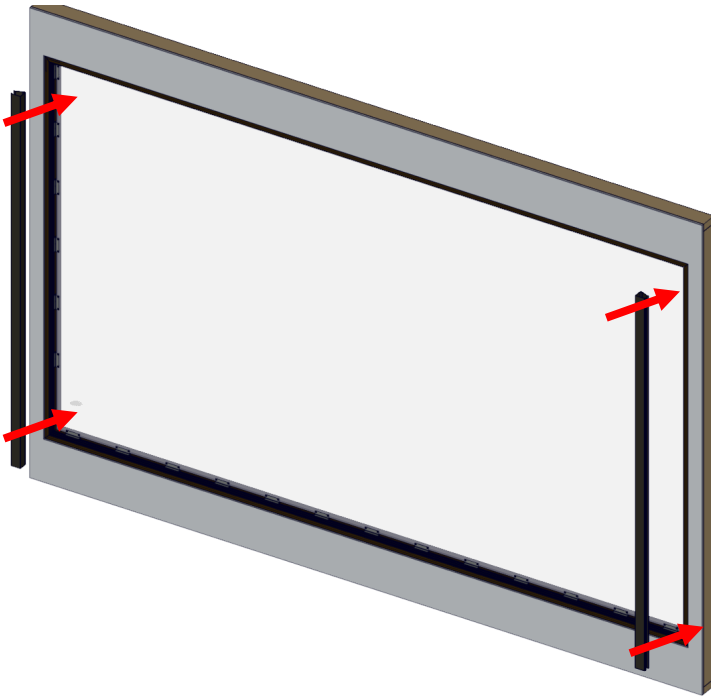

13) Snap in the remaining trim pieces. Note that the single 45° trim piece goes on the projector side along the bottom if the projector is mounted on the floor or along the top if the projector is mounted on the ceiling.

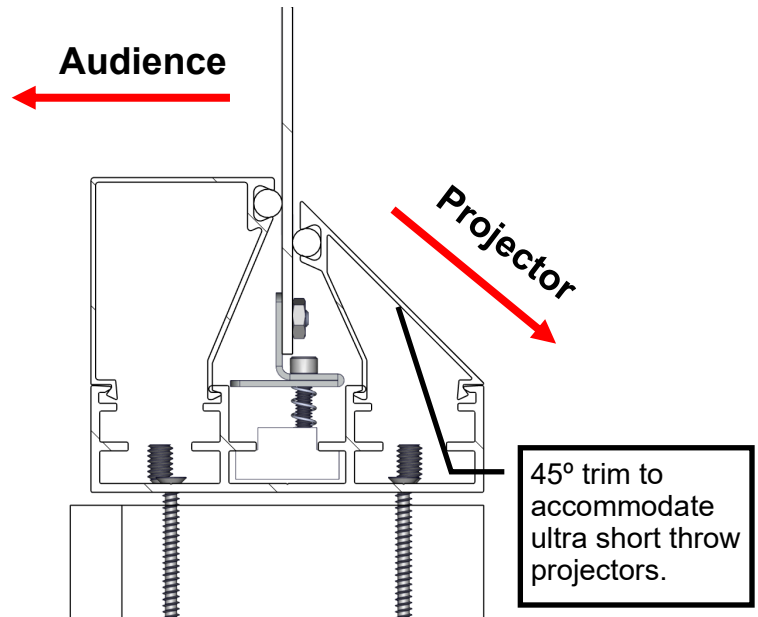
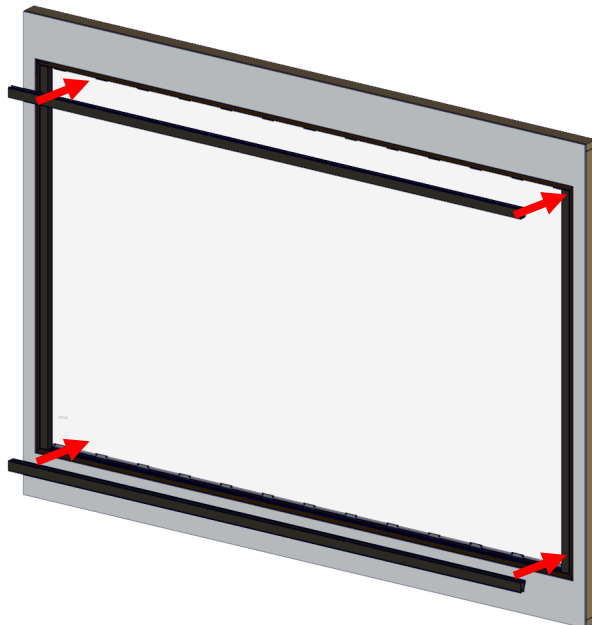

**LIMITED ONE YEAR WARRANTY
ON SCREEN INNOVATIONS PRODUCTS**

Screen Innovations warrants its products to the original purchaser only, to be free from defects in materials and workmanship for a period of one (1) year from the date of purchase by the original purchaser provided they are properly operated according to Screen Innovations' instructions and are not damaged due to improper handling or treatment after shipment from the factory.

This warranty does not apply to equipment showing evidence of misuse, abuse or accidental damage, or which has been tampered with or repaired by a person other than authorized Screen Innovations personnel.

Screen Innovations' sole obligation under this warranty shall be to repair or to replace (at Screen Innovations' option) the defective part of the merchandise. Returns for service should be made to your Screen Innovations' dealer. If it is necessary for the dealer to return the screen or part to Screen Innovations, transportation expenses to and from Screen Innovations are payable by the purchaser and Screen Innovations is not responsible for damage in shipment. To protect yourself against damage or loss in transit, insure the product and prepay all transportation expenses.

THIS WARRANTY IS IN LIEU OF ALL OTHER WARRANTIES, EXPRESS OR IMPLIED, INCLUDING WARRANTIES AS TO FITNESS FOR USE AND MERCHANT ABILITY. Any implied warranties of fitness for use, or merchantability, that may be mandated by statute or rule of law are limited to the one (1) year warranty period. This warranty gives you specific legal rights, and you may also have other rights, which vary from state-to-state. NO LIABILITY IS ASSUMED FOR EXPENSES OR DAMAGES RESULTING FROM INTERRUPTION IN OPERATION OF EQUIPMENT, OR FOR INCIDENTAL, DIRECT, OR CONSEQUENTIAL DAMAGES OF ANY NATURE.

In the event that there is a defect in materials or workmanship of a Screen Innovations product, you may contact our Sales Partners at 9715-B Burnet Road Suite 400, Austin, TX 78758, (512) 832-6939.

IMPORTANT: THIS WARRANTY SHALL NOT BE VALID AND SCREEN INNOVATIONS SHALL NOT BE BOUND BY THIS WARRANTY IF THE PRODUCT IS NOT OPERATED IN ACCORDANCE WITH SCREEN INNOVATIONS' WRITTEN INSTRUCTIONS.

Keep your sales receipt to prove the date of purchase and your original ownership.



NOTES



NOTES