

Transformer[®]

Owner's Manual

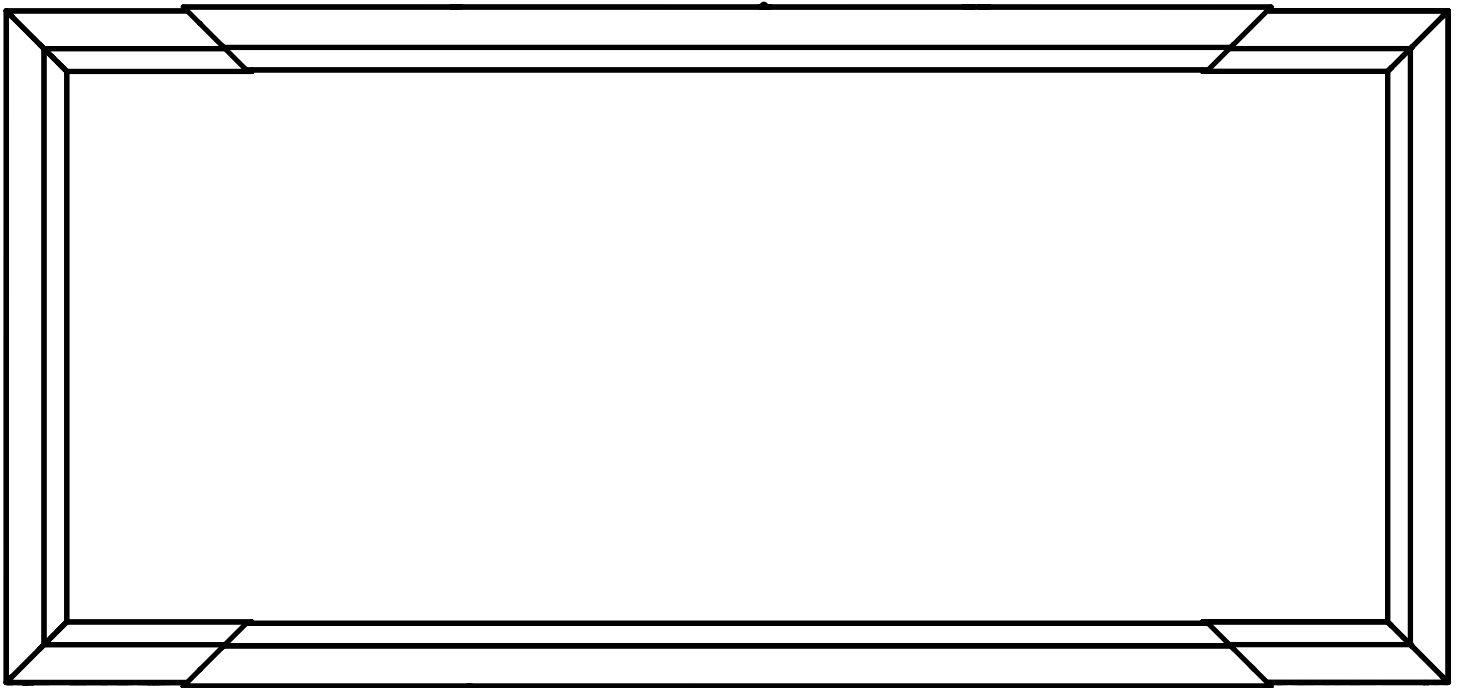

INSTALLERS: PLEASE LEAVE THIS
MANUAL WITH THE OWNER.



APPLY S/N
STICKER HERE



LIMITED ONE YEAR WARRANTY ON SCREEN INNOVATIONS PRODUCTS

Screen Innovations warrants its products, to the original purchaser only, to be free from defects in materials and workmanship for a period of one (1) year from the date of purchase by the original purchaser provided they are properly operated according to Screen Innovations' instructions and are not damaged due to improper handling or treatment after shipment from the factory.

This warranty does not apply to equipment showing evidence of misuse, abuse, or accidental damage, or which has been tampered with or repaired by a person other than authorized Screen Innovations personnel.

Screen Innovations' sole obligation under this warranty shall be to repair or to replace (at Screen Innovations' option) the defective part of the merchandise. Returns for service should be made to your Screen Innovations' dealer. If it is necessary for the dealer to return the screen or part to Screen Innovations, transportation expenses to and from Screen Innovations are payable by the purchaser and Screen Innovations is not responsible for damage in shipment. To protect yourself against damage or loss in transit, insure the product and prepay all transportation expenses.

THIS WARRANTY IS IN LIEU OF ALL OTHER WARRANTIES, EXPRESS OR IMPLIED, INCLUDING WARRANTIES AS TO FITNESS FOR USE AND MERCHANT ABILITY. Any implied warranties of fitness for use, or merchantability, that may be mandated by statute or rule of law are limited to the one (1) year warranty period. This warranty gives you specific legal rights, and you may also have other rights, which vary from state-to-state. NO LIABILITY IS ASSUMED FOR EXPENSES OR DAMAGES RESULTING FROM INTERRUPTION IN OPERATION OF EQUIPMENT, OR FOR INCIDENTAL, DIRECT, OR CONSEQUENTIAL DAMAGES OF ANY NATURE.

In the event that there is a defect in materials or workmanship of a Screen Innovations product, you may contact our Sales Partners at 9715-B Burnet Road Suite 400, Austin, TX 78758, (512) 832-6939.

IMPORTANT: THIS WARRANTY SHALL NOT BE VALID AND SCREEN INNOVATIONS SHALL NOT BE BOUND BY THIS WARRANTY IF THE PRODUCT IS NOT OPERATED IN ACCORDANCE WITH SCREEN INNOVATIONS' WRITTEN INSTRUCTIONS.

Keep your sales receipt to prove the date of purchase and your original ownership.



Installation requires 3 or more people. Bend knees when lifting.



512-832-6939

9715-B Burnet Road Suite 400, Austin, TX 78758

screeninnovations.com

PROJECTOR PLACEMENT 5

BEFORE PROCEEDING 6

PARTS LIST 7

PREPARE THE INSTALLATION LOCATION 9

MOUNT THE FRAME 11

CONNECT THE POWER AND CONTROL WIRING..... 16

POWER 18

ATTACH SCREEN MATERIAL..... 24

ATTACH THE TRIM. 26

LED IP INSTRUCTIONS 32

SCREEN MATERIAL CLEANING INSTRUCTIONS..... 33

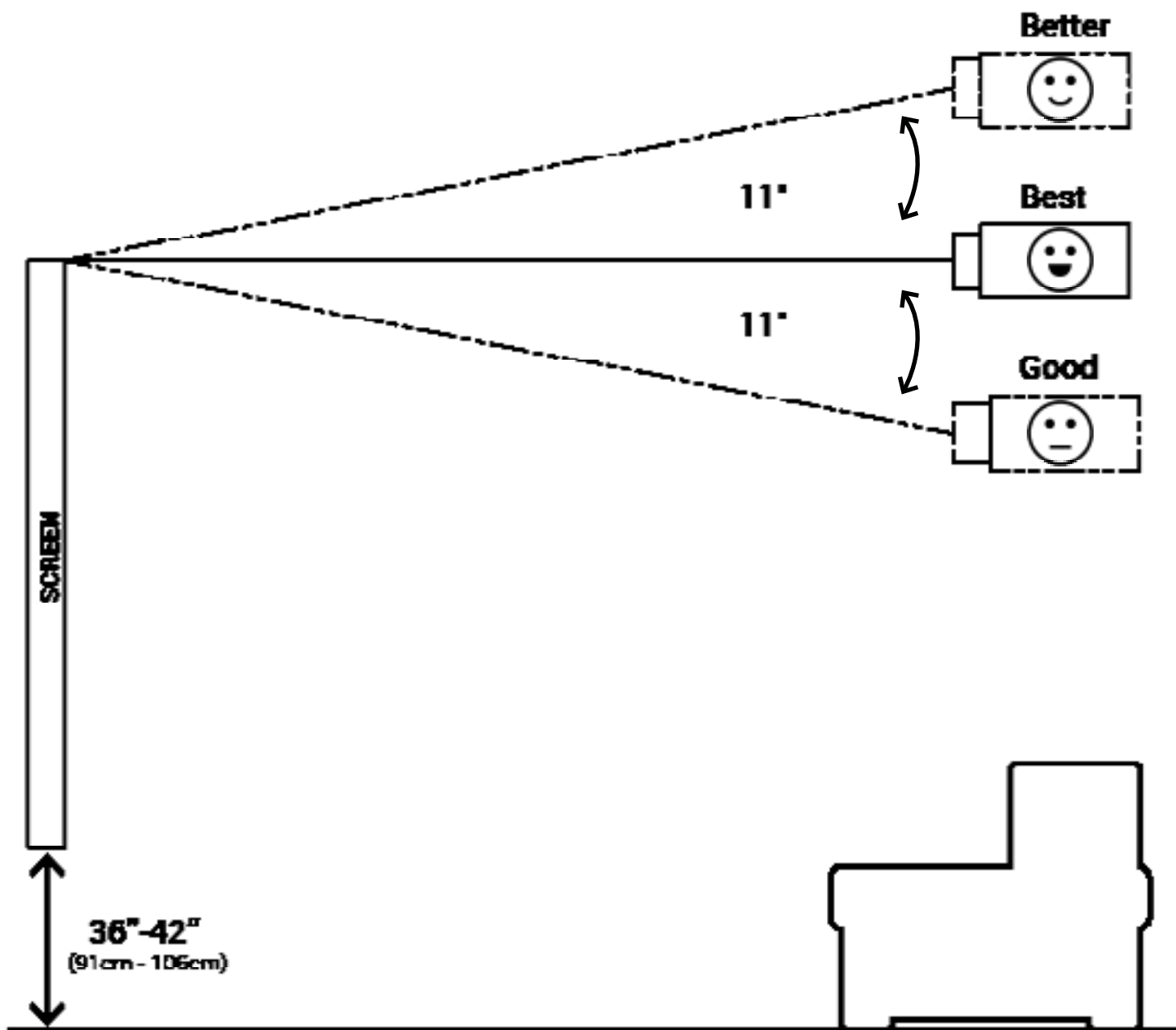



CAUTION: READ THE INSTRUCTIONS IN THEIR ENTIRETY BEFORE PROCEEDING. ACTIONS CONTRARY TO THE INSTRUCTIONS INVALIDATE THE WARRANTY AND MAY RESULT IN SERIOUS DAMAGE AND/OR INJURY.

INSTALLER:

- The wall used for fixture installation must be able to support 500 lbs or more. Failure to properly secure the screen may result in injury and/or damage.
- Electrical work should be performed using appropriate electrical codes and regulation, by a licensed electrical professional.
- Before running cables in walls or ceilings see controls section on for control cable requirements.
- Before removing the screen from the box, check for damage and to make sure all parts are included.
- Do not use any sharp blades when opening the screen packaging. Open by hand.
- Do not pull on the sides, crease, or fold the screen. The screen material is very delicate.
- Care in mounting and correct operation will result in long and satisfactory service from the SI screen.
- The screen should be level when installed. Always use a carpenter's level.
- Nothing should be fastened to any part of the screen assembly.
- The screen should be opened up to it's 2.40:1 position whenever not in use. Please have the control system programmed to go to it's 2.40:1 position whenever the projector is turned off.

NOTE: The screen has been thoroughly inspected and tested at factory and found to be operating properly prior to shipment.

END USER:

- To prevent damage, the operating and maintenance of the screen should be performed by experienced professionals.
- This is a finished product. Do not write or draw on the surface.
- Do not put anything near right or left sides of the screen that would come in contact or impede the normal operation of the screen when opened.
- Damage to the screen can result if an object prevents the screen from fully opening
- The resting position for the screen is in the fully open 2.4:1 position. The screen should return to the this position whenever it is not in use.

PARTS LIST

TRANSFORMER

NOTE: Unpack the long cardboard box first and check to make sure everything listed is included.

HARDWARE BOX



1X
Power Cord



20X to 30X
1/4" Lag
Screws



4X
Gloves



2X
1/4-20
Screws



4X
#10-32
Flat Head
Screws

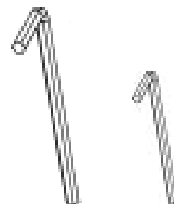

1X
3/16" & 1/8"
Hex Key



1X
Top-Snapper

SDN Decoflex
Wall Switch

Cable Cord Grip for
Controls Junction Box

Zip Ties

CAT5 Cable

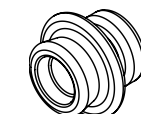

Snap Fixed

CENTER TRIM BOX

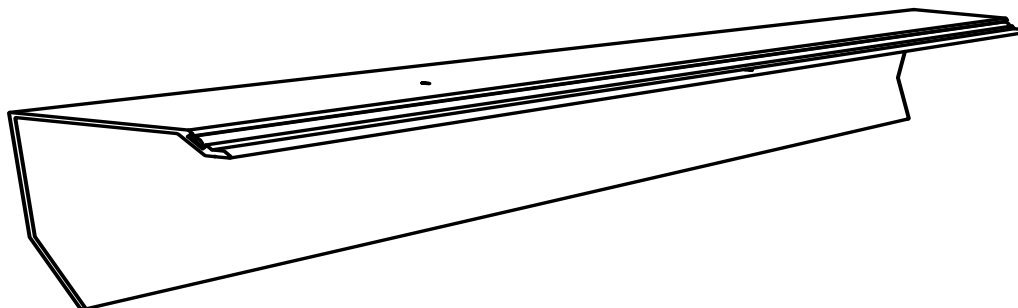

2X
Center Trim
Leave in plastic bag

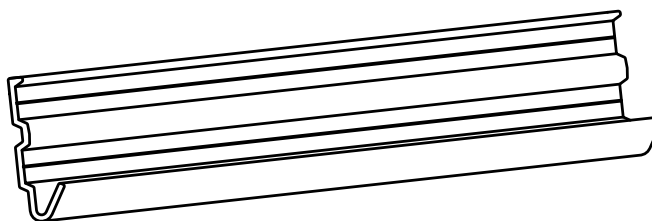

1X
Long Wall Bracket

Controller Junction
Box

PARTS LIST

TRANSFORMER

CRATE

Left Wing Trim Assembly
Leave in plastic bag

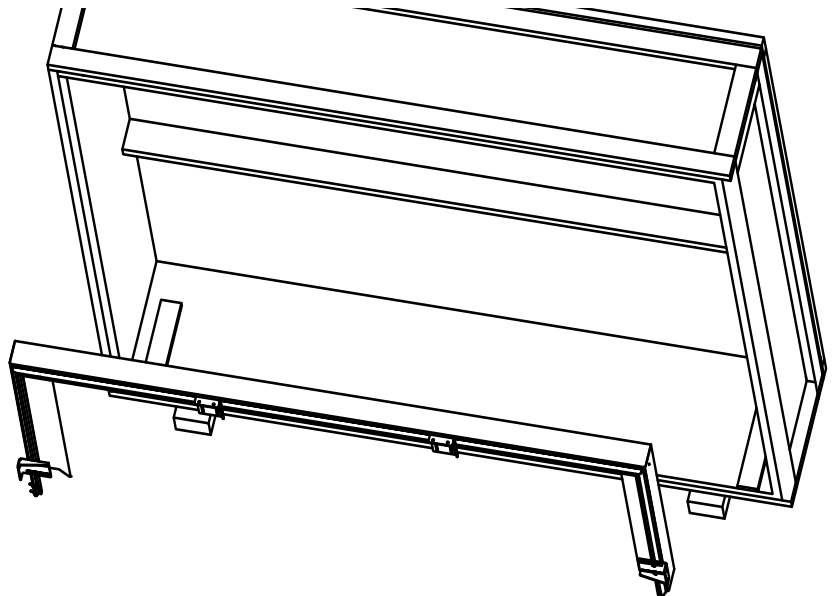

Right Wing Trim Assembly
Leave in plastic bag

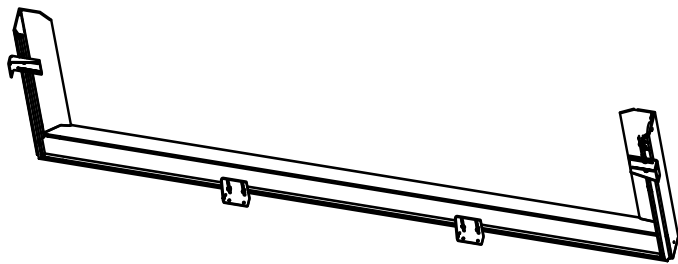

Screen Material
Leave in tube

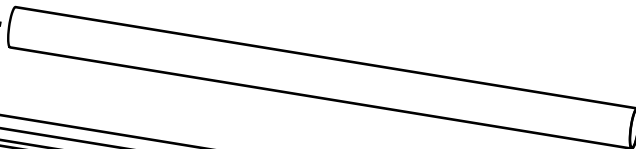

Left Frame Assembly

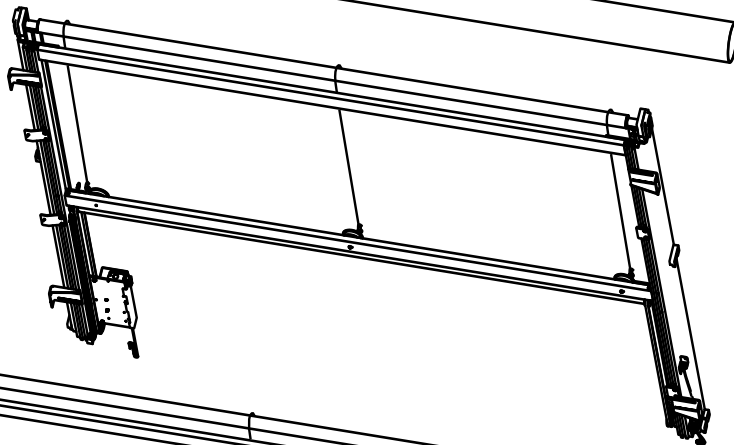

Right Frame Assembly

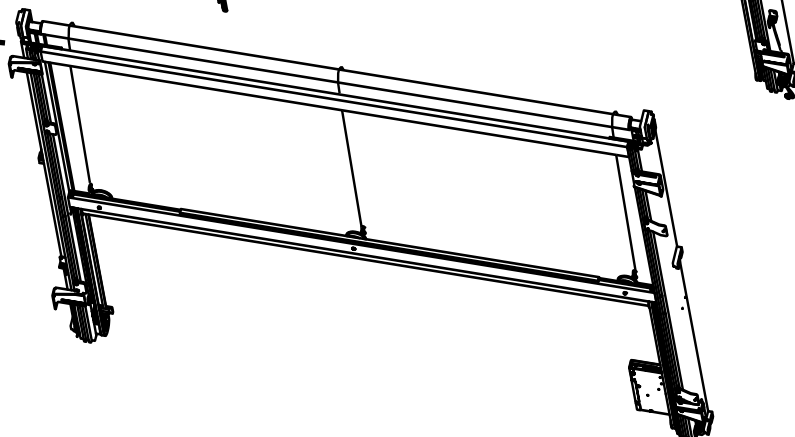

PREPARE THE INSTALLATION LOCATION

TRANSFORMER



2+

INSTALLATION REQUIRES TWO OR MORE PEOPLE. PLEASE USE SAFE LIFTING AND RIGGING TECHNIQUES.



THE RESTING POSITION FOR THE SCREEN IS IN THE FULLY OPEN 2.4:1 POSITION. THE SCREEN WILL RETURN TO THE THIS POSITION IF IT DOES NOT RECIEVE A SIGNAL FOR 8 HOURS OR WHEN THE ON/OFF TRIGGER GOES TO A LOW VOLTAGE. PLAN THE INSTALLATION LOCATION ACCORDINGLY.

1

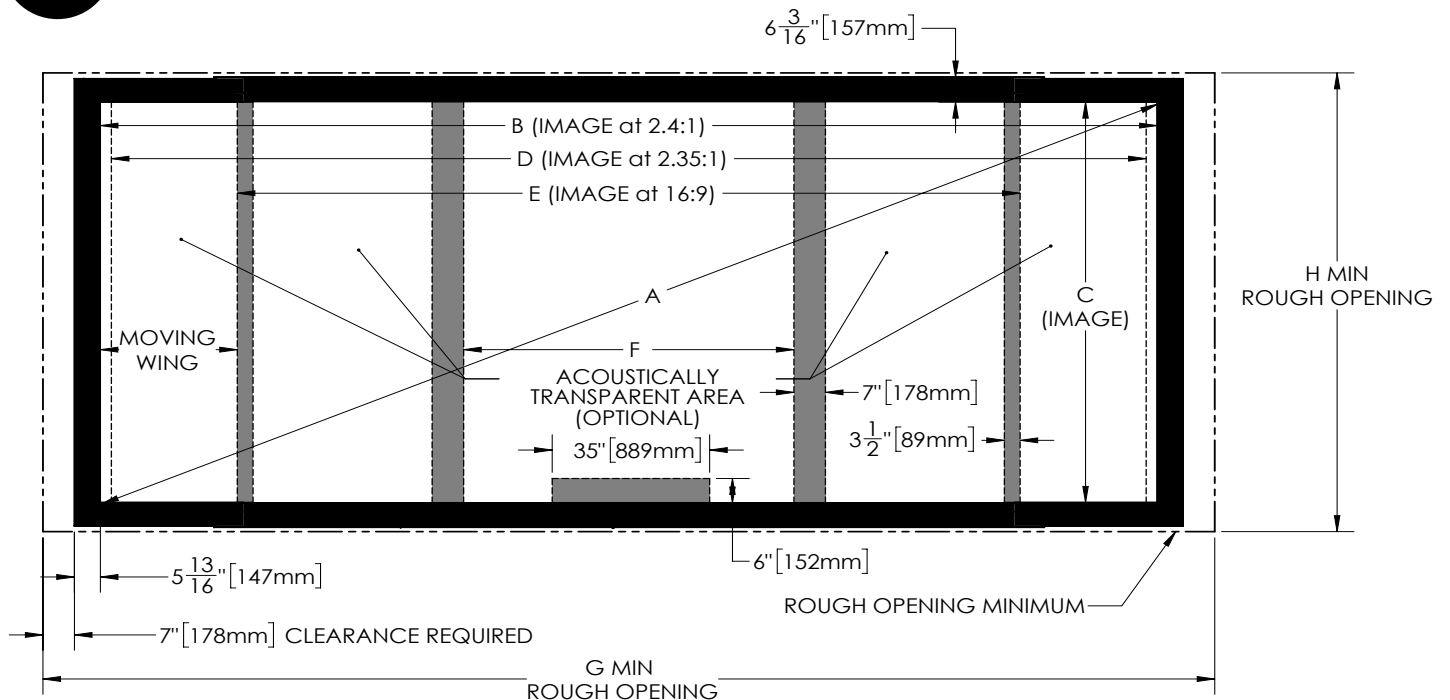

Refer to the signed approval drawing submitted with the order to make sure the installation location has the required minimum rough opening dimensions available.

PREPARE THE INSTALLATION LOCATION

TRANSFORMER



SCREEN WEIGHS UP TO 500 LBS. MAKE SURE TO USE APPROPRIATE ANCHORS TO SAFELY SECURE WEIGHT OF SCREEN.

2

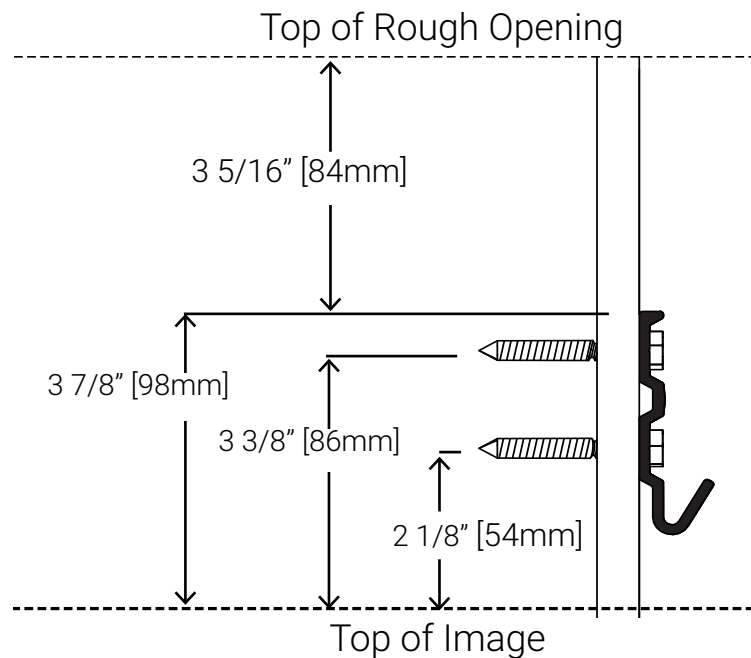
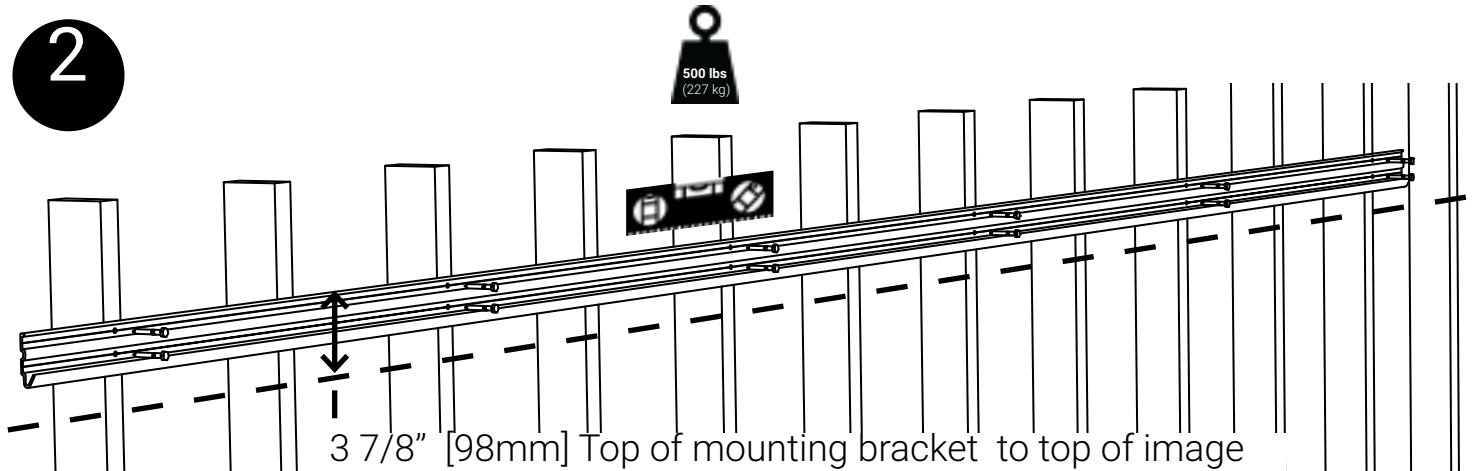

Center the mounting bracket about the desired viewing area. Mark stud locations on the mounting bracket. Then using the notch in the bracket for vertical positioning and marked locations for horizontal positioning; drill clearance holes in the mounting bracket. Make sure the bracket is level and at the correct height; then secure the bracket to structural supports as shown above.

1

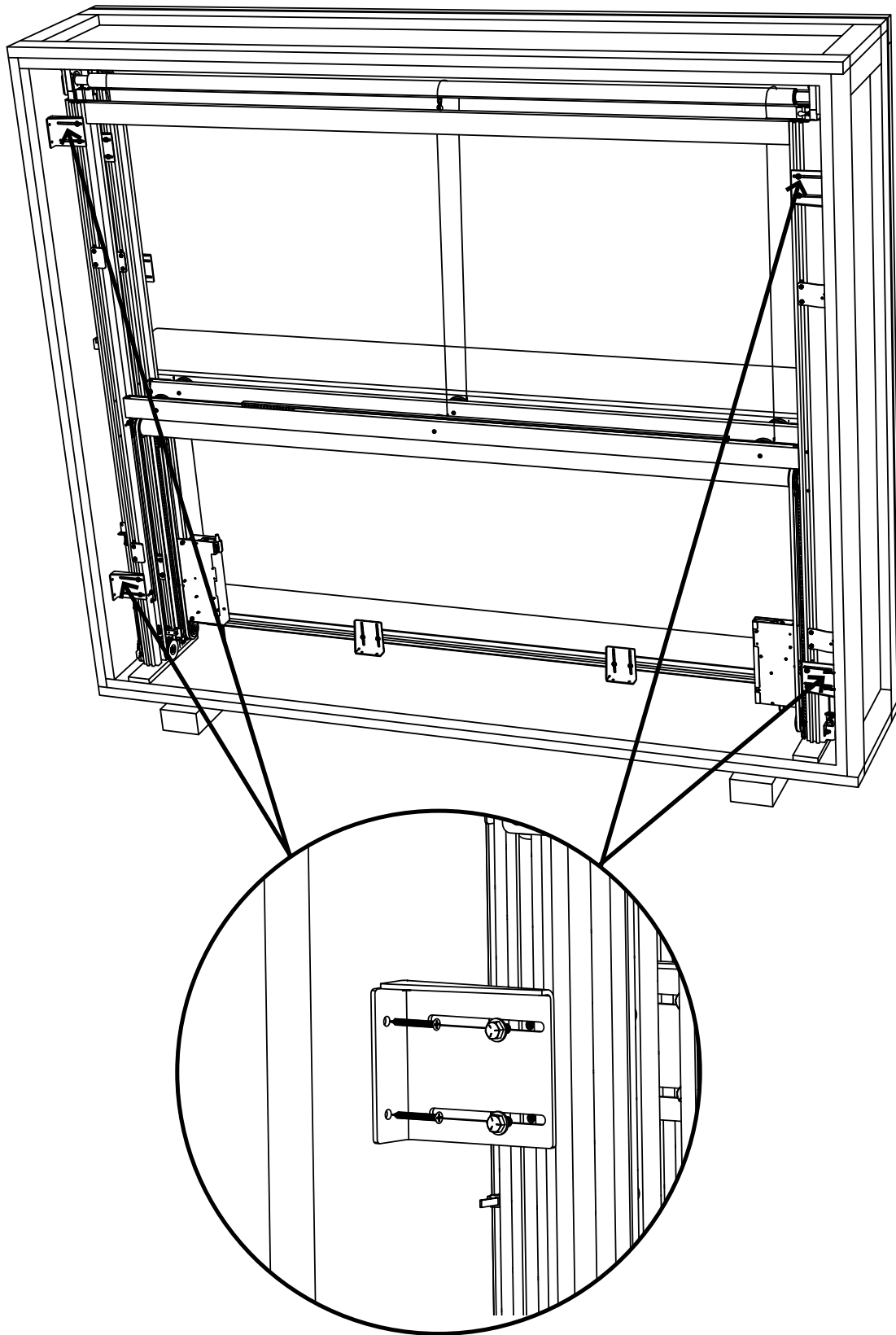

Remove the shipping brackets from the crate and the first frame half.



2+

INSTALLATION REQUIRES TWO OR MORE PEOPLE. PLEASE USE SAFE LIFTING AND RIGGING TECHNIQUES.

2

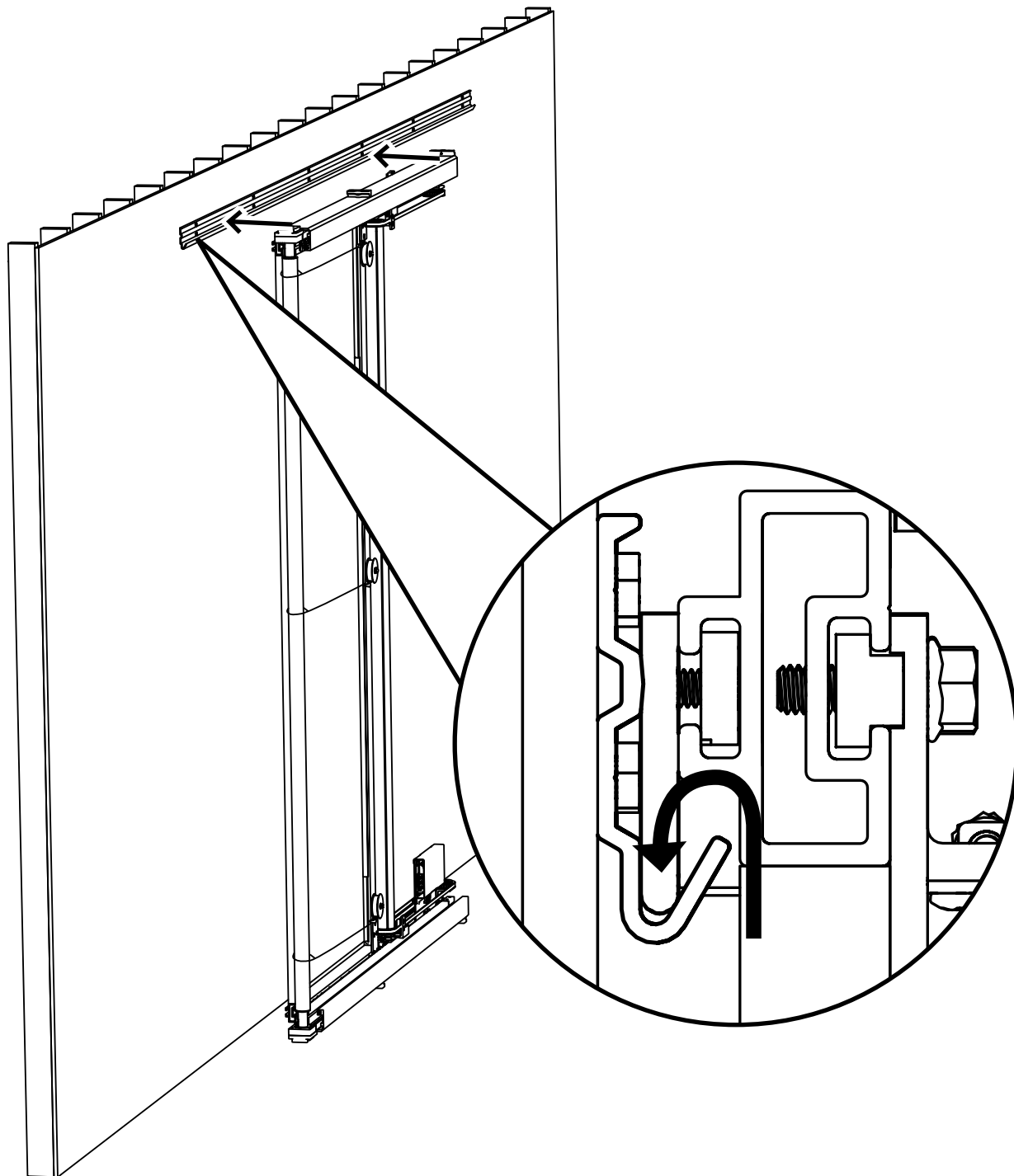

Lift left frame half up onto the left end of the long wall bracket and make sure the brackets on the frame are in the lip on the wall bracket as shown.



2+

INSTALLATION REQUIRES TWO OR MORE PEOPLE. PLEASE USE SAFE LIFTING AND RIGGING TECHNIQUES.

3

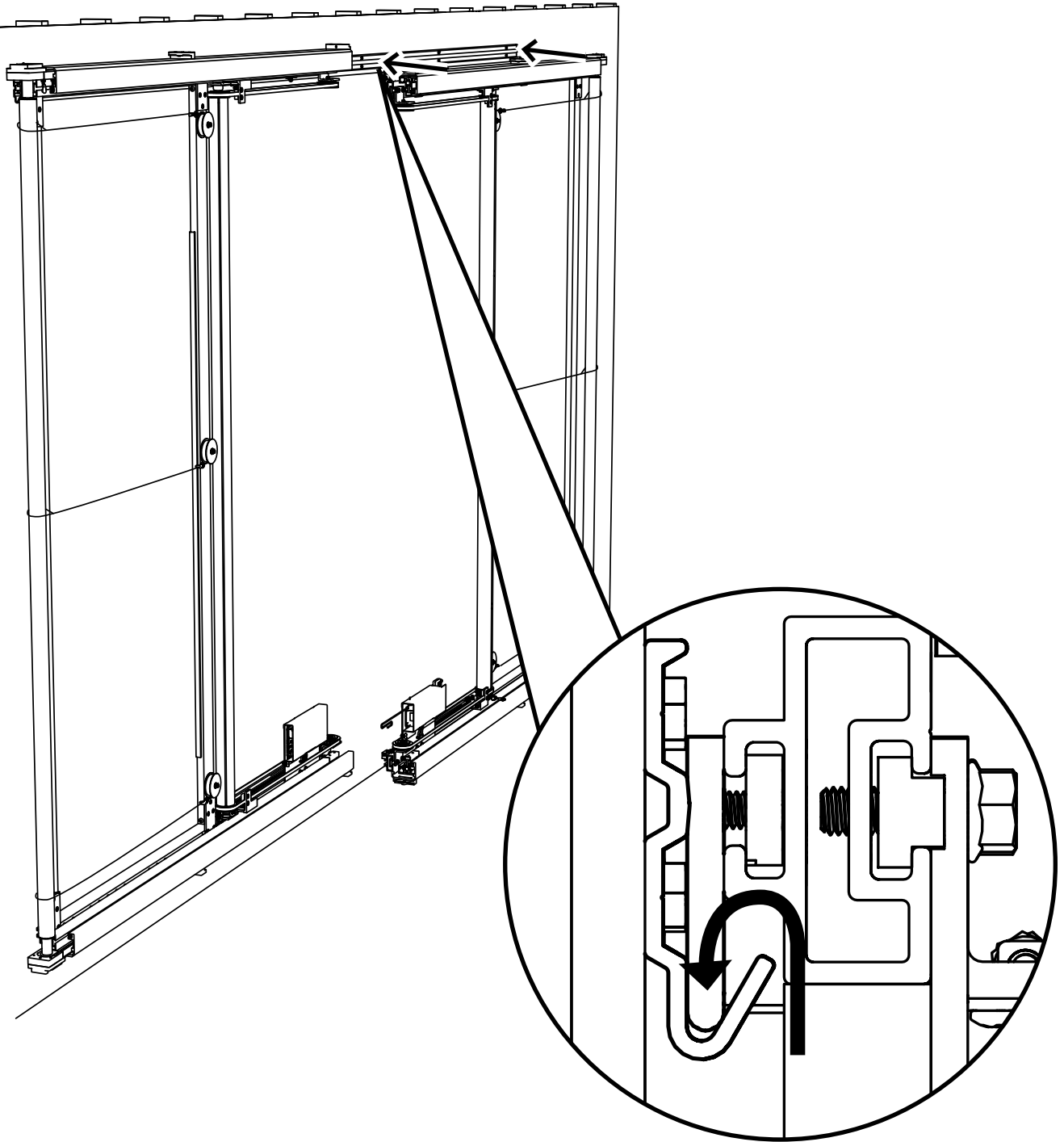

Remove the right frame from the crate. Then lift up onto the right end of the long wall bracket and make sure the brackets on the frame are in the lip on the wall bracket as shown.

3

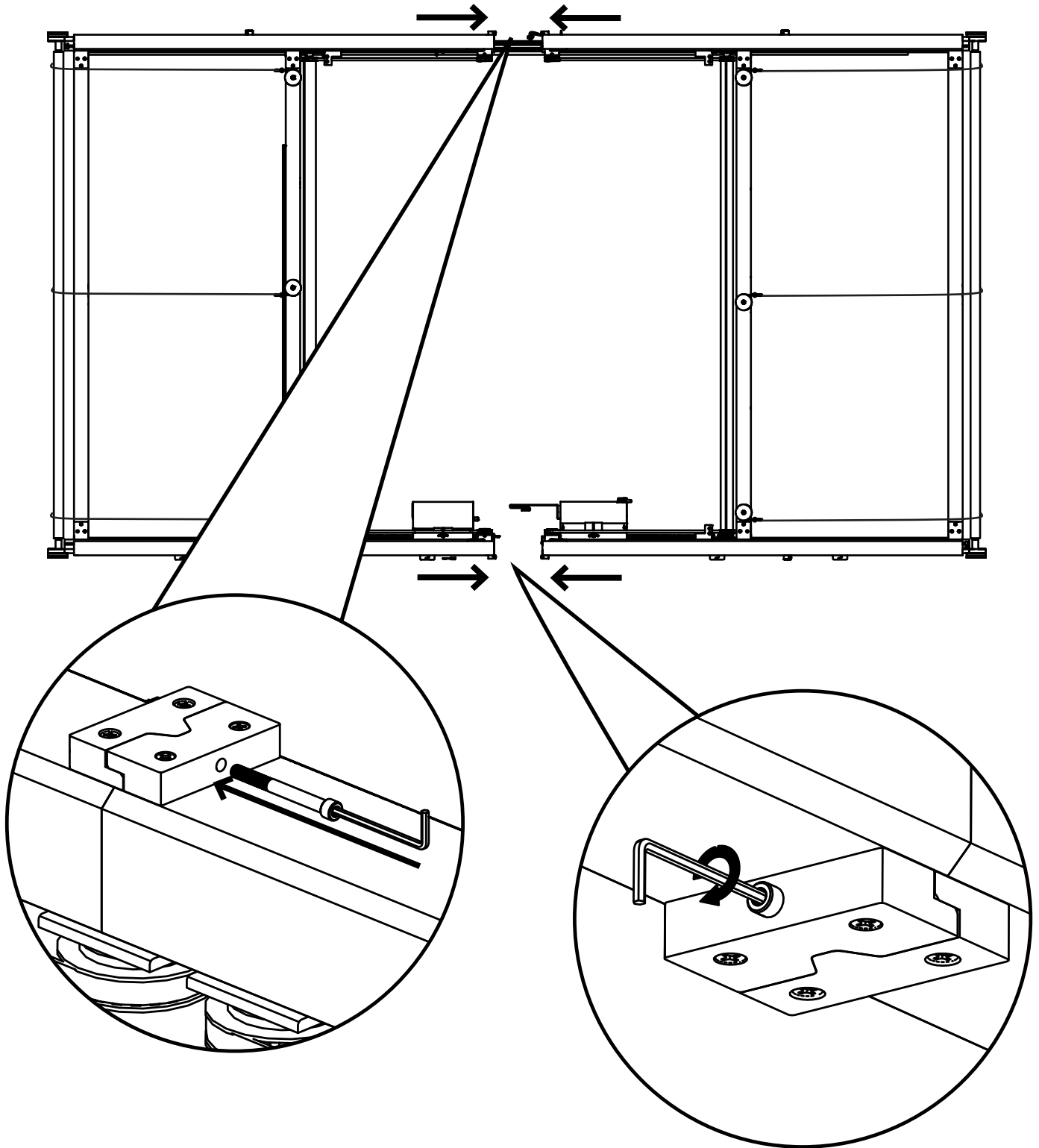

Push the frame halves together then secure with the 1/4-20 x 2 1/2" Screws.

4

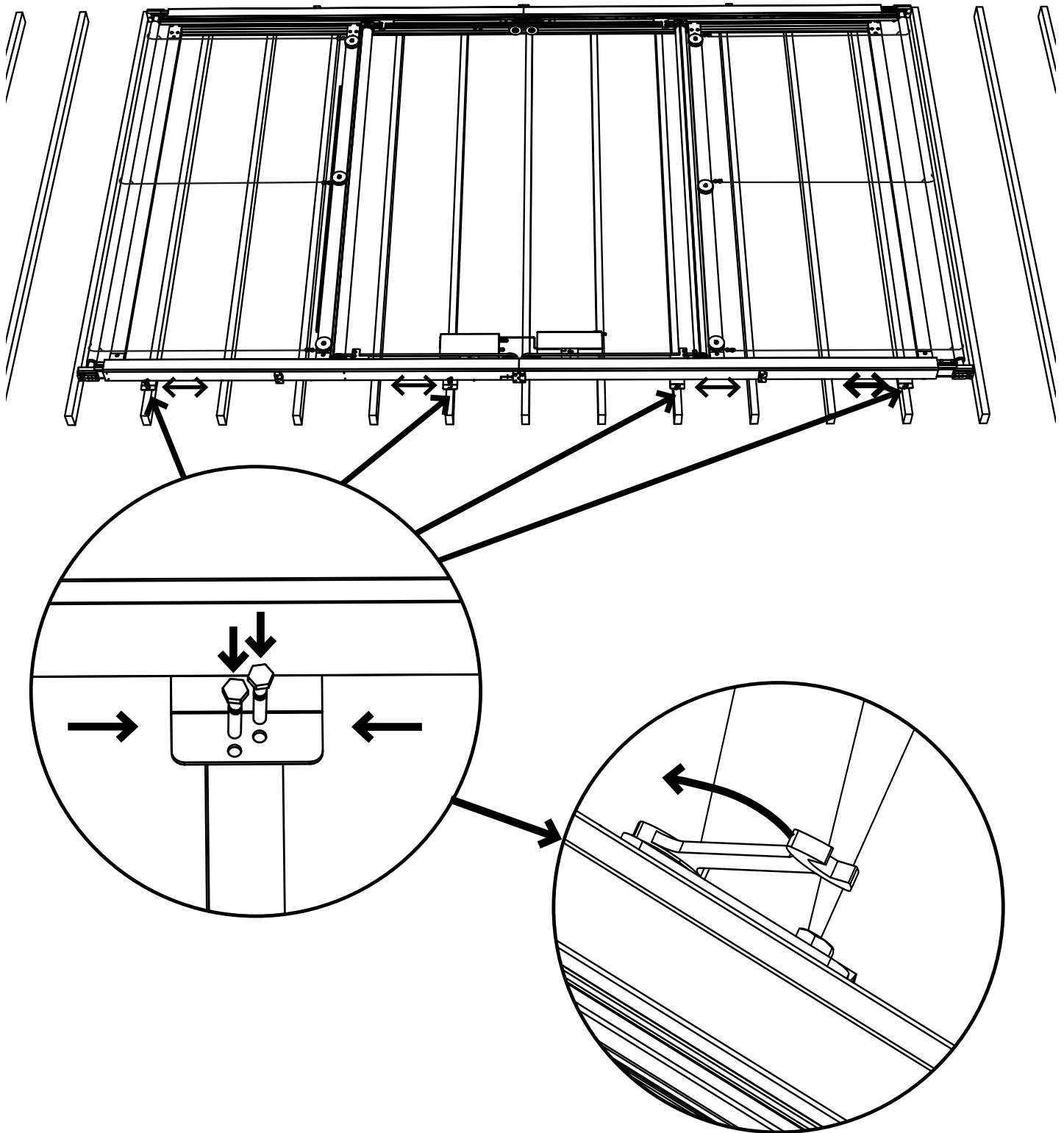

Slide the lower mounting brackets left or right such that the holes align with a stud or structural support. Then secure to the stud with appropriate fasteners. Then tighten the screws on the back of the lower mounting brackets to lock in place.

CONNECT THE POWER AND CONTROL WIRING TRANSFORMER

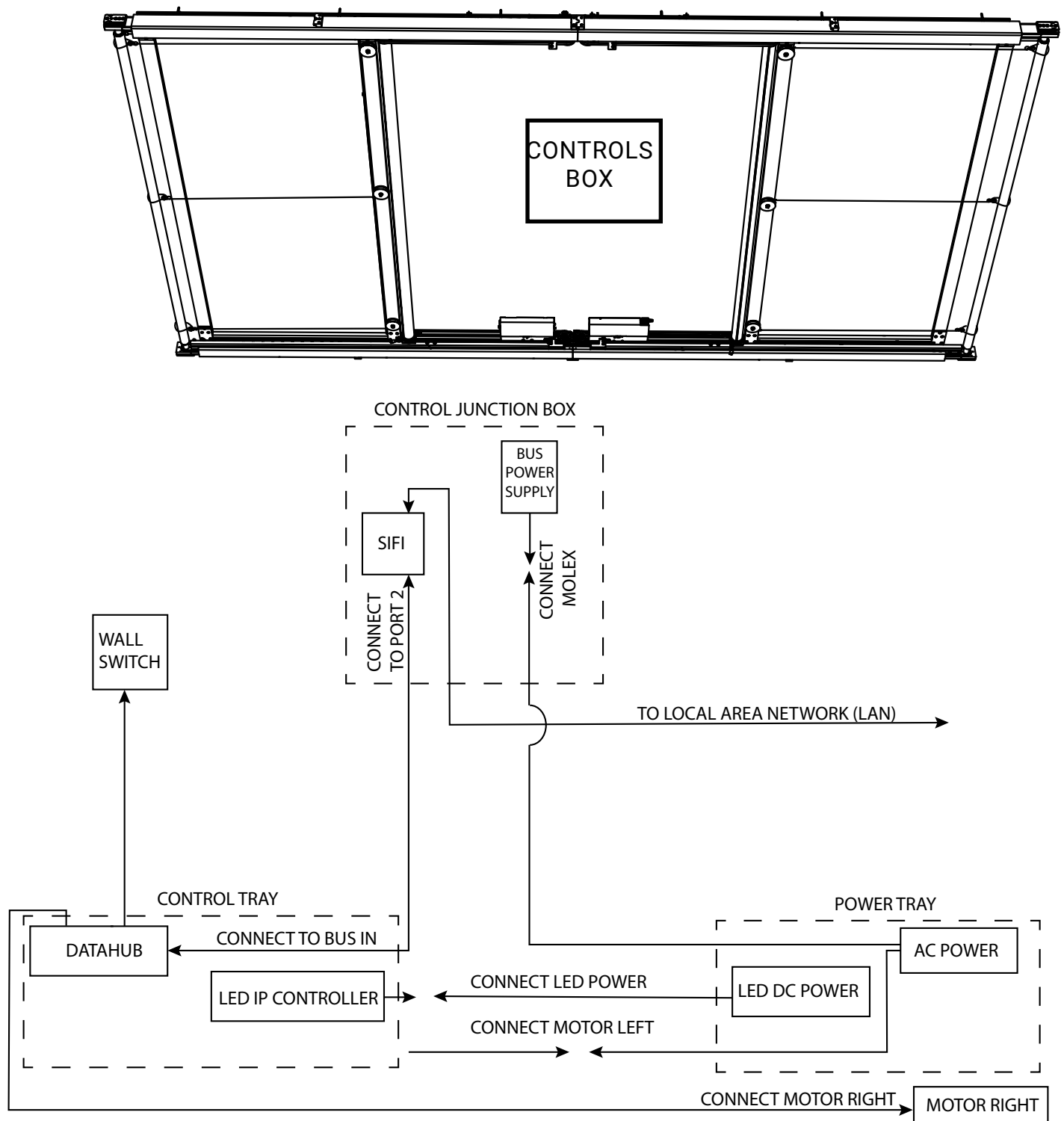

Mount the controller junction box to the wall in a convenient location out. Then make all the connections as required in the box diagram above.

CONNECT THE LED WIRING

TRANSFORMER

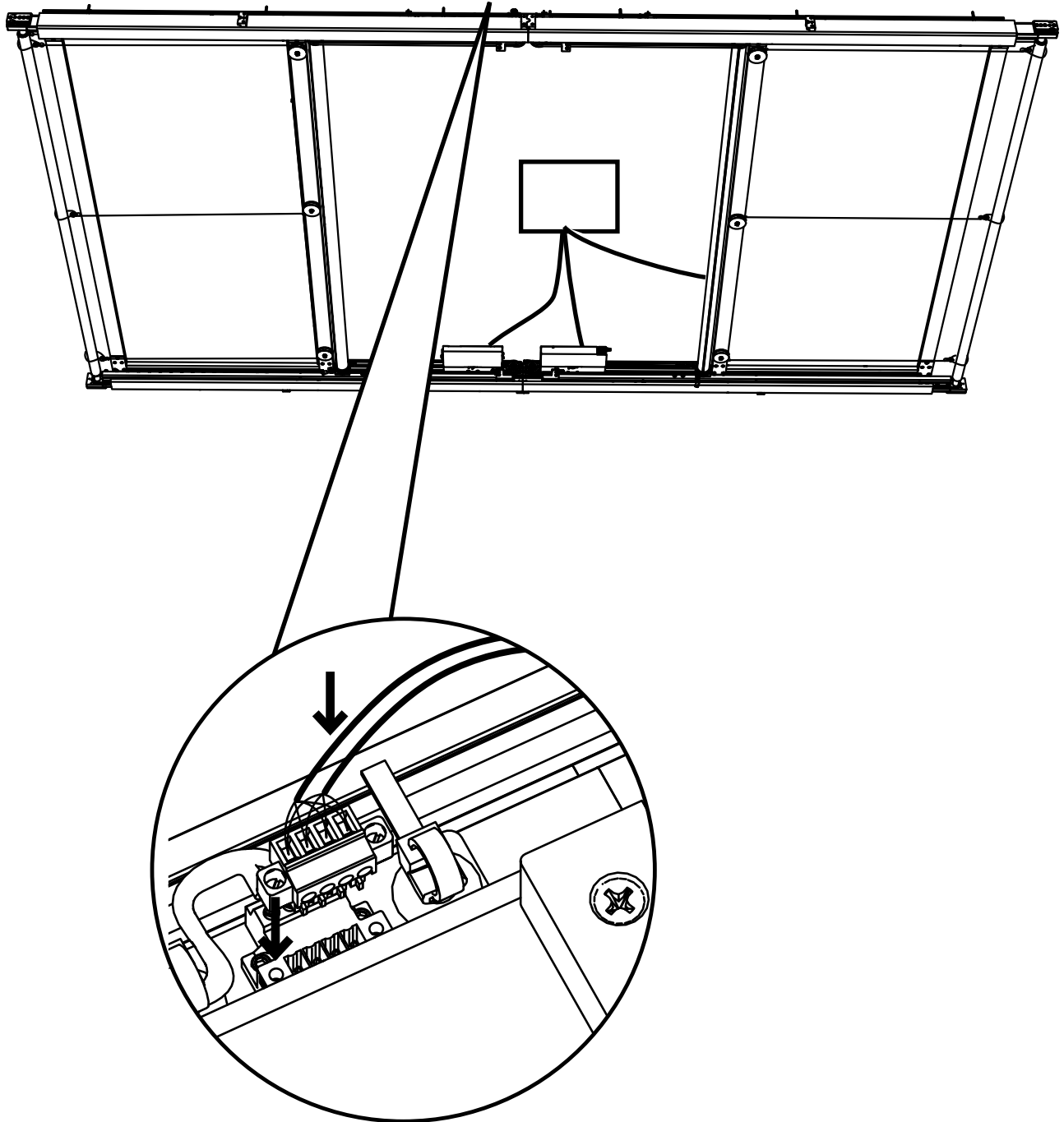

Connect the left side LED
wiring to the right side LED
wiring.



TO BE INSTALLED AND/OR USED IN ACCORDANCE WITH THE APPROPRIATE ELECTRICAL CODES AND REGULATIONS BY A LICENSED ELECTRICAL PROFESSIONAL. DO NOT CONNECT POWER WITH THE CIRCUIT BREAKER ON.

1

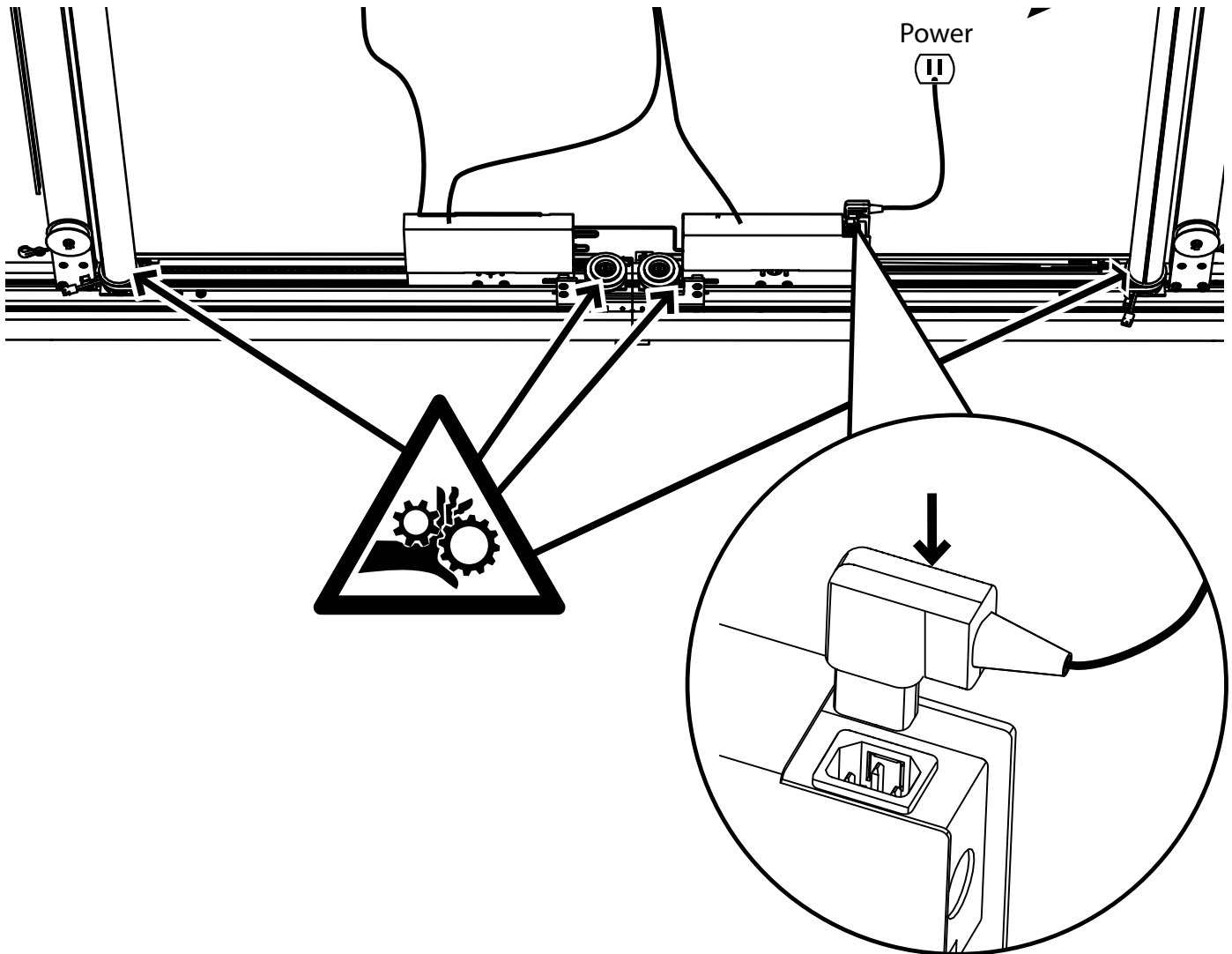

Once controls have been connected; make sure that all wires are clear of the belt area. Zip ties have been provided to secure the cables going to the controls junction box. Then connect the IEC power cord to the right side electronics tray.



MAKE SURE THAT ALL BODY PARTS, TOOLS, AND WIRES ARE CLEAR OF ALL MOVING PARTS.

2

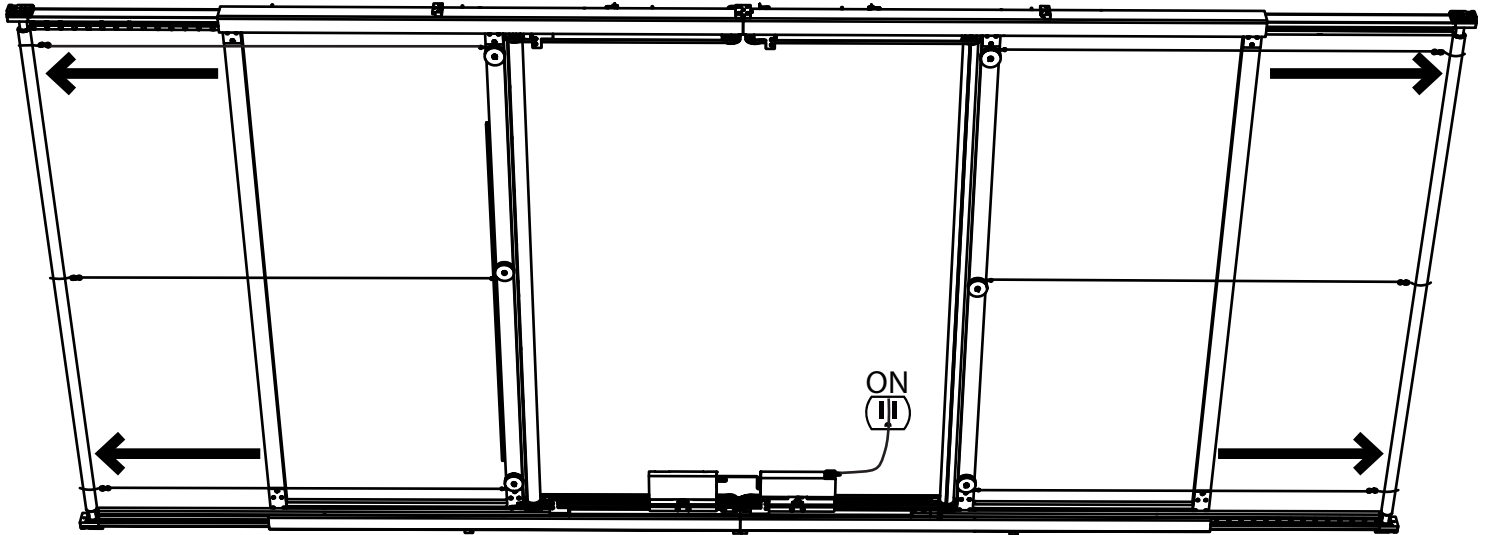

Connect power to the circuit and wall switch. Press the 2.40:1 button on the wall switch to open the screen to it's fully open position. The wall switch is the easiest most simple way to control the screen during setup and installation. Controls integration is addressed later on.

All Transformer screens are fully configured from the factory. This means that the motors and keypad are already programmed and ready for operation. The motors are programmed into a single group so that they always operate simultaneously. When integrating Transformer into a home automation system, always control the motor group rather than the individual motors.

The included Decoflex SDN wall switch is programmed to control the screen out of the box. Simply press the aspect ratio button that you want to go to and the will move to that aspect ratio.

To integrate controls into your control system you must first connect the SIFI to your network or control system via a standard CAT 5 Cable.

For detailed information about how to integrate the SI.FI into your specific control system, please refer to the technotes available on the Info Hub at screeninnovations.com

Depending on the specific third-party control system being used, operating Transformer to one of the intermediate aspect ratios (2.35:1 or 1.85:1) can be done one of three ways:

- 1. Operate the screen to an Intermediate position (IP), such as “IP 1” via SI.FI
- 2. Operate the screen to the corresponding percentage of the desired intermediate position via SI.FI
- 3. Operate the screen to the desired aspect ratio via the dry contact inputs on the keypad

Refer to the table below for more detail

| Aspect Ratio | Position | Percentage |
|--------------|-------------------------|------------|
| 2.40: 1 | Up Limit | 100 |
| 2.35: 1 | Intermediate Position 1 | 92 |
| 1.85: 1 | Intermediate Position 2 | 12 |
| 16:9 | Down Limit | 0 |



SPRING CABLES ARE UNDER TENSION. DO NOT LET GO OF HOOK UNTILL IT IS ATTACHED TO THE BAR IN THE SCREEN MATERIAL. IF SPRING CABLE BECOMES UNRAVELED AND SPRING TENSION IS LOST THEN PLEASE CONTACT SI AT 512-832-6939 FOR ASSISTANCE.



WEAR GLOVES TO PREVENT DAMAGING THE SCREEN MATERIAL



NOTE: TOP OF SCREEN IS THE SIDE WITH A SNAP POST ATTACHED TO THE BAR.

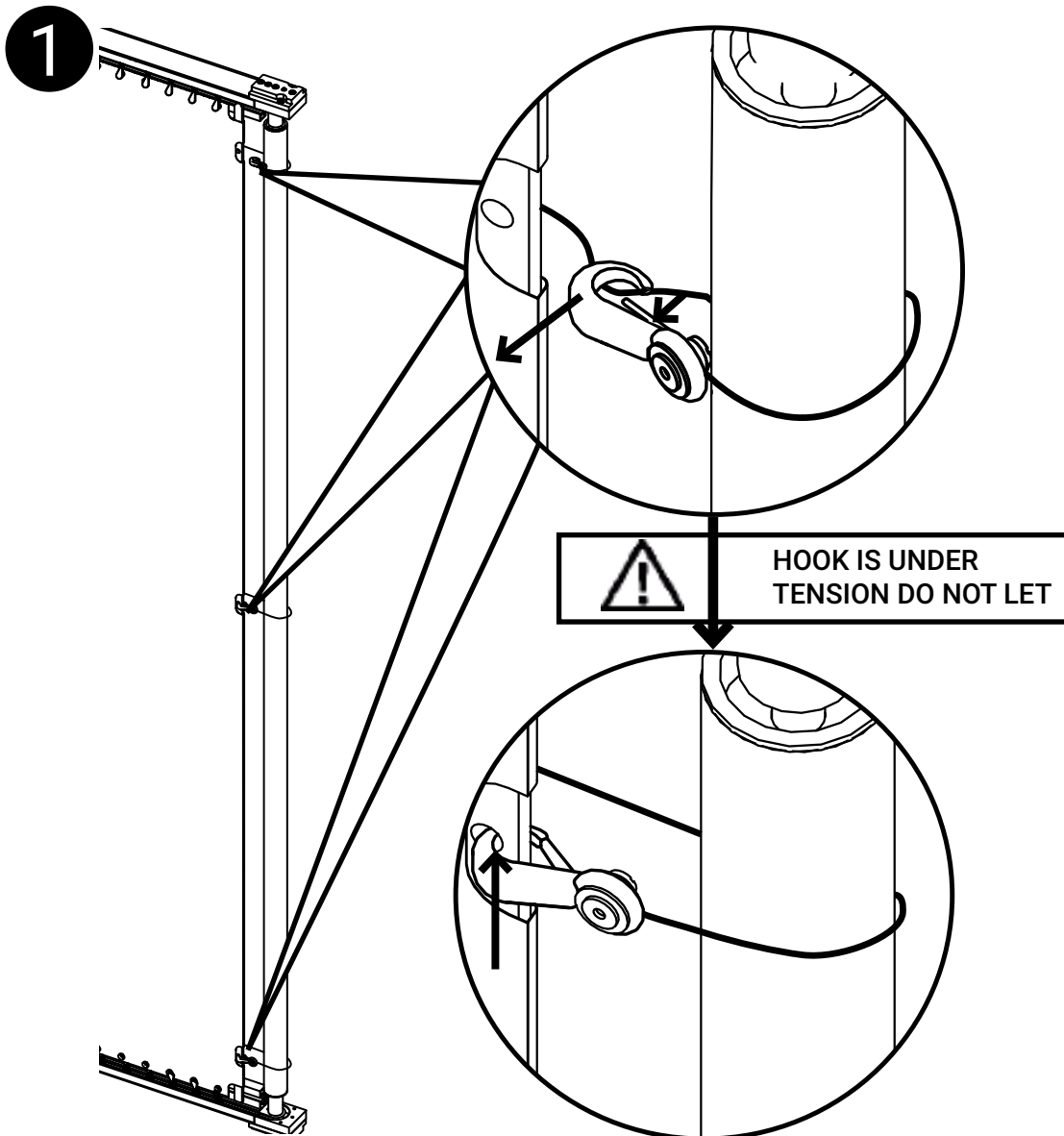

Unclip the hook from spring cable wrapped around the tube being carefull to hold on to the hook. Then hook into the bar in the screen material. DO NOT let go of the hook untill secured to the screen material bar. Once all 3 hooks are attached you can let the springs gently pull the screen marterial around the back of the roller.

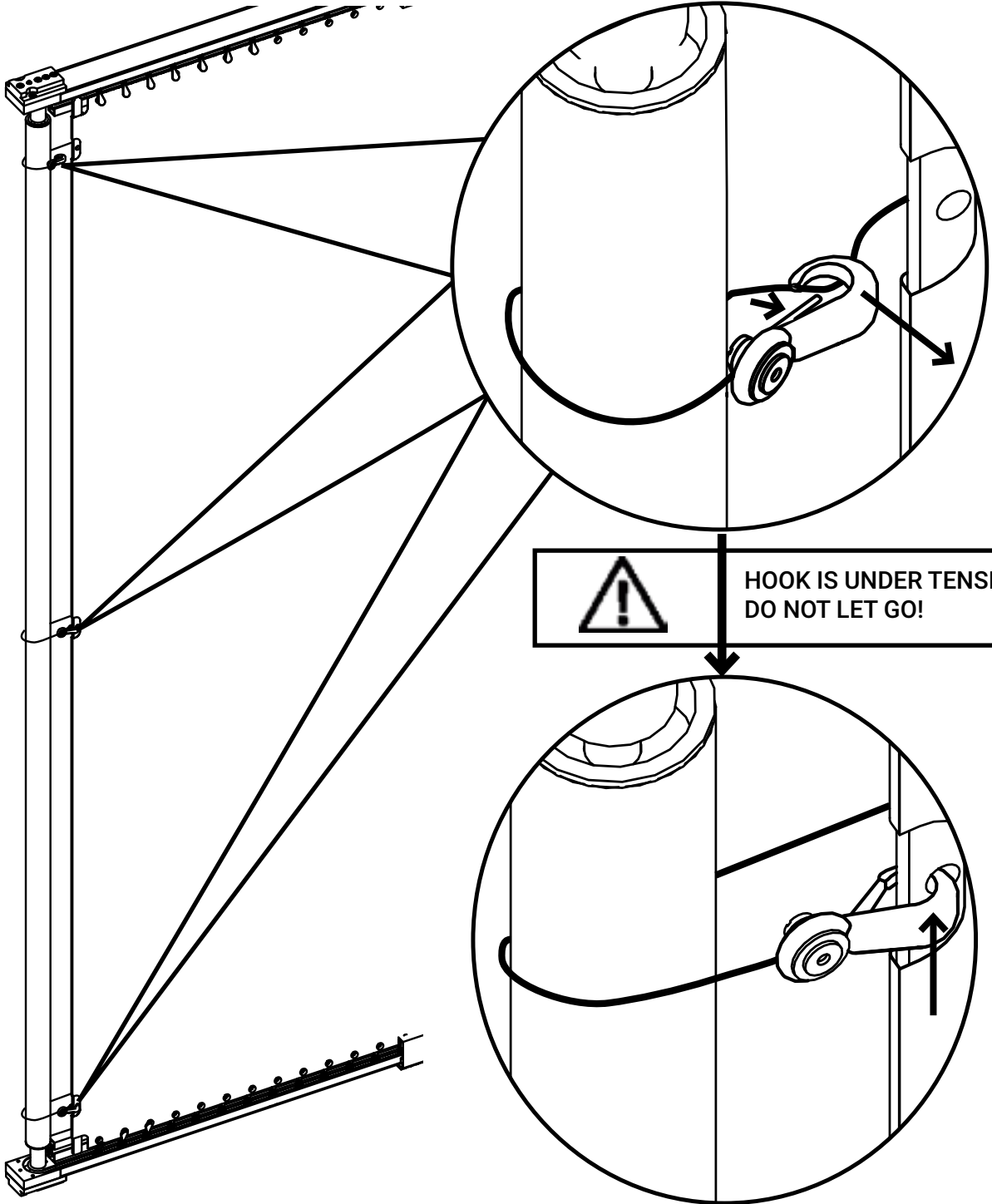

SPRING CABLES ARE UNDER TENSION. DO NOT LET GO OF HOOK UNTILL IT IS ATTACHED TO THE BAR IN THE SCREEN MATERIAL. IF SPRING CABLE BECOMES UNRAVELED AND SPRING TENSION IS LOST THEN PLEASE CONTACT SI AT 512-832-6939 FOR ASSISTANCE.

1

Unclip the hook from spring cable wrapped around the tube being carefull to hold on to the hook. Then hook into the bar in the screen material. DO NOT let go of hook untill secured to the screen material bar. Once all 3 hooks are attached you can let the springs gently pull the screen marterial around the back of the roller.

2

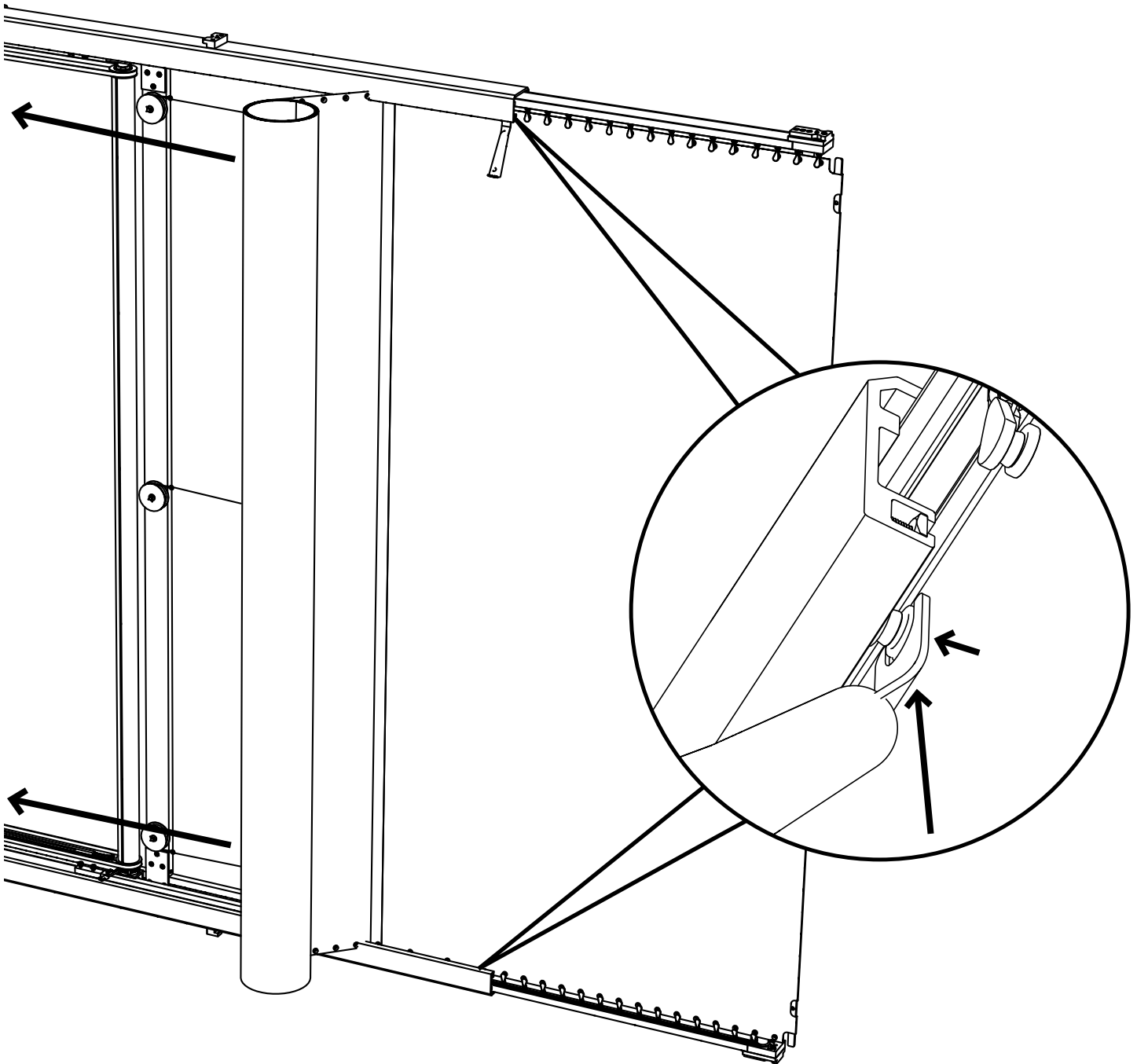

Continue snapping the material into the frame until all the right side moving snaps are attached to the screen material. Then use the top snapper to attach the screen material to the first fixed snaps in the main frame piece.

3

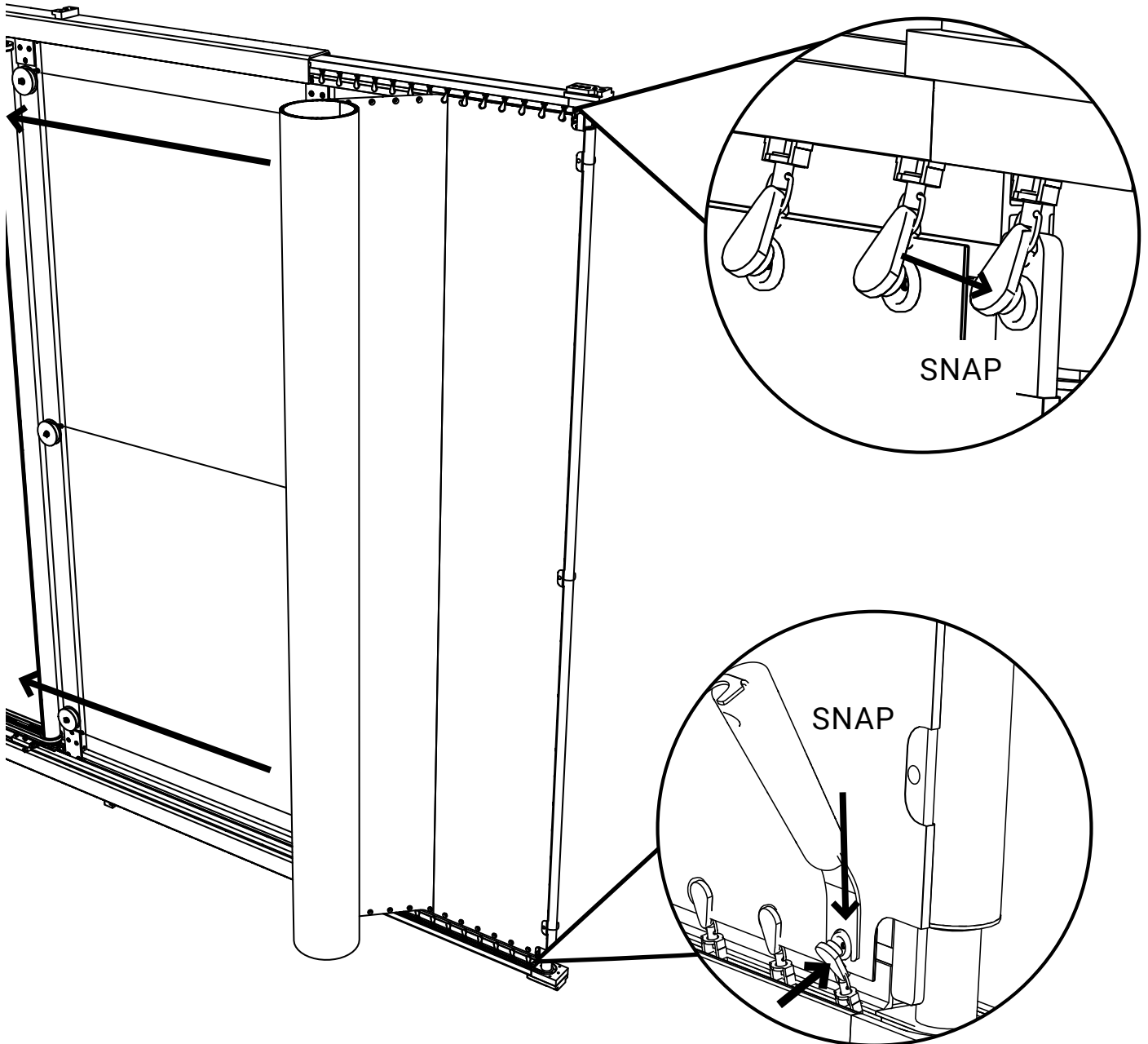

Remove the screen material from the cardboard tube. Remove the tape securing the snaps to the ends of the frame. Then snap into the moving snaps located on the far right side of the screen assembly working left. One installer should be available to hold the rolled up screen material upright and unroll as another installer snaps the screen into the frame. Use the Top-Snapper to easily pull the screen material to the snap.

4

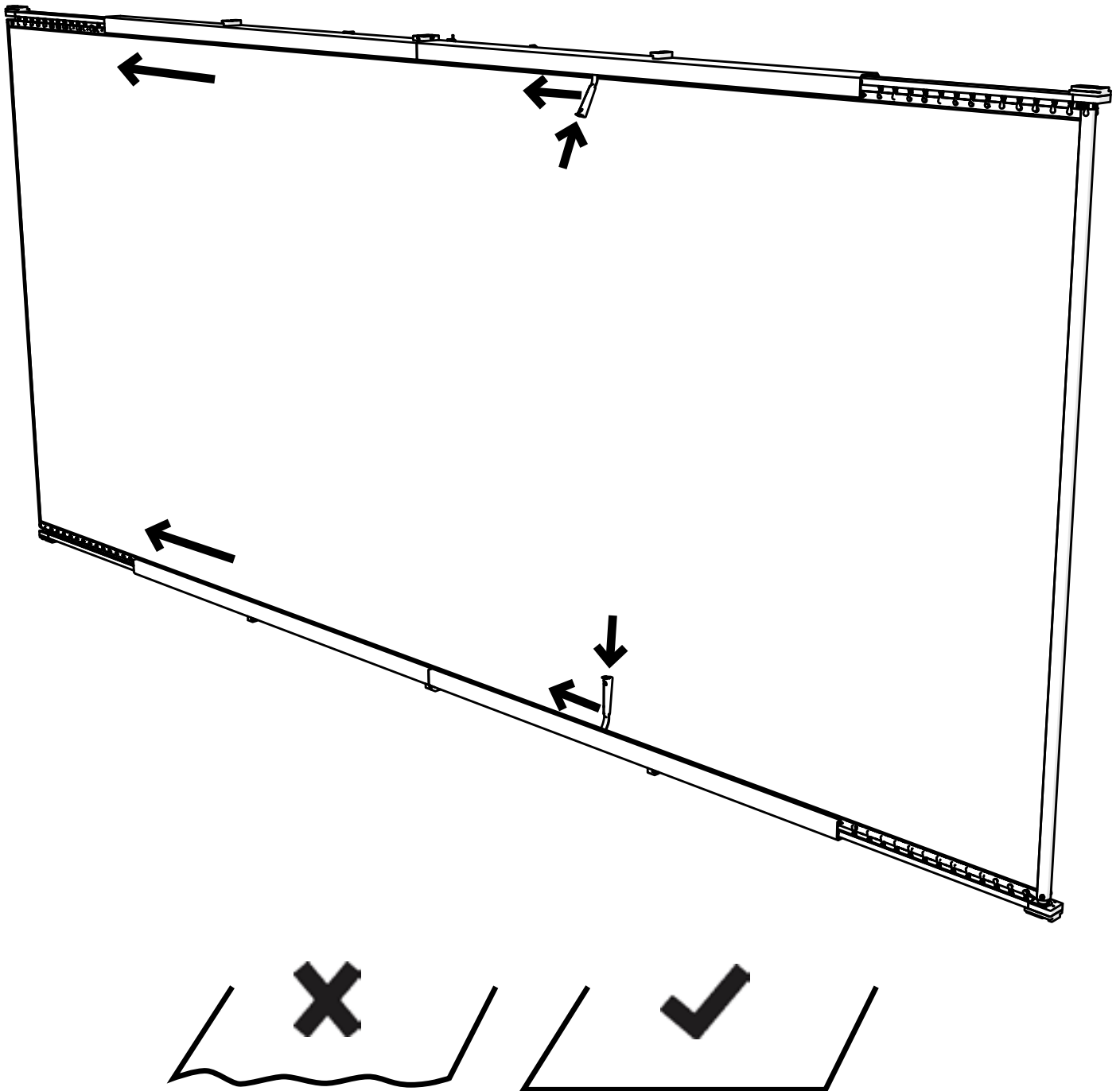

Continue attaching the screen material to the frame working to the opposite end of the frame. When snapping into the fixed snaps make sure to put enough horizontal tension between the new snap and the previous snap to make the material lay flat. Once all snaps have been attached go back and adjust the snaps in the fixed frame portion to make the screen lies flat. Remove the cardboard tube from the end of the screen material

1

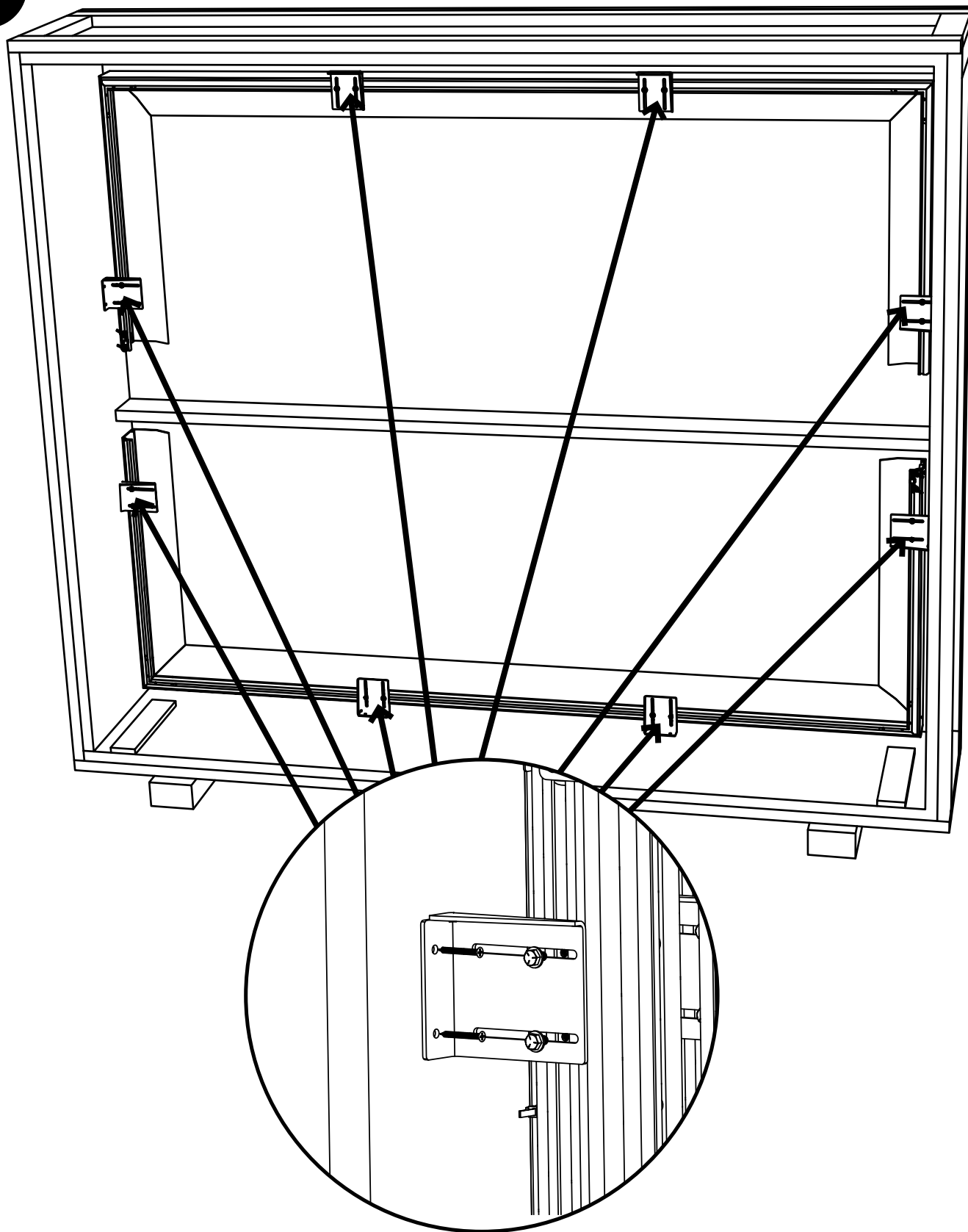

Remove the wing trim from the crate by removing the shipping brackets from the crate and then removing the shipping brackets from the wing trim assemblies.

ATTACH THE TRIM

TRANSFORMER

2

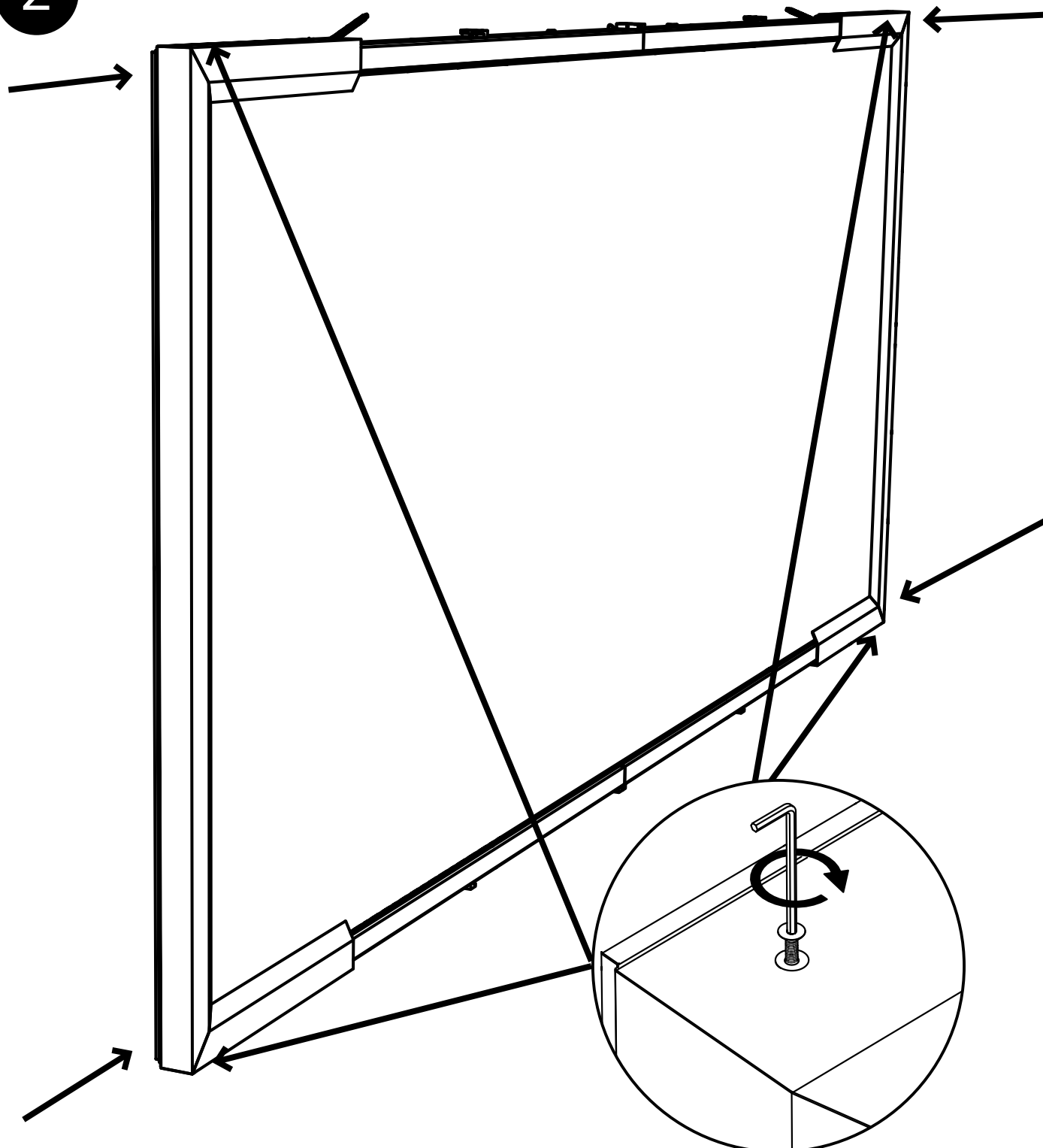

NOTE: The trim is put on to the frame such that the coiled cable for the lights is at the top.

Slide the wing trim pieces on to the main screen assembly until it hits the bumper on the end of the frame. Then align the hole in the wing trim with the hole in the frame and secure with the 10-32 flat head screw. Do NOT overtighten the screw.

3

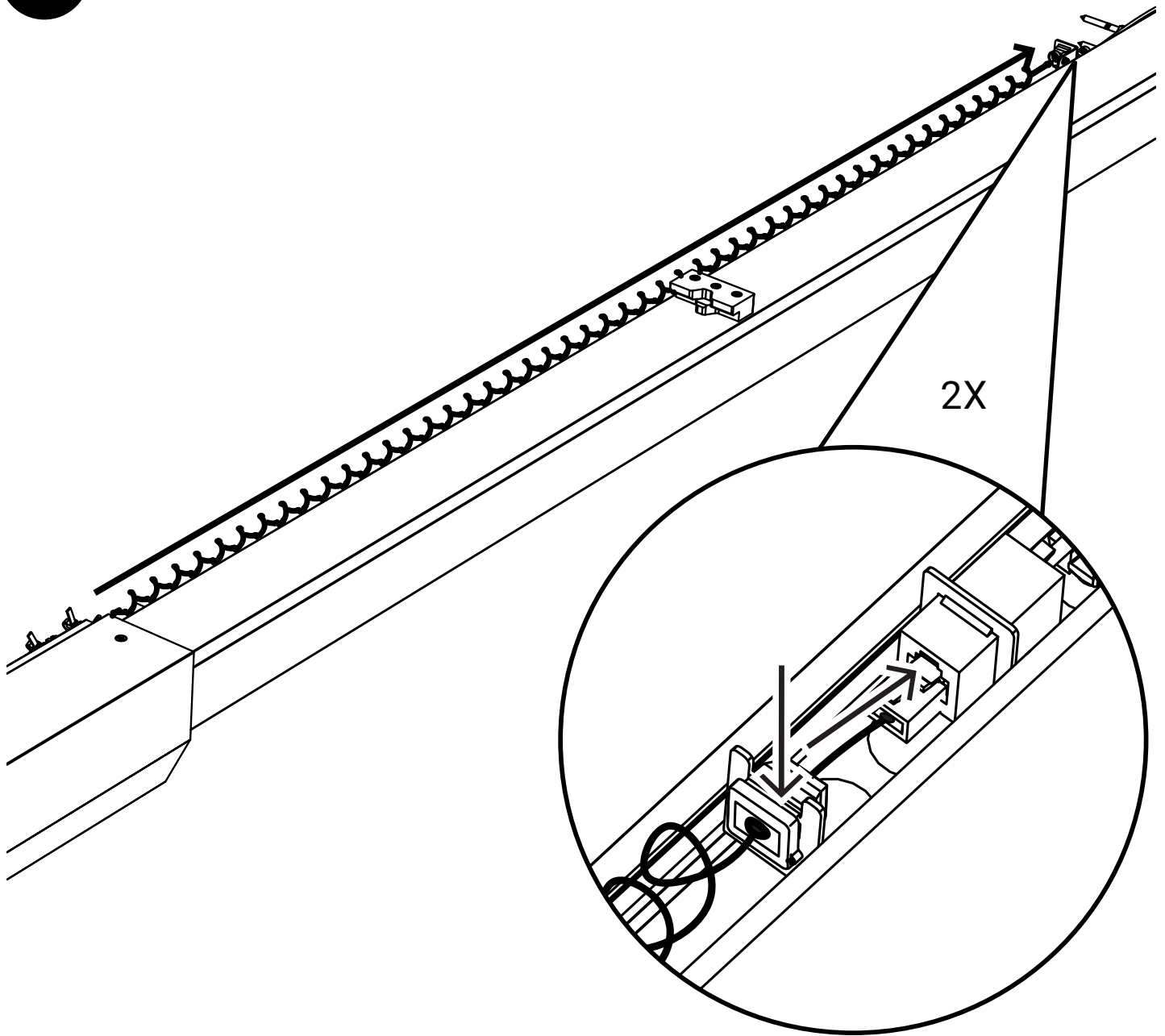

Stretch the coiled cable on the top of wing trim pieces to the port on the frame. Slide the black strain relief in into the slot and then plug the cable into the port.

4

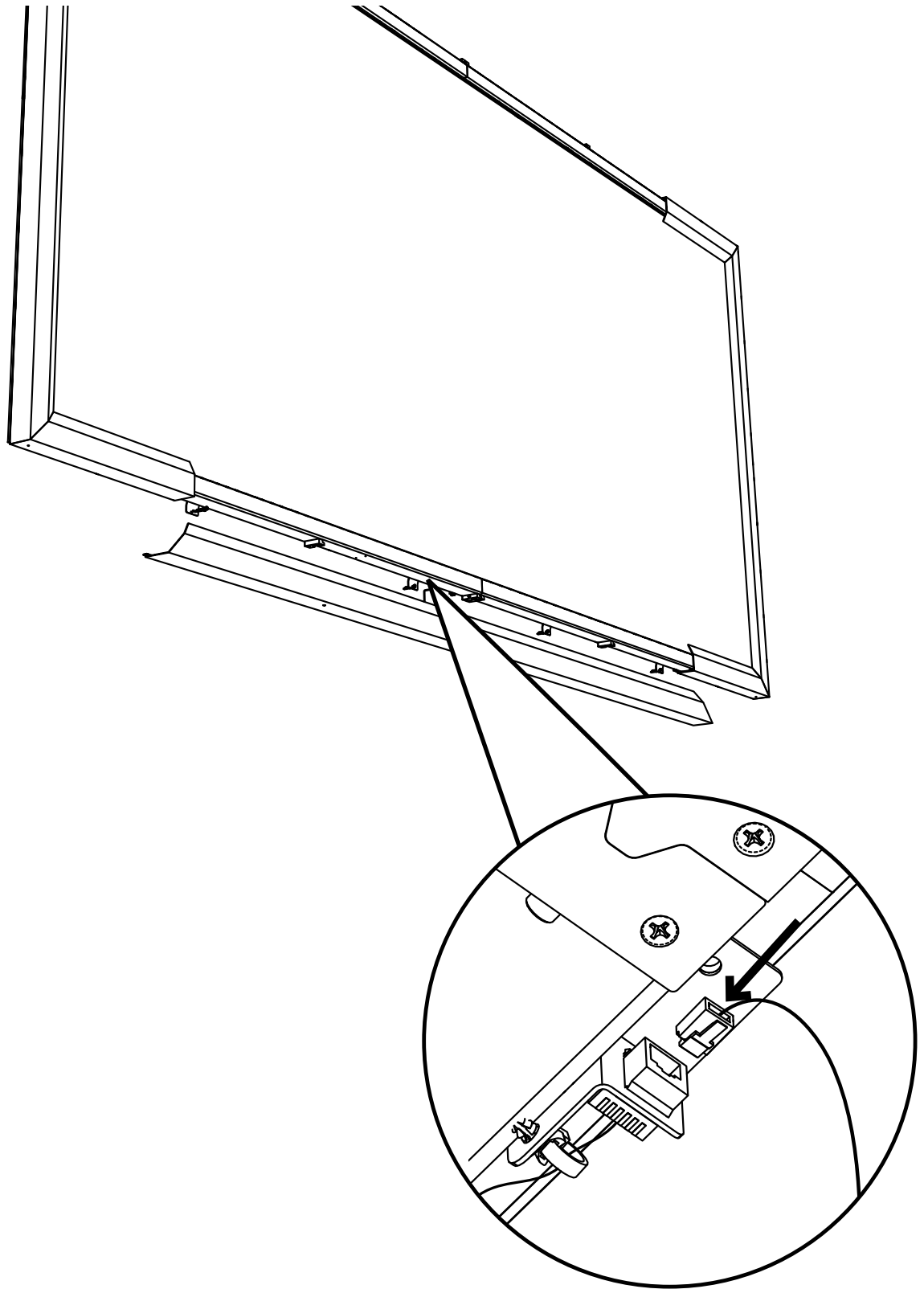

NOTE: The bottom trim piece is the piece with the IR eye dome connected to it.

Place the bottom trim just below the bottom of the screen and lug in the phone jack connected to the LED in to the port mounted to the bottom of the frame.

5

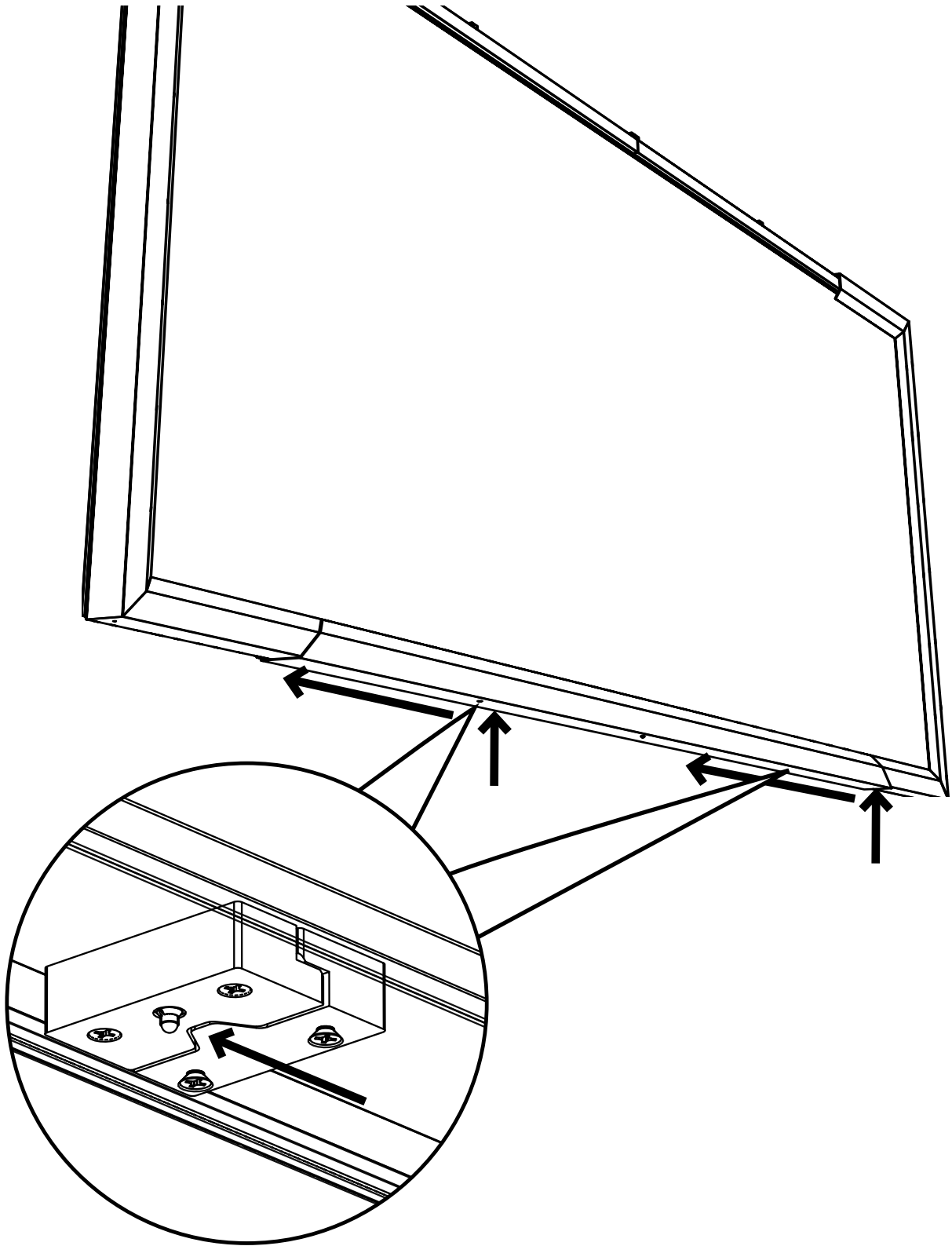

Lift up the trim and slide to the **LEFT** until the blocks line up and the plunger clicks into place to secure the trim. The trim is correctly installed when the trim will no longer slide back to the right.

6

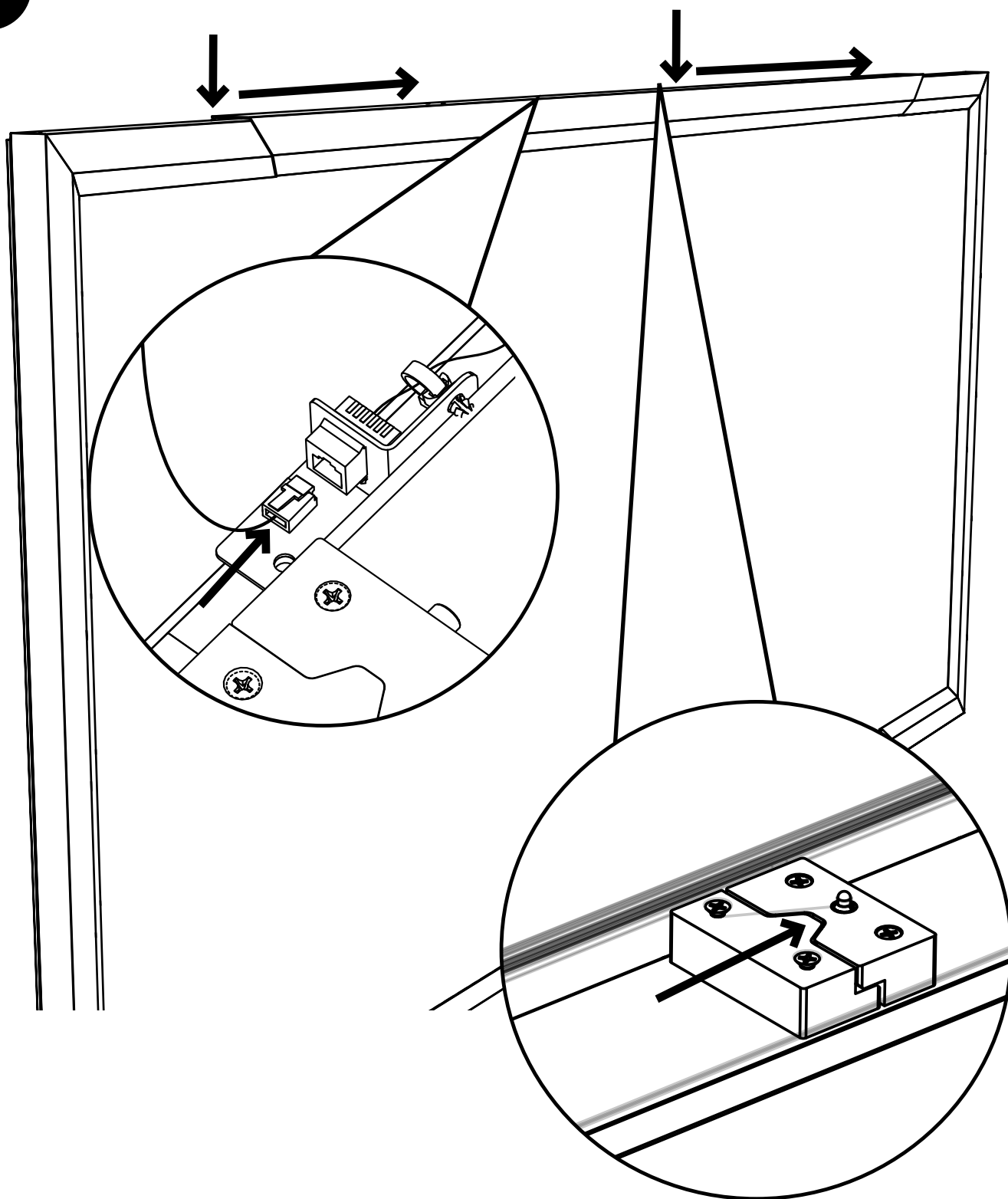

Connect the lights to the port at the top. Then rest the trim on frame and slide to the RIGHT until the blocks line up and the plunger clicks into place to secure the trim. The trim is correctly installed when the trim will no longer slide back to the left.

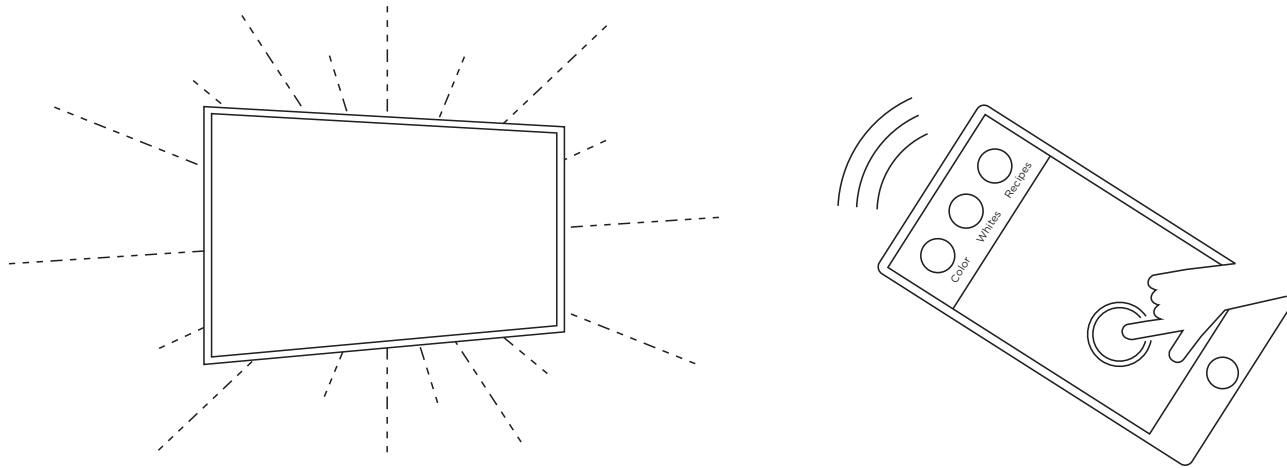

Initial Set up

Before attempting to connect your LED IP to Phillips Hue, ensure that the Hue Bridge is powered on and connected to the local Wi-Fi® network.

1. Begin by connecting the power supply to an electrical outlet. After a few seconds, the LEDs should power on to a white color.
2. Open the Phillips Hue app on your smart device, and navigate to “Light setup” in the **settings tab**.
3. Press the “**plus**” button in the lower right-hand corner, then press “**Search**”.
4. It can take several seconds to connect. Once connected, the LEDs will light green.
5. The LED IP will appear in the Phillips Hue app as “**Extended Color light 1**” and “**Dimmable light 1**”.
Only use “Extended Color Light 1” to control the LED’s. “Dimmable Light 1” should be deleted.
6. After the LED IP is connected, it can be renamed and used like any Hue lamp.

Reset (Required to connect to a different Phillips Hue)

1. Begin with the LED IP powered on
2. Turn off for a minimum of 2 seconds
3. Turn on and wait for LEDs to light
4. Repeat the off/on procedure a total of four times
5. At this point the LEDs will begin blinking for 10 seconds.
6. Once the LEDs stop blinking, repeat the off/on procedure two more times
7. At this point the LED IP will reset. Once complete, the LEDs will light a white color

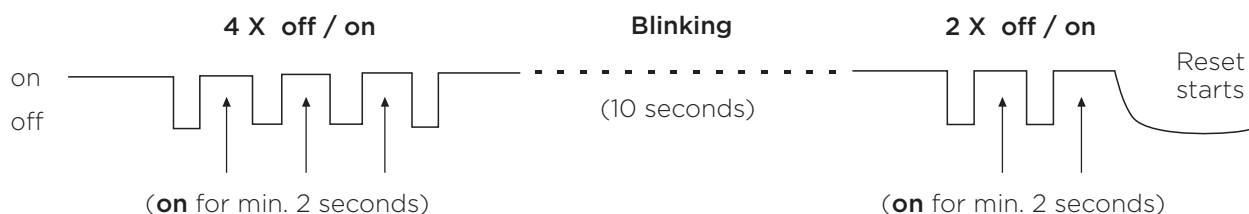

Note: The LED IP can be connected and controlled by only one Phillips Hue Bridge at a time.



NEVER SCRUB, USE SOLVENTS, OR ANY ABRASIVE
SUBSTANCE THAT MIGHT DAMAGE THE MATERIAL.

Slate® & Pure®

Suggested Method:

Microfiber cloth towel
and distilled water
applied with lightly
rubbing the surface until
the spot is removed.

Alternate Method:

Can be cleaned with a
microfiber cloth. Mix a
solution of 1oz simple
green to 20ozs water.
You can lightly rub the
surface until the spot is
removed.

Please allow 10 minutes
of drying time before
retracting motorized
screens.



TRANSFORMER

NOTES:

9715-B Burnet Road Suite 400, Austin, TX 78758

Tel: 512-832-6939 Fax: 512-832-6136

www.screeninnovations.com



TRANSFORMER

NOTES:

9715-B Burnet Road Suite 400, Austin, TX 78758

Tel: 512-832-6939 Fax: 512-832-6136

www.screeninnovations.com



TRANSFORMER

NOTES:

9715-B Burnet Road Suite 400, Austin, TX 78758

Tel: 512-832-6939 Fax: 512-832-6136

www.screeninnovations.com