

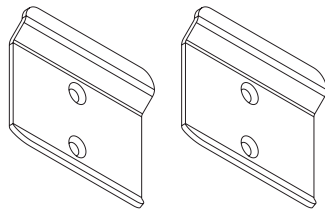

Screen Innovations  
9715-B Burnet Rd, Suite 400 Austin, TX 78758  
512.832.6939  
[www.screeninnovations.com](http://www.screeninnovations.com)

v. 1.3 | 4 October 2019



## **Solo / Pro 2** **Zero Gap Wall Bracket** Installation Instructions



Please use this QR Code to access documents related to product and latest instructions.



Zero Gap Wall  
Brackets

Thank you for purchasing an SI product. If you have any questions or need any assistance with your Solo/Pro 2, we would love to help you.

**Technical Support:** 512.832.6939

**Hours of Support:** 7:30am - 5pm CST

[screeninnovations.com](http://screeninnovations.com)

[support@screeninnovations.com](mailto:support@screeninnovations.com)

## INITIAL CONSIDERATIONS

Plan your installation. Determine the length of your cassette and the centerline of your viewing area to make sure that you can install the brackets 2 - 8 inches from the end of the cassette.

Due to the "Zero Gap" design of the brackets, the wall must be very straight and flat. If it is NOT flat then you will have difficulty engaging the cassette on the brackets and may have to place spacers behind the brackets.

Use the appropriate fasteners. Wood screws are provided for mounting into wood studs only. If another mounting surface is to be used, the installer must provide the appropriate fasteners.

## PARTS IN THE BOX

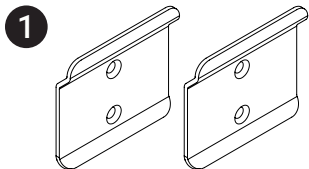

(2) Zero Gap Wall Brackets

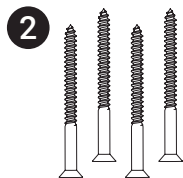

(4) No. 8 Flat-head  
Screws

## INSTALLATION

Proper mounting preparation will ensure a great installation. Mounting brackets must be screwed into structural members of such as ceiling joists. You may use wood screws provided, or other anchors (not provided) capable of carrying the load, that is suitable to the substrate.

**⚠ DO NOT MOUNT TO HOLLOW SHEET ROCK.**

1. The drop is adjustable in the field between 0" and the MAX DROP (12", 24", or 36", **2" for short throw**) ordered for your screen. Use the drawing (refer to pg 5) to specify a bracket vertical position where the bottom of the bracket to the top cassette is 3". Make sure this vertical position will allow you to extend your screen to achieve the desired vertical position of your viewing area.

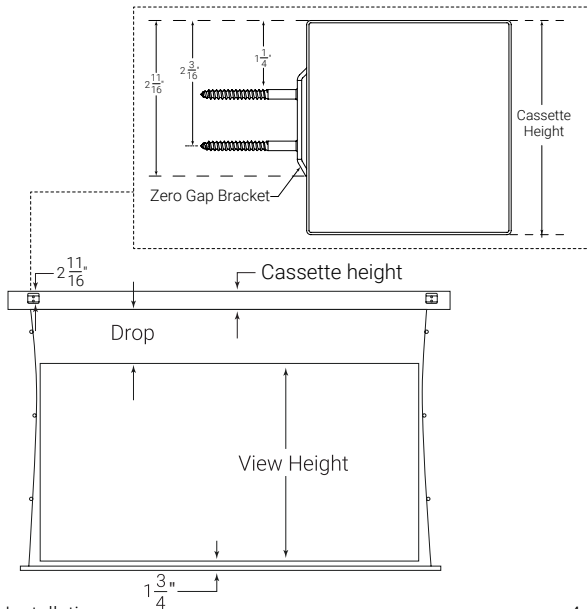

Installation

2. Determine the desired horizontal viewing position centerline of the projected viewing area.
3. The Solo/Pro 2 screen must be installed with the brackets no more than 8 inches from each end of the cassette. Measure the overall length of the cassette to determine the min and max horizontal spacing of the mounts. Mark the location of the brackets over a stud or ceiling joist and within an appropriate distance from the ends. If the location of the stud or ceiling joist does not allow the center of the screen to match the projector lens' center, another board or plate will have to be installed on the wall or ceiling to take the mount fasteners.

Installation

(contd. on next page)

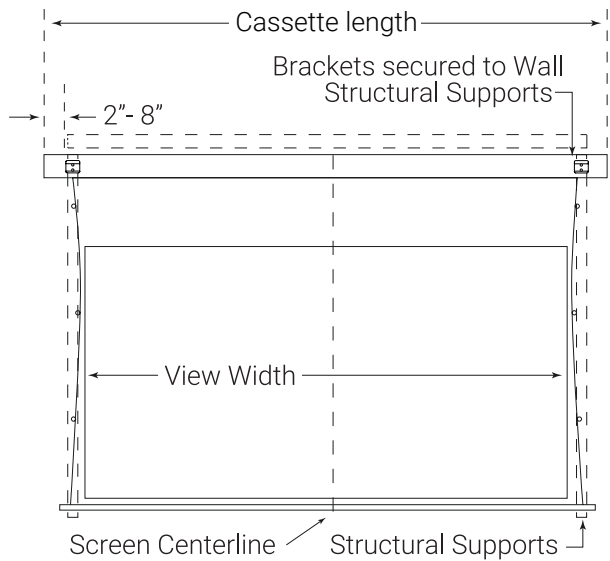

Installation

6

- Secure the brackets to the wall structural supports using appropriate fasteners. Make sure the brackets are along the same level line and are plumb.

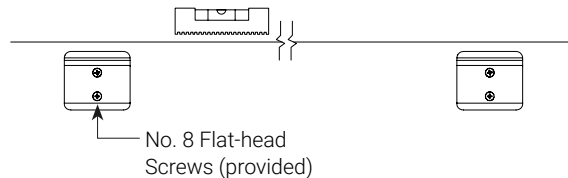

Installation

(contd. on next page)

7

5. Lift the cassette up onto the brackets and make sure the hooks on both brackets engage with the cassette. Then slide left to right to center of cassette about desired viewing centerline.

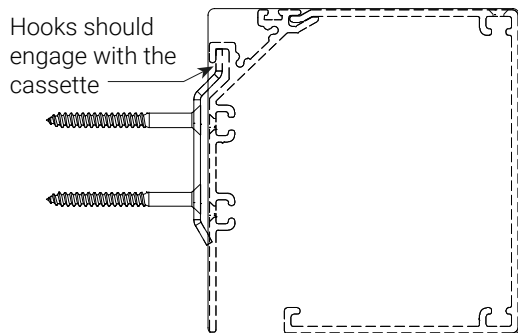

## WARRANTY

New SI products carry a standard 1- year warranty on parts and labor.

### FCC INFORMATION

This device complies with Part 15 of the FCC Results. Operation is subject to the following two conditions:

1. This device may not cause harmful interference, and
2. This device must accept any interference received, including that which may cause undesired operation.

NOTE: This equipment has been tested and found to comply with the limits for CLASS B digital device, pursuant to Part 15 of FCC Rules. These limits are designed to provide reasonable protection against harmful interference when the equipment is operated in a commercial environment.

⚠ Changes or modifications not expressly approved by the manufacturer could void the user's authority to operate the equipment.

Solo/Pro 2, the Solo wordmark, and the Screen Innovations logo are registered trademarks and the exclusive property of Screen Innovations.