

# IP(Zigbee) Controlled LED-Lighting

## Installation Instructions



INSTALLERS: PLEASE LEAVE THIS MANUAL WITH THE OWNER.



# IP (ZIGBEE) CONTROLLED LIGHTING SETUP

## CONNECT TO LED STRIP

Controller input voltage must be in accordance with the required voltage of LED strips.

Input voltage = Output Voltage

### Connect to RGB LED strip diagram

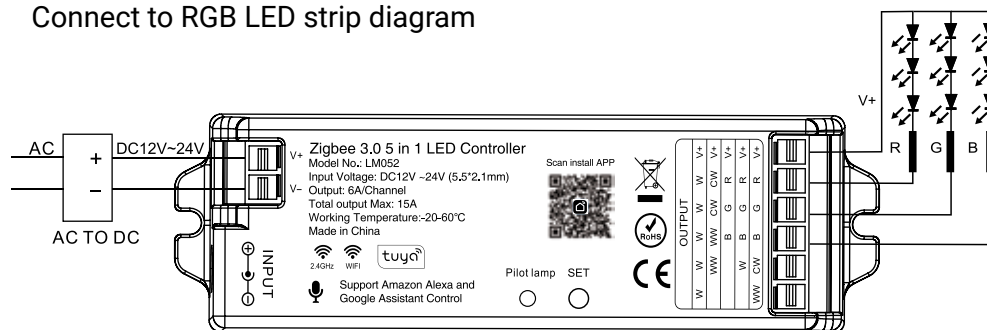

## MOUNTING

Free screw when connecting to LED strip

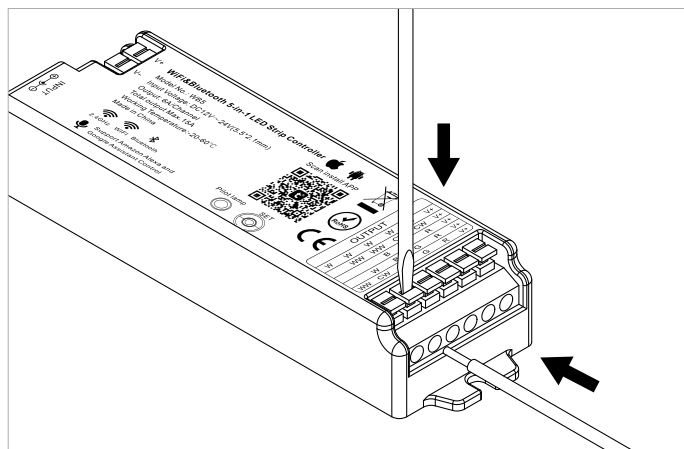

Controller can not  
use in humid area



Made in China

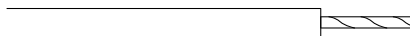

≥0.39 in / 10mm

# IP (ZIGBEE) CONTROLLED LIGHTING SETUP

## INITIAL SETUP

Before attempting to connect your LED IP Controller to Phillips Hue, ensure that the Hue Bridge is powered on and connected to the local Wi-Fi® network.

- 1 Begin by connecting the LED Controller power supply to an electrical outlet.
- 2 Open the HUE application and press the “...” button in the upper right-hand corner, then select the “Add Lights” option.
- 3 Now Press and Hold the “SET” button on the IP Controller until the LED starts to flash a Purple color, it is now in Discovery Mode.
- 4 Back in the HUE application, Use the “Search” button function to discover the device. This function can take several seconds to connect. Once connected, the LEDs will light green.
- 5 The LED IP will appear in the Phillips Hue app as “Extended Color light 1” and “Dimmable light 1”. Only use “Extended Color Light 1” to control the LED’s. “Dimmable Light 1” should be deleted.
- 6 After the LED IP is connected, it can be renamed and used like any Hue lamp.



Scan this QR code to see the video for LED kit troubleshooting.

For more technical support questions - Call: 512.832.6939 or email: [support@screeninnovations.com](mailto:support@screeninnovations.com)

Hours of Support: 7:30am – 5pm CST | [screeninnovations.com](http://screeninnovations.com)



**Screen Innovations**

9715-B Burnet Rd, Suite 400 Austin, TX 78758

512.832.6939

[www.screeninnovations.com](http://www.screeninnovations.com)