

DECOSET KEYPAD

Installation Instructions

201576



Please use these QR Codes to access the updated installation instructions and video tutorials.



Decoset

Thank you for purchasing an SI product. If you have any questions or need any assistance with your Decoset, we would love to help you.

Technical Support: 512.832.6939

Hours of Support: 7:30am - 5pm CST

screeninnovations.com

support@screeninnovations.com

CONTENTS

PARTS IN THE BOX	4
INITIAL CONSIDERATIONS	5
SETUP STEPS	5
WIRING TOPOLOGY - AC 485 SCREENS	6
CONNECTING TO AC 485 SCREENS	7
WIRING TOPOLOGY - LV 485 MOTORS	9
CONNECTING TO LV 485 MOTORS	10
DECOSET MOVEMENT COMMANDS (WHITE BUTTONS & LED)	11
DECOSET SETTING COMMANDS(BLACK BUTTONS)	12
DECOSET CONFIGURATION FOR END USER CONTROL	15
TROUBLESHOOTING	18
USING ON FACTORY RESET MOTORS	20
ADJUSTING THE MOVEMENT BUTTONS	21

PARTS IN THE BOX



8 button keypad
- base



8 button
Decora insert



5 button
Decora insert



White trim
wall plate



(2) Trim plate screws



(2) Insert screws



(1) Cate 5e cable

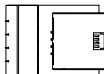

(1) Spike

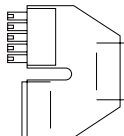

(1) Duocoup

INITIAL CONSIDERATIONS

The Decoset is a pre-programmed control keypad/limit setting tool. And is designed to allow you to set the limits and adjust the rotation on your 485 screen/shade without the use of a PC or any other hardware.

Once you complete your setup, then the keypad can be used to control the 485 screen/shade and installed in a wall.

SETUP STEPS

Review the following pages (6 - 8) to determine if your screen/shade is an AC or Low-Voltage powered.

If you already know that you have a Low-Voltage screen then skip to page 9.

WIRING TOPOLOGY - AC 485 SCREENS

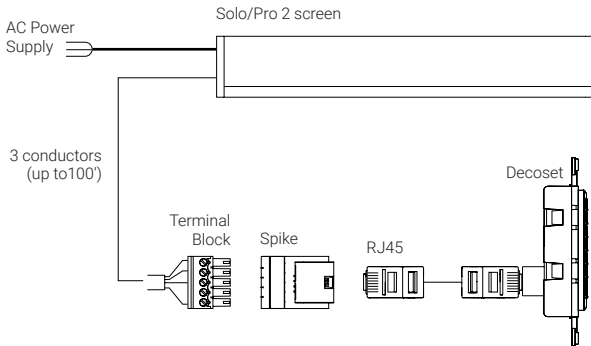

CONNECTING TO AC 485 SCREENS

1. Connect the Terminal Block to a Spike
2. You can now connect your Decoset to the RJ45 of the Spike.

Note: If you need to extend the length of cable to your Decoset, you can use standard Cat5e up to 100 ft.

3. Once your Decoset is connected to the screen and the screen has AC power applied, a small red LED will start flashing directly above the RJ45 connector on the back of the Decoset.

Note: If this does not happen, then check the AC power and connections (and see Troubleshooting section on Pgs 18/19).

You're now ready to start configuring your screen/shade.
Skip to Page 15 for next steps.

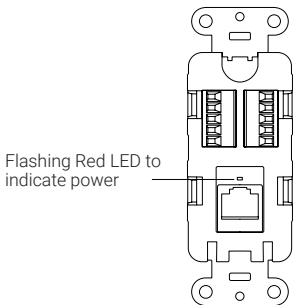

WIRING TOPOLOGY - LV 485 MOTORS

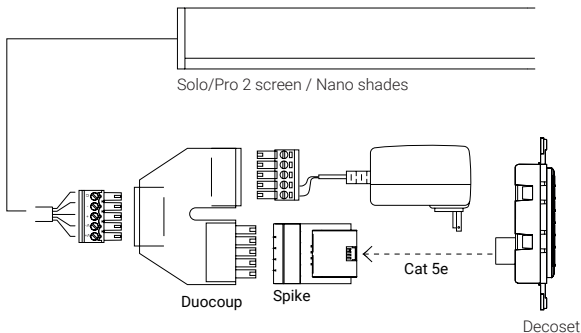

Note: Most all LV motors will come with a cable terminated into a 5 position terminal block.

CONNECTING TO LV 485 MOTORS

1. Once connected to your power supply for an AC power motor, a small red LED will start flashing directly above the RJ45 connector on the back of the Decoset.

Note: If no LED activity, then check the low-voltage power supply and all connections (and see Troubleshooting section on Pgs 18/19).

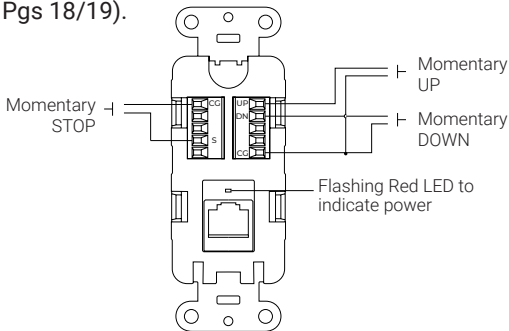

Decoset has optional Dry Contact closure inputs on rear of keypad for UP, Down, and Stop.

DECOSET MOVEMENT COMMANDS (WHITE BUTTONS & LED)

The command status LED will flash once per movement (button press) or in other words for each command sent to motor.

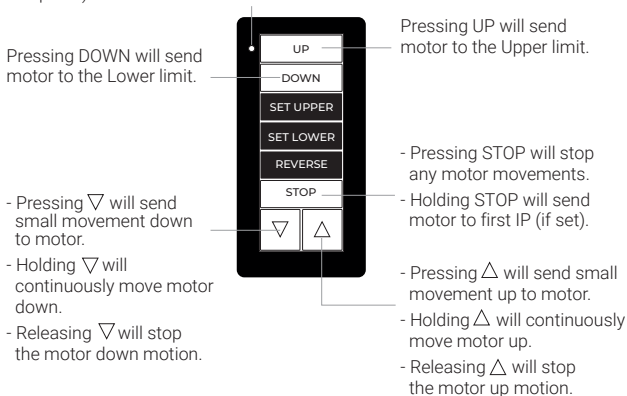

DECOSET SETTING COMMANDS (BLACK BUTTONS)

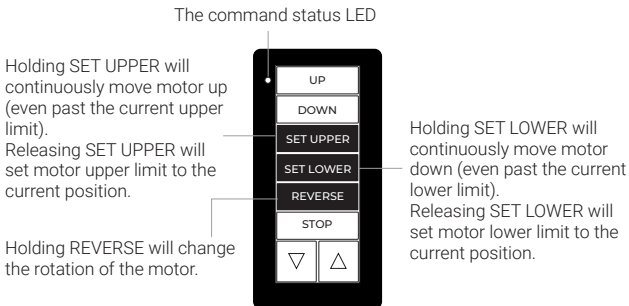

3. Make screen/shade adjustments

Screen/shades have upper and lower limits set at the factory. The typical screen installation should not require the upper limit being modified, however the lower limit is often modified, using 1 of the following 2 methods:

a. Adjusting lower limit to a new higher position

- Press the DOWN button on the Decoset to move the screen to the current lower limit.
- Press and hold Δ until you reach the desired position.
- Optionally, pressing or holding either of the Δ or ∇ will move the screen accordingly.
- Finally, hold the SET LOWER button until you see the status LED flash twice. Now, release to save the current position as the new lower limit.

b. Adjusting lower limit to a new lower position

- Press the DOWN button on the Decoset to move the screen to the current lower limit.
- Press and hold the SET LOWER button until you achieve the desired position and when you release the button, the lower limit is now set to the current position.

4. Change motor rotation if needed

Screen/shades have the correct motor rotations set at the factory. The typical screen installation should not require the motor rotation being modified. If directed by SI support the following method, will allow you to change the rotation.

- Hold the REVERSE button on the Decoset until you see the Command LED flash once. Then release the button.
- Repeat the above step 2 more times.

After the 3rd time, the rotation of the motor has now been reversed.

DECOSET CONFIGURATION FOR END USER CONTROL

When all limit settings have been completed you can mechanically configure the keypad for control only mode.



Settings Mode

Note: Never permanently install the Decoset with 3 setting (Black) buttons in place.

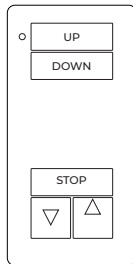

Control Mode

Step 1.



Using a thin flathead screwdriver press in the 4 tabs along the side of the base unit to remove the 8 button Decora insert.

Step 2.



Remove the 3 black settings buttons from base and store in DecoSET box

Step 3.



Place 5 button Decora insert back on base snapping-in all 4 tabs on the sides

Step 4.

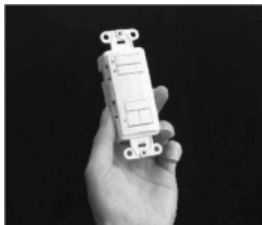

Decoset now ready to be installed in a 1-gang wall box with White trim to finish permanently

TROUBLESHOOTING

Problem	Possible Cause	Action to Take
The LED on the rear of the Decoset is not flashing	No power.	For AC motors, check the line voltage input. For LV motors, check the low-voltage power supply
The motor doesn't respond to the movement (white) buttons	No limits have been set. Connection issue on the Decoset dongle.	Verify limits have been set or set new limits. Verify the connection between the screen/shade and the Decoset dongle.
AC screen doesn't have 4 conductors	Older screen	You will need to purchase a low-voltage power supply #1822209 from SI.

Problem	Possible Cause	Action to Take
Muiltple shades move when pressing the movement buttons.	Decoset is connected to multiple shades.	Ensure each Decoset is only wired to a single shade or a single screen.
Dry Contact not working from Control system.	Not using the correct Pins in the connector.	Refer to pg. 12 and ensure the wiring is correct as per the drawing.
The motor doesn't respond to the Setting (black) buttons.	Decoset has been sent a new configiration from the USB programming kit or TRO.Y.	Re-order a new Decoset. Once, a configuration has been sent to a Decoset it can no longer perform the setting commands.

USING ON FACTORY RESET MOTORS

SET UPPER

SET LOWER

REVERSE

Decoset keypad can be used with a motor that has been factory reset to set the initial limits and rotation. By using the Set Upper button, to move the motor up and the Set Lower button to move the motor down, you can create the initial limits. Refer to page 12 for more details.

ADJUSTING THE MOVEMENT BUTTONS



Decoset keypad buttons 7 (Down arrow), 8(Up arrow) can be adjusted by using the USB programming kit or TRO.Y. These buttons are default to 20 pulses and can be modified to suit your application. Refer to USB Programming kit or TRO.Y manuals for more details on how to change.

Note: When making adjustments of buttons 7 and 8, do not change any settings on buttons 3 - 5, as this will permanently remove the ability to set the limits on this keypad.

NOTES



Screen Innovations
9715-B Burnet Rd, Suite 400 Austin, TX 78758
512.832.6939
www.screeninnovations.com